

**Pulegge dentate per cinghie passo metrico**  
**Timing belt pulleys metric pitch**  
**Zahnriemenscheiben metrische teilung**  
**Poulies dentées pour courroies pas métrique**  
**Poleas dentadas para correas con paso metrico**

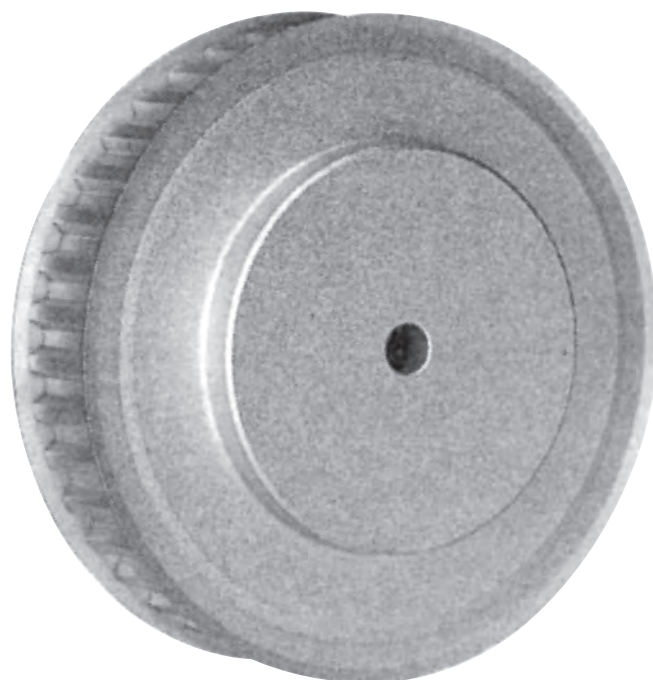

# Istruzioni per l'identificazione e la classificazione delle pulegge a passo metrico

## Instructions for the identification and classification of timing belt pulleys metric pitch

### Leitfaden zur suche und Klassifizierung der Zahnriemenscheiben metrische Teilung

#### Instructions pour la recherche et la classification des poulies dentées pas métrique

##### Guia a la busca y clasificación de las poleas dentadas en paso metrico

**Esempio:**  
ALTEZZA 40 T 10/32-2

**40** = Larghezza totale della puleggia 40 mm (L)  
**T10** = Passo 10 mm  
**30** = N. denti  
**2** = N. della flangia

**Example:**  
PULLEY 40 T 10/32-2

**40** = Total width of pulley 40 mm (L)  
**T10** = Pitch 10 mm  
**30** = No. of teeth  
**2** = No. of flanges

**Beispiel:**  
SCHIBE 40 T 10/32-2

**40** = Gesamtbreite der Scheibe 40 mm (L)  
**T10** = Teilung 10 mm  
**30** = Zähnezahl  
**2** = Anzahl der Bordscheiben

**Exemple:**  
POULIE 40 T 10/32-2

**40** = Largeur totale de la poulie 40 mm (L)  
**T10** = Pas 10 mm  
**30** = N. de dents  
**2** = N. de flasques

**Ejemplo:**  
POLEA 40 T 10/32-2

**40** = Ancho total de la polea 40 mm (L)  
**T10** = Paso 10 mm  
**30** = Cantidad de dientes  
**2** = Cantidad de tapetas

**Materiale:**  
alluminio 6082 T6  
UNI 9006/4 adatto al trattamento anodico

**Material:**  
aluminium 6082 T6 UNI 9006/4 suitable for anodic treatment

**Werkstoff:**  
aluminium 6082 T6 UNI 9006/4 geeignet für anodischen oxydation

**Matière:**  
aluminium 6082 T6 UNI 9006/4 apte au traitement anodique

**Material:**  
aluminio 6082 T6 UNI 9006/4 apto para la oxidacion anodica

## Pulegge dentate per cinghie passo metrico / Timing belt pulleys metric pitch

### Zahnriemenscheiben metrische Teilung / Poulies dentées pour courroies pas métrique

#### Poleas dentadas para correas con paso metrico

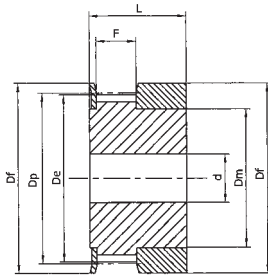

**Tipo / Type**  
**1F**

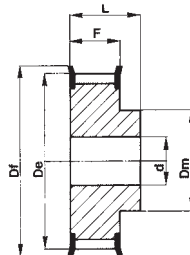

**Tipo / Type**  
**6F**

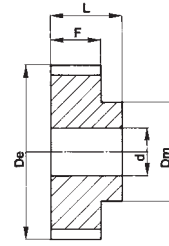

**Tipo / Type**  
**6**

## T 2,5

(Paso 2,5 mm)  
per cinghia larghezza 6 mm

(Pitch 2,5 mm)  
for belt width 6 mm

(Teilung 2,5 mm)  
für Riemenbreite 6 mm

(Pas 2,5 mm)  
pour courroies largeur 6 mm

(Paso 2,5 mm)  
para correas ancho 6 mm

Code symbol / Fabriknummer Code symbole / Numero de fabrica	Nostro codice Our code / Unser kode Notre code / Nuestro codigo	Tipo Type / Typ Type / Tipo	Tipo flangia Flanges type / Bordscheiben Typ Type flasques / Tipo tapetas	N. denti N. of teeth / Zähnezahl N. bre de dents / Cantidad de dientes	Dp	De	Df	Dm	F	L	d	Peso / Weight Gewicht / Poids / Peso Kg
16T2,5/12-2	16T2012	1F	F01	12	9,60	9,00	13,0	6,0	9	16	4	0,004
16T2,5/14-2	16T2014	1F	F02	14	11,20	10,60	15,0	8,0	9	16	4	0,006
16T2,5/15-2	16T2015	1F	F02	15	12,00	11,40	15,0	8,0	9	16	4	0,006
16T2,5/16-2	16T2016	1F	F03	16	12,80	12,20	16,0	9,5	9	16	4	0,006
16T2,5/18-2	16T2018	6F	F04	18	14,40	13,80	17,5	10,0	10	16	4	0,006
16T2,5/19-2	16T2019	6F	F05	19	15,20	14,60	18,0	10,0	10	16	4	0,007
16T2,5/20-2	16T2020	6F	F06	20	16,00	15,40	20,0	10,5	10	16	4	0,008
16T2,5/22-2	16T2022	6F	F07	22	17,60	17,00	23,0	11,0	10	16	4	0,010
16T2,5/24-2	16T2024	6F	F07	24	19,15	18,55	23,0	12,0	10	16	4	0,012
16T2,5/25-2	16T2025	6F	F07	25	19,95	19,35	23,0	13,0	10	16	4	0,013
16T2,5/26-2	16T2026	6F	F09	26	20,75	20,15	25,0	14,0	10	16	4	0,015
16T2,5/28-2	16T2028	6F	F09	28	22,35	21,75	25,0	14,0	10	16	4	0,016
16T2,5/30-2	16T2030	6F	F09	30	23,95	23,35	28,0	16,0	10	16	6	0,018
16T2,5/32-2	16T2032	6F	F10	32	25,95	24,95	32,0	16,0	10	16	6	0,020
16T2,5/36-2	16T2036	6F	F12	36	28,75	28,10	36,0	20,0	10	16	6	0,026
16T2,5/40-2	16T2040	6F	F14	40	31,90	31,30	38,0	22,0	10	16	6	0,032
16T2,5/44-2	16T2044	6F	F15	44	35,10	34,50	42,0	24,0	10	16	6	0,038
16T2,5/48-0	16T2048	6	-	48	38,30	37,70	-	26,0	10	16	6	0,048
16T2,5/60-0	16T2060	6	-	60	47,85	47,25	-	34,0	10	16	8	0,073

Per pulegge aventi un numero di denti diverso dalla tabella, consultateci.

For pulleys with a number of teeth not included in these tables please ask for our quotation.

Verlagen sie angebot für Zahnriemenscheiben mit Anzahl von Zähnen die nicht in diesen Tafeln aufgefuehrt sind.

Pour les poulies avec un nombre de dents different du tableau, nous consulter.

Pidan oferta por lo que concierne una cantidad de dientes no incluida en estas tablas.

**Pulegge dentate per cinghie passo metrico / Timing belt pulleys metric pitch**  
**Zahnriemenscheiben metrische Teilung / Poulies dentées pour courroies pas métrique**  
**Poleas dentadas para correas con paso metrico**



**Materiale:** alluminio 6082 T6 UNI 9006/4 adatto al trattamento anodico  
**Material:** aluminium 6082 T6 UNI 9006/4 suitable for anodic treatment  
**Werkstoff:** aluminium 6082 T6 UNI 9006/4 geeignet für anodischen oxydation  
**Matière:** aluminium 6082 T6 UNI 9006/4 apte au traitement anodique  
**Material:** aluminio 6082 T6 UNI 9006/4 apto para la oxidacion anodica

**Tipo / Type**  
**6F**

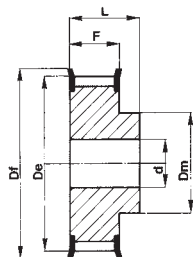

**Tipo / Type**  
**6**

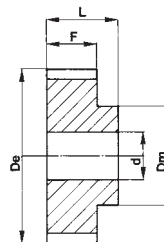

**T 5**

(Passo 5 mm) per cinghia larghezza 10 mm (Pitch 5 mm) for belt width 10 mm (Teilung 5 mm) für Riemenbreite 10 mm (Pas 5 mm) pour courroies largeur 10 mm (Paso 5 mm) para correas ancho 10 mm

Code symbol / Fabriknummer / Code symbole / Numero de fabrica	Nostro codice / Our code / Unser kode / Notre code / Nuestro codigo	Tipo / Type / Typ / Tipo	Tipo flangia / Flanges type / Bordscheiben Typ / Type flasques / Tipo tapetas	N. denti / N. of teeth / Zahnezahl / N. bre de dents / Cantidad de dientes	Dp	De	Df	Dm	F	L	d	Peso / Weight / Gewicht / Poids / Peso / Kg
21T5/10-2	21T5010	6F	F06	10	16,05	15,05	20,0	8	15	21	4	0,012
21T5/12-2	21T5012	6F	F07	12	19,25	18,25	23,0	11	15	21	4	0,016
21T5/14-2	21T5014	6F	F08	14	22,45	21,45	25,0	13	15	21	4	0,019
21T5/15-2	21T5015	6F	F09	15	24,05	23,05	28,0	16	15	21	6	0,021
21T5/16-2	21T5016	6F	F10	16	25,06	24,60	32,0	18	15	21	6	0,025
21T5/18-2	21T5018	6F	F10	18	28,80	27,80	32,0	20	15	21	6	0,031
21T5/19-2	21T5019	6F	F12	19	30,40	29,40	36,0	22	15	21	6	0,036
21T5/20-2	21T5020	6F	F12	20	32,00	31,00	36,0	23	15	21	6	0,038
21T5/22-2	21T5022	6F	F14	22	35,15	34,15	38,0	24	15	21	6	0,054
21T5/24-2	21T5024	6F	F15	24	38,40	37,40	42,0	26	15	21	6	0,056
21T5/25-2	21T5025	6F	F17	25	39,95	38,95	44,0	26	15	21	6	0,058
21T5/26-2	21T5026	6F	F17	26	41,60	40,60	44,0	26	15	21	6	0,064
21T5/27-2	21T5027	6F	F18	27	43,20	42,20	48,0	30	15	21	8	0,070
21T5/28-2	21T5028	6F	F18	28	44,75	43,75	48,0	32	15	21	8	0,075
21T5/30-2	21T5030	6F	F19	30	47,95	46,95	51,0	34	15	21	8	0,081
21T5/32-2	21T5032	6F	F20	32	51,10	50,10	54,0	38	15	21	8	0,088
21T5/36-2	21T5036	6F	F24	36	57,45	56,45	64,0	38	15	21	8	0,114
21T5/40-2	21T5040	6F	F25	40	63,85	62,85	66,0	40	15	21	8	0,138
21T5/42-2	21T5042	6F	F26	42	67,00	66,00	70,0	40	15	21	8	0,165
21T5/44-0	21T5044	6	-	44	70,20	69,20	-	45	15	21	8	0,200
21T5/48-0	21T5048	6	-	48	76,55	75,55	-	50	15	21	8	0,307
21T5/60-0	21T5060	6	-	60	95,65	94,65	-	65	15	21	8	0,180

(Passo 5 mm) per cinghia larghezza 16 mm (Pitch 5 mm) for belt width 16 mm (Teilung 5 mm) für Riemenbreite 16 mm (Pas 5 mm) pour courroies largeur 16 mm (Paso 5 mm) para correas ancho 16 mm

Code symbol / Fabriknummer / Code symbole / Numero de fabrica	Nostro codice / Our code / Unser kode / Notre code / Nuestro codigo	Tipo / Type / Typ / Tipo	Tipo flangia / Flanges type / Bordscheiben Typ / Type flasques / Tipo tapetas	N. denti / N. of teeth / Zahnezahl / N. bre de dents / Cantidad de dientes	Dp	De	Df	Dm	F	L	d	Peso / Weight / Gewicht / Poids / Peso / Kg
27T5/10-2	27T5010	6F	F06	10	16,05	15,05	20,0	8	21	27	4	0,016
27T5/12-2	27T5012	6F	F07	12	19,25	18,25	23,0	11	21	27	4	0,022
27T5/14-2	27T5014	6F	F08	14	22,45	21,45	25,0	13	21	27	4	0,026
27T5/15-2	27T5015	6F	F09	15	24,05	23,05	28,0	16	21	27	6	0,029
27T5/16-2	27T5016	6F	F10	16	25,06	24,60	32,0	18	21	27	6	0,035
27T5/18-2	27T5018	6F	F10	18	28,80	27,80	32,0	20	21	27	6	0,043
27T5/19-2	27T5019	6F	F12	19	30,40	29,40	36,0	22	21	27	6	0,049
27T5/20-2	27T5020	6F	F12	20	32,00	31,00	36,0	23	21	27	6	0,053
27T5/22-2	27T5022	6F	F14	22	35,15	34,15	38,0	24	21	27	6	0,062
27T5/24-2	27T5024	6F	F15	24	38,40	37,40	42,0	26	21	27	6	0,076
27T5/25-2	27T5025	6F	F17	25	39,95	38,95	44,0	26	21	27	6	0,081
27T5/26-2	27T5026	6F	F17	26	41,60	40,60	44,0	26	21	27	6	0,085
27T5/27-2	27T5027	6F	F18	27	43,20	42,20	48,0	30	21	27	8	0,090
27T5/28-2	27T5028	6F	F18	28	44,75	43,75	48,0	32	21	27	8	0,095
27T5/30-2	27T5030	6F	F19	30	47,95	46,95	51,0	34	21	27	8	0,105
27T5/32-2	27T5032	6F	F20	32	51,10	50,10	54,0	38	21	27	8	0,123
27T5/36-2	27T5036	6F	F24	36	57,45	56,45	64,0	38	21	27	8	0,160
27T5/40-2	27T5040	6F	F25	40	63,85	62,85	66,0	40	21	27	8	0,193
27T5/42-2	27T5042	6F	F26	42	67,00	66,00	70,0	40	21	27	8	0,245
27T5/44-0	27T5044	6	-	44	70,20	69,20	-	45	21	27	8	0,280
27T5/48-0	27T5048	6	-	48	76,55	75,55	-	50	21	27	8	0,430
27T5/60-0	27T5060	6	-	60	95,65	94,65	-	65	21	27	8	0,108

(Passo 5 mm) per cinghia larghezza 25 mm (Pitch 5 mm) for belt width 25 mm (Teilung 5 mm) für Riemenbreite 25 mm (Pas 5 mm) pour courroies largeur 25 mm (Paso 5 mm) para correas ancho 25 mm

Code symbol / Fabriknummer / Code symbole / Numero de fabrica	Nostro codice / Our code / Unser kode / Notre code / Nuestro codigo	Tipo / Type / Typ / Tipo	Tipo flangia / Flanges type / Bordscheiben Typ / Type flasques / Tipo tapetas	N. denti / N. of teeth / Zahnezahl / N. bre de dents / Cantidad de dientes	Dp	De	Df	Dm	F	L	d	Peso / Weight / Gewicht / Poids / Peso / Kg
36T5/10-2	36T5010	6F	F06	10	16,05	15,05	20,0	8	30	36	4	0,023
36T5/12-2	36T5012	6F	F07	12	19,25	18,25	23,0	11	30	36	4	0,031
36T5/14-2	36T5014	6F	F08	14	22,45	21,45	25,0	13	30	36	4	0,037
36T5/15-2	36T5015	6F	F09	15	24,05	23,05	28,0	16	30	36	6	0,041
36T5/16-2	36T5016	6F	F10	16	25,06	24,60	32,0	18	30	36	6	0,050
36T5/18-2	36T5018	6F	F10	18	28,80	27,80	32,0	20	30	36	6	0,061
36T5/19-2	36T5019	6F	F12	19	30,40	29,40	36,0	22	30	36	6	0,070
36T5/20-2	36T5020	6F	F12	20	32,00	31,00	36,0	23	30	36	6	0,076
36T5/22-2	36T5022	6F	F14	22	35,15	34,15	38,0	24	30	36	6	0,092
36T5/24-2	36T5024	6F	F15	24	38,40	37,40	42,0	26	30	36	8	0,109
36T5/25-2	36T5025	6F	F17	25	39,95	38,95	44,0	26	30	36	8	0,116
36T5/26-2	36T5026	6F	F17	26	41,60	40,60	44,0	26	30	36	8	0,121
36T5/27-2	36T5027	6F	F18	27	43,20	42,20	48,0	30	30	36	8	0,128
36T5/28-2	36T5028	6F	F18	28	44,75	43,75	48,0	32	30	36	8	0,142
36T5/30-2	36T5030	6F	F19	30	47,95	46,95	51,0	34	30	36	8	0,150
36T5/32-2	36T5032	6F	F20	32	51,10	50,10	54,0	38	30	36	8	0,176
36T5/36-2	36T5036	6F	F24	36	57,45	56,45	64,0	38	30	36	8	0,230
36T5/40-2	36T5040	6F	F25	40	63,85	62,85	66,0	40	30	36	8	0,276
36T5/42-2	36T5042	6F	F26	42	67,00	66,00	70,0	40	30	36	8	0,352
36T5/44-0	36T5044	6	-	44	70,20	69,20	-	45	30	36	8	0,400
36T5/48-0	36T5048	6	-	48	76,55	75,55	-	50	30	36	8	0,614
36T5/60-0	36T5060	6	-	60	95,65	94,65	-	65	30	36	8	0,180

# Pulegge dentate per cinghie passo metrico / Timing belt pulleys metric pitch Zahnriemenscheiben metrische Teilung / Poulies dentées pour courroies pas métrique Poleas dentadas para correas con paso metrico

**Materiale:**  
alluminio 6082 T6 UNI  
9006/4 adatto al trattamento  
anodico

**Material:**  
aluminium 6082 T6 UNI  
9006/4 suitable for anodic  
treatment

**Werkstoff:**  
aluminium 6082 T6 UNI  
9006/4 geeignet für  
anodischen oxydation

**Matière:**  
aluminium 6082 T6 UNI  
9006/4 apte au traitement  
anodique

**Material:**  
aluminio 6082 T6 UNI  
9006/4 apto para la  
oxidacion anodica

**Tipo / Type**  
**6F**

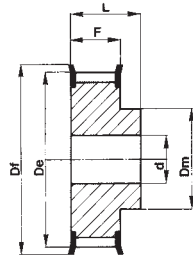

**Tipo / Type**  
**6**

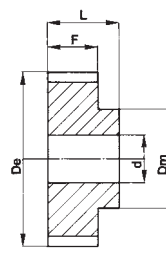

## T 10

(Passo 10 mm)  
per cinghia larghezza 16 mm

(Pitch 10 mm)  
for belt width 16 mm

(Teilung 10 mm)  
für Riemenbreite 16 mm

(Pas 10 mm)  
pour courroies largeur 16 mm

(Paso 10 mm)  
para correas ancho 16 mm

Codice Code symbol / Fabriknummer Code symbole / Numero de fabrica	Nostro codice Our code / Unser kode Notre code / Nuestro codigo	Tipo Type / Typ Type / Tipo	Tipo flangia Flanges type / Bordscheiben Typ Type flasques / Tipo tapetas	N. denti N. of teeth / Zahnzahl N. bre de dents / Cantidad de dientes	Dp	De	Df	Dm	F	L	d	Peso / Weight Gewicht / Poids / Peso Kg
31T10/12-2	31T1012	6F	F15	12	38,35	36,35	42	28	21	31	6	0,076
31T10/14-2	31T1014	6F	F18	14	44,70	42,70	48	32	21	31	8	0,104
31T10/15-2	31T1015	6F	F19	15	47,90	45,90	51	32	21	31	8	0,116
31T10/16-2	31T1016	6F	F20	16	51,10	49,10	54	35	21	31	8	0,134
31T10/18-2	31T1018	6F	F22	18	57,45	55,45	60	40	21	31	8	0,167
31T10/19-2	31T1019	6F	F25	19	60,65	58,65	66	44	21	31	8	0,184
31T10/20-2	31T1020	6F	F25	20	63,80	61,80	66	46	21	31	8	0,208
31T10/22-2	31T1022	6F	F27	22	70,20	68,20	75	52	21	31	8	0,240
31T10/24-2	31T1024	6F	F29	24	76,55	74,55	83	58	21	31	8	0,288
31T10/25-2	31T1025	6F	F29	25	79,75	77,70	83	60	21	31	8	0,295
31T10/26-2	31T1026	6F	F30	26	82,90	80,90	87	60	21	31	8	0,310
31T10/27-2	31T1027	6F	F31	27	86,10	84,10	91	60	21	31	8	0,364
31T10/28-2	31T1028	6F	F32	28	89,25	87,25	93	60	21	31	8	0,441
31T10/30-2	31T1030	6F	F33	30	95,65	93,65	97	60	21	31	8	0,493
31T10/32-2	31T1032	6F	F35	32	102,00	100,00	106	65	21	31	10	0,623
31T10/36-2	31T1036	6F	F38	36	114,75	112,75	120	70	21	31	10	0,767
31T10/40-2	31T1040	6F	F41	40	127,45	125,45	131	80	21	31	10	0,950
31T10/44-0	31T1044	6	-	44	140,20	138,20	-	88	21	31	10	1,090
31T10/48-0	31T1048	6	-	48	152,95	150,95	-	95	21	31	16	1,704
31T10/60-0	31T1060	6	-	60	191,15	189,10	-	110	21	31	16	1,704

(Passo 10 mm)  
per cinghia larghezza 25 mm

(Pitch 10 mm)  
for belt width 25 mm

(Teilung 10 mm)  
für Riemenbreite 25 mm

(Pas 10 mm)  
pour courroies largeur 25 mm

(Paso 10 mm)  
para correas ancho 25 mm

40T10/12-2	40T1012	6F	F15	12	38,35	36,35	42	28	30	40	6	0,099
40T10/14-2	40T1014	6F	F18	14	44,70	42,70	48	32	30	40	8	0,134
40T10/15-2	40T1015	6F	F19	15	47,90	45,90	51	32	30	40	8	0,152
40T10/16-2	40T1016	6F	F20	16	51,10	49,10	54	35	30	40	8	0,176
40T10/18-2	40T1018	6F	F22	18	57,45	55,45	60	40	30	40	8	0,224
40T10/19-2	40T1019	6F	F25	19	60,65	58,65	66	44	30	40	8	0,247
40T10/20-2	40T1020	6F	F25	20	63,80	61,80	66	46	30	40	8	0,276
40T10/22-2	40T1022	6F	F27	22	70,20	68,20	75	52	30	40	8	0,310
40T10/24-2	40T1024	6F	F29	24	76,55	74,55	83	58	30	40	8	0,392
40T10/25-2	40T1025	6F	F29	25	79,75	77,70	83	60	30	40	8	0,422
40T10/26-2	40T1026	6F	F30	26	82,90	80,90	87	60	30	40	8	0,480
40T10/27-2	40T1027	6F	F31	27	86,10	84,10	91	60	30	40	8	0,536
40T10/28-2	40T1028	6F	F32	28	89,25	87,25	93	60	30	40	8	0,590
40T10/30-2	40T1030	6F	F33	30	95,65	93,65	97	60	30	40	8	0,640
40T10/32-2	40T1032	6F	F35	32	102,00	100,00	106	65	30	40	10	0,693
40T10/36-2	40T1036	6F	F38	36	114,75	112,75	120	70	30	40	10	0,873
40T10/40-2	40T1040	6F	F41	40	127,45	125,45	131	80	30	40	10	1,067
40T10/44-0	40T1044	6	-	44	140,20	138,20	-	88	30	40	10	1,310
40T10/48-0	40T1048	6	-	48	152,95	150,95	-	95	30	40	16	1,516
40T10/60-0	40T1060	6	-	60	191,15	189,10	-	110	30	40	16	2,339

**Pulegge dentate per cinghie passo metrico / Timing belt pulleys metric pitch**  
**Zahnriemenscheiben metrische Teilung / Poulies dentées pour courroies pas métrique**  
**Poleas dentadas para correas con paso metrico**



**Materiale:**  
**alluminio 6082 T6 UNI**  
**9006/4 adatto al trattamento**  
**anodico**

**Material:**  
**aluminium 6082 T6 UNI**  
**9006/4 suitable for anodic**  
**treatment**

**Werkstoff:**  
**aluminium 6082 T6 UNI**  
**9006/4 geeignet für**  
**anodischen oxydation**

**Matière:**  
**aluminium 6082 T6 UNI**  
**9006/4 apte au traitement**  
**anodique**

**Material:**  
**aluminio 6082 T6 UNI**  
**9006/4 apto para la**  
**oxidacion anodica**

**Tipo / Type**  
**6F**

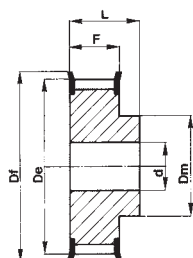

**Tipo / Type**  
**6**

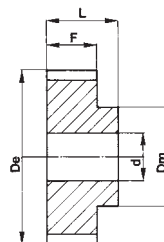

**T 10**

(Passo 10 mm)  
 per cinghia larghezza 32 mm

(Pitch 10 mm)  
 for belt width 32 mm

(Teilung 10 mm)  
 für Riemenbreite 32 mm

(Pas 10 mm)  
 pour courroies largeur 32 mm

(Paso 10 mm)  
 para correas ancho 32 mm

Codice Code symbol / Fabriknummer Code symbole / Numero de fabrica	Nostro codice Our code / Unser kode Notre code / Nuestro codigo	Tipo Type / Typ Type / Tipo	Tipo flangia Flanges type / Bordscheiben Typ Type flasques / Tipo tapetas	N. denti N. of teeth / Zahnezahl N. bre de dents / Cantidad de dientes	Dp	De	Df	Dm	F	L	d	Peso / Weight Gewicht / Poids / Peso Kg
47T10/18-2	47T1018	6F	F22	18	57,45	55,45	60	40	37	47	10	0,253
47T10/19-2	47T1019	6F	F25	19	60,65	58,65	66	44	37	47	10	0,286
47T10/20-2	47T1020	6F	F25	20	63,80	61,80	66	46	37	47	12	0,322
47T10/22-2	47T1022	6F	F27	22	70,20	68,20	75	52	37	47	12	0,393
47T10/24-2	47T1024	6F	F29	24	76,55	74,55	83	58	37	47	12	0,475
47T10/25-2	47T1025	6F	F29	25	79,75	77,70	83	60	37	47	12	0,527
47T10/26-2	47T1026	6F	F30	26	82,90	80,90	87	60	37	47	12	0,564
47T10/27-2	47T1027	6F	F31	27	86,10	84,10	91	60	37	47	12	0,602
47T10/28-2	47T1028	6F	F32	28	89,25	87,25	93	60	37	47	12	0,642
47T10/30-2	47T1030	6F	F33	30	95,65	93,65	97	60	37	47	12	0,740
47T10/32-2	47T1032	6F	F35	32	102,00	100,00	106	65	37	47	12	0,844
47T10/36-2	47T1036	6F	F38	36	114,75	112,75	120	70	37	47	16	1,063
47T10/40-2	47T1040	6F	F41	40	127,45	125,45	131	80	37	47	16	1,371
47T10/44-0	47T1044	6	-	44	140,20	138,20	-	88	37	47	16	1,611
47T10/48-0	47T1048	6	-	48	152,95	150,95	-	95	37	47	16	1,913
47T10/60-0	47T1060	6	-	60	191,10	189,10	-	110	37	47	16	3,004

(Passo 10 mm)  
 per cinghia larghezza 50 mm

(Pitch 10 mm)  
 for belt width 50 mm

(Teilung 10 mm)  
 für Riemenbreite 50 mm

(Pas 10 mm)  
 pour courroies largeur 50 mm

(Paso 10 mm)  
 para correas ancho 50 mm

66T10/18-2	66T1018	6F	F22	18	57,45	55,45	60	40	56	66	10	0,422
66T10/19-2	66T1019	6F	F25	19	60,65	58,65	66	44	56	66	10	0,466
66T10/20-2	66T1020	6F	F25	20	63,80	61,80	66	46	56	66	12	0,520
66T10/22-2	66T1022	6F	F27	22	70,20	68,20	75	52	56	66	12	0,640
66T10/24-2	66T1024	6F	F29	24	76,55	74,55	83	58	56	66	12	0,736
66T10/25-2	66T1025	6F	F29	25	79,75	77,70	83	60	56	66	12	0,766
66T10/26-2	66T1026	6F	F30	26	82,90	80,90	87	60	56	66	12	0,845
66T10/27-2	66T1027	6F	F31	27	86,10	84,10	91	60	56	66	12	0,946
66T10/28-2	66T1028	6F	F32	28	89,25	87,25	93	60	56	66	12	0,110
66T10/30-2	66T1030	6F	F33	30	95,65	93,65	97	60	56	66	12	1,169
66T10/32-2	66T1032	6F	F35	32	102,00	100,00	106	65	56	66	12	1,300
66T10/36-2	66T1036	6F	F38	36	114,75	112,75	120	70	56	66	16	1,637
66T10/40-2	66T1040	6F	F41	40	127,45	125,45	131	80	56	66	16	1,999
66T10/44-0	66T1044	6	-	44	140,20	138,20	-	88	56	66	16	2,420
66T10/48-0	66T1048	6	-	48	152,95	150,95	-	95	56	66	16	2,830
66T10/60-0	66T1060	6	-	60	191,10	189,10	-	110	56	66	16	4,366

# Pulegge dentate per cinghie passo metrico / Timing belt pulleys metric pitch Zahnriemenscheiben metrische Teilung / Poulies dentées pour courroies pas métrique Poleas dentadas para correas con paso metrico

**Materiale:**  
Ghisa

**Material:**  
Cast iron

**Werkstoff:**  
Grauguss

**Matière:**  
Fonte

**Material:**  
Hierro fundido

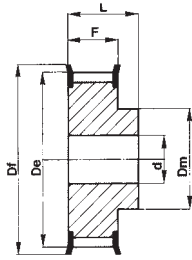

**Tipo / Type**  
**6F**

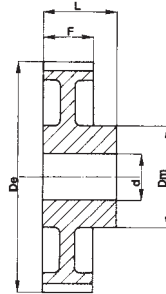

**Tipo / Type**  
**6W**

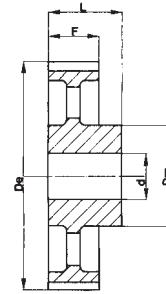

**Tipo / Type**  
**6A**

## T 20

(Passo 20 mm)  
per cinghia larghezza 32 mm

(Pitch 20 mm)  
for belt width 32 mm

(Teilung 20 mm)  
für Riemenbreite 32 mm

(Pas 20 mm)  
pour courroies largeur 32 mm

(Paso 20 mm)  
para correas ancho 32 mm

Codice Code symbol / Fabriknummer Code symbole / Numero de fabrica	Nostro codice Our code / Unser kode Notre code / Nuestro codigo	Tipo Type / Typ Type / Tipo	Tipo flangia Flanges type / Bordscheiben Typ Type flasques / Tipo tapetas	N. denti N. of teeth / Zahnezahl N. bre de dents / Cantidad de dientes	De	Df	Dm	F	L	d	Peso / Weight Gewicht / Poids / Peso Kg
53T20/18-2	53T2018	6F	F38	18	111,75	120	80	38	53	15	
53T20/20-2	53T2020	6F	F43	20	124,50	138	90	38	53	15	
53T20/22-2	53T2022	6F	F46	22	137,20	146	90	38	53	15	
53T20/24-2	53T2024	6F	F50	24	149,95	158	95	38	53	15	
53T20/25-2	53T2025	6F	F52	25	156,30	168	95	38	53	15	
53T20/30-2	53T2030	6F	F59	30	188,15	200	110	38	53	15	
53T20/32-2	53T2032	6W		32	200,85	-	110	38	53	18	
53T20/36-2	53T2036	6W		36	226,35	-	110	38	53	18	
53T20/40-2	53T2040	6A		40	251,80	-	110	38	53	20	
53T20/48-2	53T2048	6A		48	302,70	-	130	38	53	20	
53T20/60-2	53T2060	6A		60	379,10	-	130	38	53	20	
53T20/72-2	53T2072	6A		72	455,50	-	140	38	53	20	

(Passo 20 mm)  
per cinghia larghezza 50 mm

(Pitch 20 mm)  
for belt width 50 mm

(Teilung 20 mm)  
für Riemenbreite 50 mm

(Pas 20 mm)  
pour courroies largeur 50 mm

(Paso 20 mm)  
para correas ancho 50 mm

71T20/18-2	71T2018	6F	F38	18	111,75	120	80	56	71	18	
71T20/20-2	71T2020	6F	F43	20	124,50	138	90	56	71	18	
71T20/22-2	71T2022	6F	F46	22	137,20	146	90	56	71	18	
71T20/24-2	71T2024	6F	F50	24	149,95	158	95	56	71	18	
71T20/25-2	71T2025	6F	F52	25	156,30	168	95	56	71	18	
71T20/30-2	71T2030	6F	F59	30	188,15	200	110	56	71	18	
71T20/32-2	71T2032	6W		32	200,85	-	110	56	71	20	
71T20/36-2	71T2036	6W		36	226,35	-	110	56	71	20	
71T20/40-2	71T2040	6A		40	251,80	-	110	56	71	20	
71T20/48-2	71T2048	6A		48	302,70	-	130	56	71	24	
71T20/60-2	71T2060	6A		60	379,10	-	130	56	71	24	
71T20/72-2	71T2072	6A		72	455,50	-	140	56	71	24	

(Passo 20 mm)  
per cinghia larghezza 100 mm

(Pitch 20 mm)  
for belt width 100 mm

(Teilung 20 mm)  
für Riemenbreite 100 mm

(Pas 20 mm)  
pour courroies largeur 100 mm

(Paso 20 mm)  
para correas ancho 100 mm

123T20/18-2	123T2018	6F	F38	18	111,75	120	80	108	123	24	
123T20/20-2	123T2020	6F	F43	20	124,50	138	90	108	123	24	
123T20/22-2	123T2022	6F	F46	22	137,20	146	90	108	123	24	
123T20/24-2	123T2024	6F	F50	24	149,95	158	95	108	123	24	
123T20/25-2	123T2025	6F	F52	25	156,30	168	95	108	123	24	
123T20/30-2	123T2030	6F	F59	30	188,15	200	110	108	123	24	
123T20/32-2	123T2032	6W		32	200,85	-	110	108	123	32	
123T20/36-2	123T2036	6W		36	226,35	-	110	108	123	32	
123T20/40-2	123T2040	6A		40	251,80	-	110	108	123	32	
123T20/48-2	123T2048	6A		48	302,70	-	130	108	123	32	
123T20/60-2	123T2060	6A		60	379,10	-	130	108	123	32	
123T20/72-2	123T2072	6A		72	455,50	-	140	108	123	32	



# Barre dentate standard / Standard toothed bars

## Standard Zahnriemensstagen / Barreaux dentés standard

### Barras dentadas de serie



**Materiale:**  
alluminio 6082 T6 UNI  
9006/4 adatto al trattamento  
anodico

**Material:**  
aluminium 6082 T6 UNI  
9006/4 suitable for anodic  
treatment

**Werkstoff:**  
aluminium 6082 T6 UNI  
9006/4 geeignet für  
anodischen oxydation

**Matière:**  
aluminium 6082 T6 UNI  
9006/4 apte au traitement  
anodique

**Material:**  
aluminio 6082 T6 UNI  
9006/4 apto para la  
oxidacion anodica

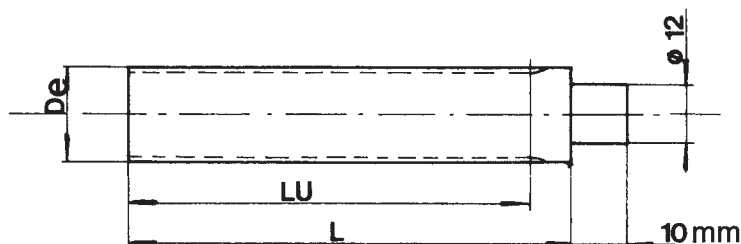

## T 2,5

(Passo 2,5 mm) / (Pitch 2,5 mm) / (Teilung 2,5 mm)  
(Pas 2,5 mm) / (Paso 2,5 mm)

## T 5

(Passo 5 mm) / (Pitch 5 mm) / (Teilung 5 mm)  
(Pas 5 mm) / (Paso 5 mm)

## T 10

(Passo 10 mm) / (Pitch 10 mm) / (Teilung 10 mm)  
(Pas 10 mm) / (Paso 10 mm)

Codice Code symbol Fabriknummer Code symbole Numero de fabrica	Nostro codice Our code Unser kode Notre code Nuestro codigo	N. denti N. of teeth Zahnezahl N. bre de dents Cantidad de dientes	De	Lu	L
T2,5-10	BT25010	10	7,42	50	75
T2,5-12	BT25012	12	9,00	50	75
T2,5-13	BT25013	13	9,80	50	75
T2,5-14	BT25014	14	10,60	50	75
T2,5-15	BT25015	15	11,40	50	75
T2,5-16	BT25016	16	12,20	50	75
T2,5-17	BT25017	17	13,00	50	75
T2,5-18	BT25018	18	13,80	50	75
T2,5-19	BT25019	19	14,60	90	120
T2,5-20	BT25020	20	15,40	90	120
T2,5-21	BT25021	21	16,20	90	120
T2,5-22	BT25022	22	17,00	125	140
T2,5-24	BT25024	24	18,55	125	140
T2,5-26	BT25026	26	20,15	125	140
T2,5-27	BT25027	27	20,95	125	140
T2,5-28	BT25028	28	21,75	125	140
T2,5-29	BT25029	29	22,55	125	140
T2,5-30	BT25030	30	23,35	125	140
T2,5-32	BT25032	32	24,95	125	140
T2,5-34	BT25034	34	26,55	125	140
T2,5-35	BT25035	35	27,35	132	140
T2,5-36	BT25036	36	28,10	132	140
T2,5-38	BT25038	38	29,70	132	140
T2,5-40	BT25040	40	31,30	132	140
T2,5-42	BT25042	42	32,90	140	140
T2,5-44	BT25044	44	34,50	140	140
T2,5-45	BT25045	45	35,30	140	140
T2,5-48	BT25048	48	37,70	140	140
T2,5-50	BT25050	50	39,29	160	160
T2,5-60	BT25060	60	47,25	160	160
T2,5-65	BT25065	65	51,20	160	160
T2,5-70	BT25070	70	55,20	160	160
T2,5-72	BT25072	72	56,80	160	160
T2,5-90	BT25090	90	71,12	160	160
T2,5-100	BT25100	100	79,08	160	160

Codice Code symbol Fabriknummer Code symbole Numero de fabrica	Nostro codice Our code Unser kode Notre code Nuestro codigo	N. denti N. of teeth Zahnezahl N. bre de dents Cantidad de dientes	De	Lu	L
T5-10	BT05010	10	15,05	125	140
T5-11	BT05011	11	16,65	125	140
T5-12	BT05012	12	18,25	125	140
T5-13	BT05013	13	19,85	125	140
T5-14	BT05014	14	21,45	132	140
T5-15	BT05015	15	23,05	132	140
T5-16	BT05016	16	24,60	140	140
T5-17	BT05017	17	26,20	140	140
T5-18	BT05018	18	27,80	140	140
T5-19	BT05019	19	29,40	140	140
T5-20	BT05020	20	31,00	160	160
T5-21	BT05021	21	32,70	160	160
T5-22	BT05022	22	34,15	160	160
T5-23	BT05023	23	35,85	160	160
T5-24	BT05024	24	37,40	160	160
T5-25	BT05025	25	38,95	160	160
T5-26	BT05026	26	40,60	160	160
T5-27	BT05027	27	42,20	160	160
T5-28	BT05028	28	43,75	160	160
T5-29	BT05029	29	45,35	160	160
T5-30	BT05030	30	46,95	160	160
T5-32	BT05032	32	50,10	160	160
T5-34	BT05034	34	53,25	160	160
T5-35	BT05035	35	54,85	160	160
T5-36	BT05036	36	56,45	160	160
T5-37	BT05037	37	58,06	160	160
T5-38	BT05038	38	59,65	160	160
T5-40	BT05040	40	62,85	160	160
T5-42	BT05042	42	66,00	160	160
T5-44	BT05044	44	69,20	160	160
T5-45	BT05045	45	70,80	160	160
T5-46	BT05046	46	72,40	160	160
T5-48	BT05048	48	75,55	160	160
T5-50	BT05050	50	78,75	160	160
T5-60	BT05060	60	94,65	160	160
T5-72	BT05072	72	113,75	160	160
T5-80	BT05080	80	126,48	160	160
T5-90	BT05090	90	142,40	160	160
T5-100	BT05100	100	158,31	160	160

Codice Code symbol Fabriknummer Code symbole Numero de fabrica	Nostro codice Our code Unser kode Notre code Nuestro codigo	N. denti N. of teeth Zahnezahl N. bre de dents Cantidad de dientes	De	Lu	L
T10-10	BT10010	10	29,98	140	140
T10-11	BT10011	11	33,16	140	140
T10-12	BT10012	12	36,35	140	140
T10-13	BT10013	13	39,50	140	140
T10-14	BT10014	14	42,70	160	160
T10-15	BT10015	15	45,90	160	160
T10-16	BT10016	16	49,10	160	160
T10-17	BT10017	17	52,25	160	160
T10-18	BT10018	18	55,45	160	160
T10-19	BT10019	19	58,65	160	160
T10-20	BT10020	20	61,80	160	160
T10-21	BT10021	21	65,00	160	160
T10-22	BT10022	22	68,20	160	160
T10-23	BT10023	23	71,35	160	160
T10-24	BT10024	24	74,55	160	160
T10-26	BT10026	26	80,90	160	160
T10-28	BT10028	28	87,25	160	160
T10-30	BT10030	30	93,65	160	160
T10-32	BT10032	32	100,00	160	160
T10-34	BT10034	34	106,40	160	160
T10-36	BT10036	36	112,75	160	160
T10-38	BT10038	38	119,10	160	160
T10-40	BT10040	40	125,45	160	160
T10-45	BT10045	45	141,40	160	160
T10-48	BT10048	48	150,95	160	160
T10-60	BT10060	60	189,10	160	160
T10-72	BT10072	72	227,29	160	160

Per barre con n. di denti non inclusi in queste tavole, chiedere per quotazione.

For bars with a number of teeth not included in these tables please ask for our quotation.

Verlangen sie Angebot für Stangen mit anzahl von Zaehnen die nicht in diesen Tafeln aufgefuehrt sind.

Pour les barreaux avec un nombre de dents different du tableau, nous consulter.

Pidan oferta por lo que concierne a una cantidad de dientes no incluida en estas tablas.

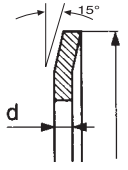
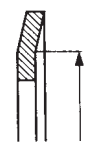
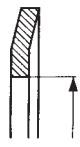

N. denti N. of teeth Zahnezahl N. bre de dents Cantidad de dientes	Flangia / Flanges / Bordscheiben / Flasques / Tapetas				Tipo flangia Flanges type Bordcheiben Typ Type flasques Tipo tapetas			
	d = 0,5 mm	d = 1 mm	d = 1 mm	d = 1,5 mm				
	<b>T 2,5</b>	<b>T 5</b>	<b>T 10</b>	<b>T 20</b>				
8	-	-	-	-	<b>F 01</b>	13,0	10,0	6,0
9	-	-	-	-	<b>F 02</b>	15,0	12,0	8,0
10	-	F 06	-	-	<b>F 03</b>	16,0	13,0	9,5
11	-	-	-	-	<b>F 04</b>	17,5	14,5	11,6
12	F 01	F 07	F 15	-	<b>F 05</b>	18,0	15,0	11,5
13	-	-	-	-	<b>F 06</b>	20,0	16,5	12,2
14	F 02	F 08	F 18	-	<b>F 07</b>	23,0	18,0	12,5
15	F 02	F 09	F 19	-	<b>F 08</b>	25,0	21,5	15,0
16	F 03	F 10	F 20	-	<b>F 09</b>	28,0	24,0	17,8
17	-	-	-	-	<b>F 10</b>	32,0	27,5	23,0
18	F 04	F 10	F 22	F 38	<b>F 11</b>	35,0	30,5	23,0
19	F 05	F 12	F 25	-	<b>F 12</b>	36,0	31,0	25,0
20	F 06	F 12	F 25	F 43	<b>F 13</b>	37,0	33,0	25,0
21	-	-	-	-	<b>F 14</b>	38,0	34,0	26,5
22	F 07	F 14	F 27	F 46	<b>F 15</b>	42,0	38,0	30,5
23	-	-	-	-	<b>F 16</b>	43,0	39,0	31,0
24	F 07	F 15	F 29	F 50	<b>F 17</b>	44,0	40,5	32,5
25	F 07	F 17	F 29	F 52	<b>F 18</b>	48,0	43,5	37,0
26	F 08	F 17	F 30	-	<b>F 19</b>	51,0	47,0	40,0
27	-	F 18	F 31	-	<b>F 20</b>	54,0	50,5	43,0
28	F 08	F 18	F 32	-	<b>F 21</b>	57,0	52,0	46,0
29	-	-	-	-	<b>F 22</b>	60,0	57,0	47,0
30	F 09	F 19	F 33	F 59	<b>F 23</b>	61,0	56,5	49,0
31	-	-	-	-	<b>F 24</b>	64,0	57,0	47,0
32	F 10	F 20	F 35	-	<b>F 25</b>	66,0	63,0	52,0
33	-	-	-	-	<b>F 26</b>	70,0	66,5	53,0
34	-	-	-	-	<b>F 27</b>	75,0	68,5	60,0
35	-	-	-	-	<b>F 28</b>	79,0	72,5	60,0
36	F 12	F 24	F 38	-	<b>F 29</b>	83,0	78,0	68,0
37	-	-	-	-	<b>F 30</b>	87,0	82,5	72,0
38	-	-	-	-	<b>F 31</b>	91,0	85,5	76,0
39	-	-	-	-	<b>F 32</b>	93,0	89,0	80,0
40	F 14	F 25	F 41	-	<b>F 33</b>	97,0	93,8	83,0
41	-	-	-	-	<b>F 34</b>	102,0	97,0	82,5
42	-	F 26	-	-	<b>F 35</b>	106,0	101,0	90,0
43	-	-	-	-	<b>F 36</b>	112,0	105,5	91,0
44	F 15	-	-	-	<b>F 37</b>	115,0	109,0	94,0
45	-	-	-	-	<b>F 38</b>	120,0	112,5	99,5
46	-	-	-	-	<b>F 39</b>	123,0	117,5	107,0
47	-	-	-	-	<b>F 40</b>	128,0	124,0	107,0
48	-	-	-	-	<b>F 41</b>	131,0	125,5	115,0
49	-	-	-	-	<b>F 42</b>	135,0	128,5	115,0
50	-	-	-	-	<b>F 43</b>	138,0	132,0	121,0
51	-	-	-	-	<b>F 44</b>	140,0	125,0	107,0
52	-	-	-	-	<b>F 45</b>	142,0	137,0	120,0
53	-	-	-	-	<b>F 46</b>	146,0	133,0	107,0
54	-	-	-	-	<b>F 47</b>	148,0	143,0	132,0
55	-	-	-	-	<b>F 48</b>	150,0	145,0	130,0
56	-	-	-	-	<b>F 49</b>	154,0	142,0	122,0
57	-	-	-	-	<b>F 50</b>	158,0	153,0	138,5
58	-	-	-	-	<b>F 51</b>	160,0	148,0	120,0
59	-	-	-	-	<b>F 52</b>	168,0	161,0	148,0
60	-	-	-	-	<b>F 53</b>	175,0	170,0	157,0
61	-	-	-	-	<b>F 54</b>	180,0	174,0	154,0
62	-	-	-	-	<b>F 55</b>	184,0	168,0	135,0
63	-	-	-	-	<b>F 56</b>	188,0	176,0	150,0
64	-	-	-	-	<b>F 57</b>	192,0	187,0	173,0
65	-	-	-	-	<b>F 58</b>	198,0	180,0	150,0
66	-	-	-	-	<b>F 59</b>	200,0	193,0	180,0
					<b>F 60</b>	205,0	189,0	160,0
					<b>F 61</b>	212,0	200,0	162,0
					<b>F 62</b>	226,0	214,0	190,0
					<b>F 63</b>	230,0	222,0	200,0
					<b>F 64</b>	240,0	224,0	192,0
					<b>F 65</b>	250,0	228,0	200,0
					<b>F 66</b>	256,0	240,0	220,0
					<b>F 67</b>	265,0	240,0	213,0
					<b>F 68</b>	275,0	253,0	225,0
					<b>F 69</b>	286,0	277,0	242,0
					<b>F 70</b>	296,0	287,0	260,0
					<b>F 71</b>	300,0	280,0	252,0
					<b>F 72</b>	325,0	305,0	278,0
					<b>F 73</b>	350,0	330,0	302,0
					<b>F 74</b>	375,0	355,0	328,0
					<b>F 75</b>	405,0	380,0	354,0
					<b>F 76</b>	430,0	406,0	380,0
					<b>F 77</b>	455,0	432,0	405,0
					<b>F 78</b>	480,0	457,0	430,0
					<b>F 79</b>	530,0	508,0	481,0
					<b>F 80</b>	595,0	572,0	544,0



**Pulegge per cinghie dentate  
passo metrico ST per cinghie «AT»**

**ST Timing belt pulleys metric pitch for «AT» belts**

**ST Zahnriemenscheiben metrische  
Teilung für «AT» riemen**

**Poulies dentées ST  
pour courroies «AT» pas métrique**

**Poleas dentadas ST para correas «AT»  
con paso metrico**



**Pulegge per cinghie dentate passo metrico ST per cinghie "AT"**  
**ST Timing belt pulleys metric pitch for "AT" belts**  
**ST Zahnriemenscheiben metrische Teilung für "AT" riemen**  
**Poulies dentées ST pour courroies "AT" pas métrique**  
**Poleas dentadas ST para correas "AT" con paso metrico**

**Materiale:**  
 alluminio 6082 T6 UNI  
 9006/4 adatto al trattamento  
 anodico

**Material:**  
 aluminium 6082 T6 UNI  
 9006/4 suitable for anodic  
 treatment

**Werkstoff:**  
 aluminium 6082 T6 UNI  
 9006/4 geeignet für  
 anodischen oxydation

**Matière:**  
 aluminium 6082 T6 UNI  
 9006/4 apte au traitement  
 anodique

**Material:**  
 aluminio 6082 T6 UNI  
 9006/4 apto para la  
 oxidacion anodica

**Tipo / Type**  
**6F**

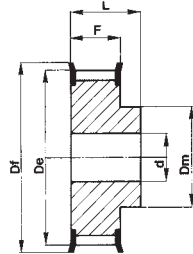

**Tipo / Type**  
**6**

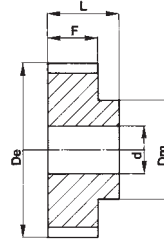

**ST 5**

(Passo 5 mm)  
 per cinghia larghezza 10 mm

(Pitch 5 mm)  
 for belt width 10 mm

(Teilung 5 mm)  
 für Riemenbreite 10 mm

(Pas 5 mm)  
 pour courroies largeur 10 mm

(Paso 5 mm)  
 para correas ancho 10 mm

Code symbol / Fabriknummer Code symbole / Numero de fabrica	Nostro codice Our code / Unser kodex Notre code / Nuestro codigo	Tipo / Typ Type / Tipo	Tipo flangia Flanges type / Bordscheiben Typ Type flasques / Tipo tapetas	N. denti N. of teeth / Zahnezahl N. bre de dents / Cantidad de dientes	De	Df	Dm	F	L	d	Peso / Weight Gewicht / Poids / Peso Kg
21 ST5/12-2	21ST512	6F	F07	12	17,85	23,0	11	15	21	4	0,018
21 ST5/14-2	21ST514	6F	F08	14	21,05	25,0	14	15	21	4	0,019
21 ST5/15-2	21ST515	6F	F09	15	22,65	28,0	16	15	21	6	0,021
21 ST5/16-2	21ST516	6F	F10	16	24,20	32,0	18	15	21	6	0,025
21 ST5/18-2	21ST518	6F	F10	18	27,40	32,0	20	15	21	6	0,031
21 ST5/19-2	21ST519	6F	F12	19	29,00	36,0	22	15	21	6	0,036
21 ST5/20-2	21ST520	6F	F12	20	30,60	36,0	23	15	21	6	0,038
21 ST5/22-2	21ST522	6F	F14	22	33,85	38,0	24	15	21	6	0,048
21 ST5/24-2	21ST524	6F	F15	24	37,00	42,0	26	15	21	6	0,054
21 ST5/25-2	21ST525	6F	F17	25	38,60	44,0	26	15	21	6	0,058
21 ST5/26-2	21ST526	6F	F17	26	40,20	44,0	26	15	21	6	0,062
21 ST5/27-2	21ST527	6F	F18	27	41,80	48,0	30	15	21	8	0,064
21 ST5/28-2	21ST528	6F	F18	28	43,35	48,0	32	15	21	8	0,071
21 ST5/30-2	21ST530	6F	F19	30	46,55	51,0	34	15	21	8	0,076
21 ST5/32-2	21ST532	6F	F20	32	49,70	54,0	36	15	21	8	0,088
21 ST5/36-2	21ST536	6F	F24	36	56,05	64,0	38	15	21	8	0,114
21 ST5/40-2	21ST540	6F	F25	40	62,45	66,0	40	15	21	8	0,138
21 ST5/42-2	21ST542	6F	F26	42	65,60	70,0	40	15	21	8	0,180
21 ST5/44-0	21ST544	6	-	44	68,80	-	45	15	21	8	0,185
21 ST5/48-0	21ST548	6	-	48	75,15	-	50	15	21	8	0,200
21 ST5/60-0	21ST560	6	-	60	94,25	-	65	15	21	8	0,307

(Passo 5 mm)  
 per cinghia larghezza 16 mm

(Pitch 5 mm)  
 for belt width 16 mm

(Teilung 5 mm)  
 für Riemenbreite 16 mm

(Pas 5 mm)  
 pour courroies largeur 16 mm

(Paso 5 mm)  
 para correas ancho 16 mm

Code symbol / Fabriknummer Code symbole / Numero de fabrica	Nostro codice Our code / Unser kodex Notre code / Nuestro codigo	Tipo / Typ Type / Tipo	Tipo flangia Flanges type / Bordscheiben Typ Type flasques / Tipo tapetas	N. denti N. of teeth / Zahnezahl N. bre de dents / Cantidad de dientes	De	Df	Dm	F	L	d	Peso / Weight Gewicht / Poids / Peso Kg
27 ST5/12-2	27ST512	6F	F07	12	17,85	23,0	11	21	27	4	0,022
27 ST5/14-2	27ST514	6F	F08	14	21,05	25,0	14	21	27	4	0,026
27 ST5/15-2	27ST515	6F	F09	15	22,65	28,0	16	21	27	6	0,029
27 ST5/16-2	27ST516	6F	F10	16	24,20	32,0	18	21	27	6	0,035
27 ST5/18-2	27ST518	6F	F10	18	27,40	32,0	20	21	27	6	0,043
27 ST5/19-2	27ST519	6F	F12	19	29,00	36,0	22	21	27	6	0,049
27 ST5/20-2	27ST520	6F	F12	20	30,60	36,0	23	21	27	6	0,053
27 ST5/22-2	27ST522	6F	F14	22	33,85	38,0	24	21	27	6	0,054
27 ST5/24-2	27ST524	6F	F15	24	37,00	42,0	26	21	27	6	0,076
27 ST5/25-2	27ST525	6F	F17	25	38,60	44,0	26	21	27	6	0,081
27 ST5/26-2	27ST526	6F	F17	26	40,20	44,0	26	21	27	6	0,085
27 ST5/27-2	27ST527	6F	F18	27	41,80	48,0	30	21	27	8	0,090
27 ST5/28-2	27ST528	6F	F18	28	43,35	48,0	32	21	27	8	0,092
27 ST5/30-2	27ST530	6F	F19	30	46,55	51,0	34	21	27	8	0,105
27 ST5/32-2	27ST532	6F	F20	32	49,70	54,0	36	21	27	8	0,123
27 ST5/36-2	27ST536	6F	F24	36	56,05	64,0	38	21	27	8	0,160
27 ST5/40-2	27ST540	6F	F25	40	62,45	66,0	40	21	27	8	0,193
27 ST5/42-2	27ST542	6F	F26	42	65,60	70,0	40	21	27	8	0,205
27 ST5/44-0	27ST544	6	-	44	68,80	-	45	21	27	8	0,228
27 ST5/48-0	27ST548	6	-	48	75,15	-	50	21	27	8	0,280
27 ST5/60-0	27ST560	6	-	60	94,25	-	65	21	27	8	0,430

(Passo 5 mm)  
 per cinghia larghezza 25 mm

(Pitch 5 mm)  
 for belt width 25 mm

(Teilung 5 mm)  
 für Riemenbreite 25 mm

(Pas 5 mm)  
 pour courroies largeur 25 mm

(Paso 5 mm)  
 para correas ancho 25 mm

Code symbol / Fabriknummer Code symbole / Numero de fabrica	Nostro codice Our code / Unser kodex Notre code / Nuestro codigo	Tipo / Typ Type / Tipo	Tipo flangia Flanges type / Bordscheiben Typ Type flasques / Tipo tapetas	N. denti N. of teeth / Zahnezahl N. bre de dents / Cantidad de dientes	De	Df	Dm	F	L	d	Peso / Weight Gewicht / Poids / Peso Kg
36 ST5/12-2	36ST512	6F	F07	12	17,85	23,0	11	30	36	4	0,031
36 ST5/14-2	36ST514	6F	F08	14	21,05	25,0	14	30	36	4	0,037
36 ST5/15-2	36ST515	6F	F09	15	22,65	28,0	16	30	36	6	0,041
36 ST5/16-2	36ST516	6F	F10	16	24,20	32,0	18	30	36	6	0,050
36 ST5/18-2	36ST518	6F	F10	18	27,40	32,0	20	30	36	6	0,061
36 ST5/19-2	36ST519	6F	F12	19	29,00	36,0	22	30	36	6	0,070
36 ST5/20-2	36ST520	6F	F12	20	30,60	36,0	23	30	36	6	0,076
36 ST5/22-2	36ST522	6F	F14	22	33,85	38,0	24	30	36	6	0,080
36 ST5/24-2	36ST524	6F	F15	24	37,00	42,0	26	30	36	6	0,109
36 ST5/25-2	36ST525	6F	F17	25	38,60	44,0	26	30	36	6	0,118
36 ST5/26-2	36ST526	6F	F17	26	40,20	44,0	26	30	36	6	0,120
36 ST5/27-2	36ST527	6F	F18	27	41,80	48,0	30	30	36	8	0,128
36 ST5/28-2	36ST528	6F	F18	28	43,35	48,0	32	30	36	8	0,135
36 ST5/30-2	36ST530	6F	F19	30	46,55	51,0	34	30	36	8	0,150
36 ST5/32-2	36ST532	6F	F20	32	49,70	54,0	36	30	36	8	0,178
36 ST5/36-2	36ST536	6F	F24	36	56,05	64,0	38	30	36	8	0,230
36 ST5/40-2	36ST540	6F	F25	40	62,45	66,0	40	30	36	8	0,278
36 ST5/42-2	36ST542	6F	F26	42	65,60	70,0	40	30	36	8	0,284
36 ST5/44-0	36ST544	6	-	44	68,80	-	45	30	36	8	0,315
36 ST5/48-0	36ST548	6	-	48	75,15	-	50	30	36	8	0,400
36 ST5/60-0	36ST560	6	-	60	94,25	-	65	30	36	8	0,614

**Pulegge per cinghie dentate passo metrico ST per cinghie "AT"**  
**ST Timing belt pulleys metric pitch for "AT" belts**  
**ST Zahnriemenscheiben metrische Teilung für "AT" riemen**  
**Poulies dentées ST pour courroies "AT" pas métrique**  
**Poleas dentadas ST para correas "AT" con paso metrico**



**Materiale:** alluminio 6082 T6 UNI 9006/4 adatto al trattamento anodico  
**Material:** aluminium 6082 T6 UNI 9006/4 suitable for anodic treatment  
**Werkstoff:** aluminium 6082 T6 UNI 9006/4 geeignet für anodischen oxydation  
**Matière:** aluminium 6082 T6 UNI 9006/4 apte au traitement anodique  
**Material:** aluminio 6082 T6 UNI 9006/4 apto para la oxidación anodica

**Tipo / Type**  
**6F**

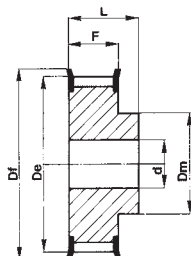

**Tipo / Type**  
**6**

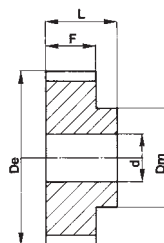

**ST 10**

(Passo 10 mm) per cinghia larghezza 16 mm (Pitch 10 mm) for belt width 16 mm (Teilung 10 mm) für Riemenbreite 16 mm (Pas 10 mm) pour courroies largeur 16 mm (Paso 10 mm) para correas ancho 16 mm

Codice Code symbol / Fabriknummer Code symbole / Numero de fabrica	Nostro codice Our code / Unser kode Notre code / Nuestro codigo	Tipo Type / Typ Type / Tipo	Tipo flangia Flanges type / Bordscheiben Typ Type flasques / Tipo tapetas	N. denti N. of teeth / Zahnezahl N. bre de dents / Cantidad de dientes	De	Df	Dm	F	L	d	Peso / Weight Gewicht / Poids / Peso Kg
31 ST10/15-2	31ST115	6F	F19	15	45,90	51	31	21	31	8	0,118
31 ST10/16-2	31ST116	6F	F20	16	49,05	54	35	21	31	8	0,134
31 ST10/18-2	31ST118	6F	F22	18	55,45	60	40	21	31	8	0,167
31 ST10/19-2	31ST119	6F	F25	19	58,60	66	44	21	31	8	0,184
31 ST10/20-2	31ST120	6F	F25	20	61,80	66	46	21	31	8	0,208
31 ST10/22-2	31ST122	6F	F27	22	68,15	75	52	21	31	8	0,253
31 ST10/24-2	31ST124	6F	F29	24	74,55	83	58	21	31	8	0,288
31 ST10/25-2	31ST125	6F	F29	25	77,70	83	60	21	31	8	0,310
31 ST10/26-2	31ST126	6F	F30	26	80,90	87	60	21	31	8	0,357
31 ST10/27-2	31ST127	6F	F31	27	84,10	91	60	21	31	8	0,364
31 ST10/28-2	31ST128	6F	F32	28	87,25	93	60	21	31	8	0,401
31 ST10/30-2	31ST130	6F	F33	30	93,65	97	60	21	31	8	0,441
31 ST10/32-2	31ST132	6F	F35	32	100,00	106	65	21	31	10	0,493
31 ST10/36-2	31ST136	6F	F38	36	112,75	120	70	21	31	10	0,623
31 ST10/40-2	31ST140	6F	F42	40	125,45	135	80	21	31	10	0,787
31 ST10/44-0	31ST144	6		44	138,20	-	88	21	31	10	0,993
31 ST10/48-0	31ST148	6		48	150,95	-	95	21	31	16	1,090
31 ST10/60-0	31ST160	6		60	189,10	-	110	21	31	16	1,701

(Passo 10 mm) per cinghia larghezza 25 mm (Pitch 10 mm) for belt width 25 mm (Teilung 10 mm) für Riemenbreite 25 mm (Pas 10 mm) pour courroies largeur 25 mm (Paso 10 mm) para correas ancho 25 mm

40 ST10/15-2	40ST115	6F	F19	15	45,90	51	32	30	40	8	0,152
40 ST10/16-2	40ST116	6F	F20	16	49,05	54	35	30	40	8	0,176
40 ST10/18-2	40ST118	6F	F22	18	55,45	60	40	30	40	8	0,224
40 ST10/19-2	40ST119	6F	F25	19	58,60	66	44	30	40	8	0,247
40 ST10/20-2	40ST120	6F	F25	20	61,80	66	46	30	40	8	0,276
40 ST10/22-2	40ST122	6F	F27	22	68,15	75	52	30	40	8	0,337
40 ST10/24-2	40ST124	6F	F29	24	74,55	83	58	30	40	8	0,392
40 ST10/25-2	40ST125	6F	F29	25	77,70	83	60	30	40	8	0,422
40 ST10/26-2	40ST126	6F	F30	26	80,90	87	60	30	40	8	0,477
40 ST10/27-2	40ST127	6F	F31	27	84,10	91	60	30	40	8	0,536
40 ST10/28-2	40ST128	6F	F32	28	87,25	93	60	30	40	8	0,540
40 ST10/30-2	40ST130	6F	F33	30	93,65	97	60	30	40	8	0,640
40 ST10/32-2	40ST132	6F	F35	32	100,00	106	65	30	40	10	0,693
40 ST10/36-2	40ST136	6F	F38	36	112,75	120	70	30	40	10	0,873
40 ST10/40-2	40ST140	6F	F42	40	125,45	135	80	30	40	10	1,067
40 ST10/44-0	40ST144	6		44	138,20	-	88	30	40	10	1,350
40 ST10/48-0	40ST148	6		48	150,95	-	95	30	40	16	1,516
40 ST10/60-0	40ST160	6		60	189,10	-	110	30	40	16	2,339

**Pulegge per cinghie dentate passo metrico ST per cinghie "AT"**  
**ST Timing belt pulleys metric pitch for "AT" belts**  
**ST Zahnriemenscheiben metrische Teilung für "AT" riemen**  
**Poulies dentées ST pour courroies "AT" pas métrique**  
**Poleas dentadas ST para correas "AT" con paso metrico**

**Materiale:**  
 alluminio 6082 T6 UNI  
 9006/4 adatto al trattamento  
 anodico

**Material:**  
 aluminium 6082 T6 UNI  
 9006/4 suitable for anodic  
 treatment

**Werkstoff:**  
 aluminium 6082 T6 UNI  
 9006/4 geeignet für  
 anodischen oxydation

**Matière:**  
 aluminium 6082 T6 UNI  
 9006/4 apte au traitement  
 anodique

**Material:**  
 aluminio 6082 T6 UNI  
 9006/4 apto para la  
 oxidacion anodica

**Tipo / Type**  
**6F**

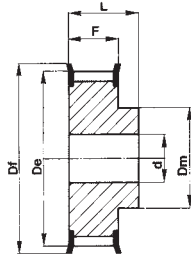

**Tipo / Type**  
**6**

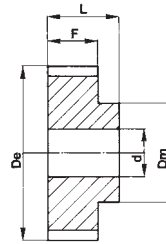

## ST 10

(Passo 10 mm)  
 per cinghia larghezza 32 mm

(Pitch 10 mm)  
 for belt width 32 mm

(Teilung 10 mm)  
 für Riemenbreite 32 mm

(Pas 10 mm)  
 pour courroies largeur 32 mm

(Paso 10 mm)  
 para correas ancho 32 mm

Codice Code symbol / Fabriknummer Code symbole / Numero de fabrica	Nostro codice Our code / Unser kode Notre code / Nuestro codigo	Tipo Type / Typ Type / Tipo	Tipo flangia Flanges type / Bordscheiben Typ Type flasques / Tipo tapetas	N. denti N. of teeth / Zahnezahl N. bre de dents / Cantidad de dientes	De	Df	Dm	F	L	d	Peso / Weight Gewicht / Poids / Peso Kg
47 ST10/18-2	47ST118	6F	F22	18	55,45	60	40	37	47	10	0,253
47 ST10/19-2	47ST119	6F	F25	19	58,60	66	44	37	47	10	0,286
47 ST10/20-2	47ST120	6F	F25	20	61,80	66	46	37	47	12	0,322
47 ST10/22-2	47ST122	6F	F27	22	68,15	75	52	37	47	12	0,393
47 ST10/24-2	47ST124	6F	F29	24	74,55	83	58	37	47	12	0,475
47 ST10/25-2	47ST125	6F	F29	25	77,70	83	60	37	47	12	0,527
47 ST10/26-2	47ST126	6F	F30	26	80,90	87	60	37	47	12	0,564
47 ST10/27-2	47ST127	6F	F31	27	84,10	91	60	37	47	12	0,602
47 ST10/28-2	47ST128	6F	F32	28	87,25	93	60	37	47	12	0,642
47 ST10/30-2	47ST130	6F	F33	30	93,65	97	60	37	47	12	0,740
47 ST10/32-2	47ST132	6F	F35	32	100,00	106	65	37	47	12	0,844
47 ST10/36-2	47ST136	6F	F38	36	112,75	120	70	37	47	16	1,063
47 ST10/40-2	47ST140	6F	F42	40	125,45	135	80	37	47	16	1,317
47 ST10/44-0	47ST144	6	-	44	138,20	-	88	37	47	16	1,611
47 ST10/48-0	47ST148	6	-	48	150,95	-	95	37	47	16	1,931
47 ST10/60-0	47ST160	6	-	60	189,10	-	110	37	47	16	3,004

(Passo 10 mm)  
 per cinghia larghezza 50 mm

(Pitch 10 mm)  
 for belt width 50 mm

(Teilung 10 mm)  
 für Riemenbreite 50 mm

(Pas 10 mm)  
 pour courroies largeur 50 mm

(Paso 10 mm)  
 para correas ancho 50 mm

66 ST10/18-2	66ST118	6F	F22	18	55,45	60	40	56	66	10	0,422
66 ST10/19-2	66ST119	6F	F25	19	58,60	66	44	56	66	10	0,466
66 ST10/20-2	66ST120	6F	F25	20	61,80	66	46	56	66	12	0,520
66 ST10/22-2	66ST122	6F	F27	22	68,15	75	52	56	66	12	0,570
66 ST10/24-2	66ST124	6F	F29	24	74,55	83	58	56	66	12	0,736
66 ST10/25-2	66ST125	6F	F29	25	77,70	83	60	56	66	12	0,766
66 ST10/26-2	66ST126	6F	F30	26	80,90	87	60	56	66	12	0,816
66 ST10/27-2	66ST127	6F	F31	27	84,10	91	60	56	66	12	0,946
66 ST10/28-2	66ST128	6F	F32	28	87,25	93	60	56	66	12	0,960
66 ST10/30-2	66ST130	6F	F33	30	93,65	97	60	56	66	12	1,169
66 ST10/32-2	66ST132	6F	F35	32	100,00	106	65	56	66	12	1,300
66 ST10/36-2	66ST136	6F	F38	36	112,75	120	70	56	66	16	1,637
66 ST10/40-2	66ST140	6F	F42	40	125,45	135	80	56	66	16	1,999
66 ST10/44-0	66ST144	6	-	44	138,20	-	88	56	66	16	2,357
66 ST10/48-0	66ST148	6	-	48	150,95	-	95	56	66	16	2,830
66 ST10/60-0	66ST160	6	-	60	189,10	-	110	56	66	16	4,368

**Barre dentate standard ST per cinghie " AT "**  
**ST Standard toothed bars for " AT " belts**  
**ST Standard Zahnriemenstangen für " AT "**  
**Barreaux dentés standard ST pour courroies " AT "**  
**Barras dentadas de serie ST para correas " AT "**

**Materiale:** alluminio 6082 T6 UNI 9006/4 adatto al trattamento anodico  
**Material:** aluminium 6082 T6 UNI 9006/4 suitable for anodic treatment  
**Werkstoff:** aluminium 6082 T6 UNI 9006/4 geeignet für anodischen oxydation  
**Matière:** aluminium 6082 T6 UNI 9006/4 apte au traitement anodique  
**Material:** aluminio 6082 T6 UNI 9006/4 apto para la oxidacion anodica

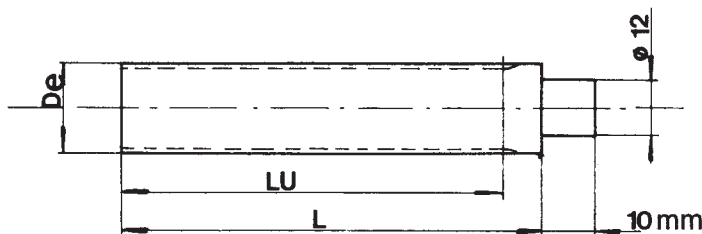

**ST 5**

(Passo 5 mm) / (Pitch 5 mm) / (Teilung 5 mm) / (Pas 5 mm) / (Paso 5 mm)

Codice Code symbol Fabriknummer Code symbole Numero de fabrica	Nostro codice Our code Unser kode Notre code Nuestro codigo	N. denti N. of teeth Zahnezahl N. bre de dents Cantidad de dientes	De	Lu	L
ST05012	BST0512	12	17,85	125	140
ST05013	BST0513	13	19,45	125	140
ST05014	BST0514	14	21,05	132	140
ST05015	BST0515	15	22,65	132	140
ST05016	BST0516	16	24,20	140	140
ST05017	BST0517	17	25,80	140	140
ST05018	BST0518	18	27,40	140	140
ST05019	BST0519	19	29,00	140	140
ST05020	BST0520	20	30,60	160	160
ST05021	BST0521	21	32,30	160	160
ST05022	BST0522	22	33,85	160	160
ST05023	BST0523	23	35,45	160	160
ST05024	BST0524	24	37,00	160	160
ST05025	BST0525	25	38,60	160	160
ST05026	BST0526	26	40,20	160	160
ST05027	BST0527	27	41,80	160	160
ST05028	BST0528	28	43,35	160	160
ST05029	BST0529	29	44,95	160	160
ST05030	BST0530	30	46,55	160	160
ST05031	BST0531	31	48,15	160	160
ST05032	BST0532	32	49,70	160	160
ST05033	BST0533	33	51,30	160	160
ST05034	BST0534	34	52,85	160	160
ST05035	BST0535	35	54,45	160	160
ST05036	BST0536	36	56,05	160	160
ST05038	BST0538	38	59,25	160	160
ST05040	BST0540	40	62,45	160	160
ST05042	BST0542	42	65,60	160	160
ST05044	BST0544	44	68,80	160	160
ST05045	BST0545	45	70,40	160	160
ST05046	BST0546	46	72,00	160	160
ST05048	BST0548	48	75,15	160	160
ST05050	BST0550	50	78,35	160	160
ST05052	BST0552	52	81,55	160	160
ST05054	BST0554	54	84,70	160	160
ST05055	BST0555	55	86,30	160	160
ST05056	BST0556	56	87,90	160	160
ST05058	BST0558	58	91,10	160	160
ST05060	BST0560	60	94,25	160	160
ST05062	BST0562	62	97,45	160	160
ST05064	BST0564	64	100,65	160	160
ST05065	BST0565	65	102,25	160	160
ST05070	BST0570	70	110,20	160	160
ST05072	BST0572	72	113,25	160	160

**ST 10**

(Passo 10 mm) / (Pitch 10 mm) / (Teilung 10 mm) / (Pas 10 mm) / (Paso 10 mm)

Codice Code symbol Fabriknummer Code symbole Numero de fabrica	Nostro codice Our code Unser kode Notre code Nuestro codigo	N. denti N. of teeth Zahnezahl N. bre de dents Cantidad de dientes	De	Lu	L
ST10015	BST1015	15	45,90	160	160
ST10016	BST1016	16	49,05	160	160
ST10017	BST1017	17	52,25	160	160
ST10018	BST1018	18	55,45	160	160
ST10019	BST1019	19	58,60	160	160
ST10020	BST1020	20	61,80	160	160
ST10021	BST1021	21	65,00	160	160
ST10022	BST1022	22	68,15	160	160
ST10023	BST1023	23	71,35	160	160
ST10024	BST1024	24	74,55	160	160
ST10025	BST1025	25	77,70	160	160
ST10026	BST1026	26	80,90	160	160
ST10027	BST1027	27	84,10	160	160
ST10028	BST1028	28	87,25	160	160
ST10029	BST1029	29	90,45	160	160
ST10030	BST1030	30	93,65	160	160
ST10031	BST1031	31	96,80	160	160
ST10032	BST1032	32	100,00	160	160
ST10033	BST1033	33	103,20	160	160
ST10034	BST1034	34	106,40	160	160
ST10035	BST1035	35	109,55	160	160
ST10036	BST1036	36	112,75	160	160
ST10037	BST1037	37	115,90	160	160
ST10038	BST1038	38	119,10	160	160
ST10040	BST1040	40	125,45	160	160
ST10041	BST1041	41	128,65	160	160
ST10042	BST1042	42	131,85	160	160
ST10044	BST1044	44	138,20	160	160
ST10045	BST1045	45	141,40	160	160
ST48046	BST1046	46	144,55	160	160
ST10048	BST1048	48	150,95	160	160
ST10050	BST1050	50	157,30	160	160
ST10051	BST1051	51	160,50	160	160
ST10052	BST1052	52	163,65	160	160
ST10054	BST1054	54	170,05	160	160
ST10055	BST1055	55	173,20	160	160
ST10056	BST1056	56	176,40	160	160
ST10057	BST1057	57	179,60	160	160
ST10058	BST1058	58	182,75	160	160
ST10059	BST1059	59	185,95	160	160
ST10060	BST1060	60	189,10	160	160
ST10062	BST1062	62	195,50	160	160
ST10070	BST1070	70	220,95	160	160
ST10075	BST1075	75	236,90	160	160

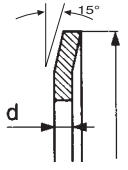
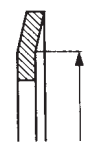
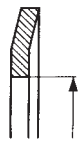

N. denti N. of teeth Zahnezahl N. bre de dents Cantidad de dientes	Flangia / Flanges / Bordscheiben / Flasques / Tapetas		Tipo flangia Flanges type Bordcheiben Typ Type flasques Tipo tapetas			
	d = 1 mm	d = 1 mm				
	<b>AT 5</b>	<b>AT 10</b>				
8	-	-	<b>F 01</b>	13,0	10,0	6,0
9	-	-	<b>F 02</b>	15,0	12,0	8,0
10	-	-	<b>F 03</b>	16,0	13,0	9,5
11	-	-	<b>F 04</b>	17,5	14,5	11,6
12	F 07	-	<b>F 05</b>	18,0	15,0	11,5
13	-	-	<b>F 06</b>	20,0	16,5	12,2
14	F 08	-	<b>F 07</b>	23,0	18,0	12,5
15	F 09	F 19	<b>F 08</b>	25,0	21,5	15,0
16	F 10	F 20	<b>F 09</b>	28,0	24,0	17,8
17	-	-	<b>F 10</b>	32,0	27,5	23,0
18	F 10	F 22	<b>F 11</b>	35,0	30,5	23,0
19	F 12	F 25	<b>F 12</b>	36,0	31,0	25,0
20	F 12	F 25	<b>F 13</b>	37,0	33,0	25,0
21	-	-	<b>F 14</b>	38,0	34,0	26,5
22	F 14	F 27	<b>F 15</b>	42,0	38,0	30,5
23	-	-	<b>F 16</b>	43,0	39,0	31,0
24	F 15	F 29	<b>F 17</b>	44,0	40,5	32,5
25	F 17	F 29	<b>F 18</b>	48,0	43,5	37,0
26	F 17	F 30	<b>F 19</b>	51,0	47,0	40,0
27	F 18	F 31	<b>F 20</b>	54,0	50,5	43,0
28	F 18	F 32	<b>F 21</b>	57,0	52,0	46,0
29	-	-	<b>F 22</b>	60,0	57,0	47,0
30	F 19	F 33	<b>F 23</b>	61,0	56,5	49,0
31	-	-	<b>F 24</b>	64,0	57,0	47,0
32	F 20	F 35	<b>F 25</b>	66,0	63,0	52,0
33	-	-	<b>F 26</b>	70,0	66,5	53,0
34	-	-	<b>F 27</b>	75,0	68,5	60,0
35	-	-	<b>F 28</b>	79,0	72,5	60,0
36	F 24	F 38	<b>F 29</b>	83,0	78,0	68,0
37	-	-	<b>F 30</b>	87,0	82,5	72,0
38	-	-	<b>F 31</b>	91,0	85,5	76,0
39	-	-	<b>F 32</b>	93,0	89,0	80,0
40	F 25	F 42	<b>F 33</b>	97,0	93,8	83,0
41	-	-	<b>F 34</b>	102,0	97,0	82,5
42	F 26	-	<b>F 35</b>	106,0	101,0	90,0
43	-	-	<b>F 36</b>	112,0	105,5	91,0
44	-	-	<b>F 37</b>	115,0	109,0	94,0
45	-	-	<b>F 38</b>	120,0	112,5	99,5
46	-	-	<b>F 39</b>	123,0	117,5	107,0
47	-	-	<b>F 40</b>	128,0	124,0	107,0
48	-	-	<b>F 41</b>	131,0	125,5	115,0
49	-	-	<b>F 42</b>	135,0	128,5	115,0
50	-	-	<b>F 43</b>	138,0	132,0	121,0
51	-	-	<b>F 44</b>	140,0	125,0	107,0
52	-	-	<b>F 45</b>	142,0	137,0	120,0
53	-	-	<b>F 46</b>	146,0	133,0	107,0
54	-	-	<b>F 47</b>	148,0	143,0	132,0
55	-	-	<b>F 48</b>	150,0	145,0	130,0
56	-	-	<b>F 49</b>	154,0	142,0	122,0
57	-	-	<b>F 50</b>	158,0	153,0	138,5
58	-	-	<b>F 51</b>	160,0	148,0	120,0
59	-	-	<b>F 52</b>	168,0	161,0	148,0
60	-	-	<b>F 53</b>	175,0	170,0	157,0
61	-	-	<b>F 54</b>	180,0	174,0	154,0
62	-	-	<b>F 55</b>	184,0	177,0	162,0
63	-	-	<b>F 56</b>	188,0	176,0	150,0
64	-	-	<b>F 57</b>	192,0	187,0	173,0
65	-	-	<b>F 58</b>	198,0	180,0	150,0
66	-	-	<b>F 59</b>	200,0	193,0	180,0
			<b>F 60</b>	205,0	189,0	160,0
			<b>F 61</b>	212,0	200,0	162,0
			<b>F 62</b>	226,0	214,0	190,0
			<b>F 63</b>	230,0	222,0	200,0
			<b>F 64</b>	240,0	224,0	192,0
			<b>F 65</b>	250,0	228,0	200,0
			<b>F 66</b>	256,0	240,0	220,0
			<b>F 67</b>	265,0	240,0	213,0
			<b>F 68</b>	275,0	253,0	225,0
			<b>F 69</b>	286,0	277,0	242,0
			<b>F 70</b>	296,0	287,0	260,0
			<b>F 71</b>	300,0	280,0	252,0
			<b>F 72</b>	325,0	305,0	278,0
			<b>F 73</b>	350,0	330,0	302,0
			<b>F 74</b>	375,0	355,0	328,0
			<b>F 75</b>	405,0	380,0	354,0
			<b>F 76</b>	430,0	406,0	380,0
			<b>F 77</b>	455,0	432,0	405,0
			<b>F 78</b>	480,0	457,0	430,0
			<b>F 79</b>	530,0	508,0	481,0
			<b>F 80</b>	595,0	572,0	544,0
			<b>F 81</b>	184,0	168,0	135,0