



SELLOS MECÁNICOS

GARNITURES MÉCANIQUES

250-R / 250 KU-R

250 NU-R

MECHANICAL SEALS

GLEITRINGDICHTUNGEN



250-R / 250 KU-R 250 NU-R

Sello mecánico de fuelle, equilibrado, muelle simple, sentido de rotación independiente.
Garniture mécanique à soufflet, équilibrée, ressort simple, sens de rotation indépendant.
Bellows mechanical seal, balanced, single spring, independent on direction of rotation.
Rollbalgdichtung, entlastet, einfache Feder, drehrichtungsunabhängig.

TABLA DIMENSIONAL (Dimensiones en mm. sujetas a variaciones o modificaciones)

TABLEAU DIMENSIONNEL (Dimensions en mm. sujettes à variations ou modifications)

| Ref. | d ₁ | d ₃ | d ₄ | d ₆ | d ₇ | l ₃ | l _{3KU} | l _{3NU} | l ₄ |
|------|----------------|----------------|----------------|----------------|----------------|----------------|------------------|------------------|----------------|
| 10 | 10 | 20 | 22 | 15 | 21 | 15 | 27.5 | 35.0 | 5.0 |
| 12 | 12 | 22 | 24 | 17 | 23 | 15 | 26.5 | 34.0 | 6.0 |
| 14 | 14 | 24 | 26 | 19 | 25 | 15 | 29.0 | 34.0 | 6.0 |
| 15 | 15 | 25 | 27 | 20 | 26 | 15 | 29.0 | 34.0 | 6.0 |
| 16 | 16 | 26 | 28 | 23 | 27 | 15 | 29.0 | 34.0 | 6.0 |
| 18 | 18 | 32 | 34 | 25 | 33 | 20 | 31.5 | 39.0 | 6.0 |
| 20 | 20 | 34 | 36 | 27 | 35 | 20 | 31.5 | 39.0 | 6.0 |
| 22 | 22 | 36 | 38 | 29 | 37 | 20 | 31.5 | 39.0 | 6.0 |
| 24 | 24 | 38 | 40 | 31 | 39 | 20 | 34.0 | 44.0 | 6.0 |
| 25 | 25 | 39 | 41 | 32 | 40 | 20 | 34.0 | 44.0 | 6.0 |
| 28 | 28 | 42 | 44 | 35 | 43 | 26 | 36.5 | 44.0 | 6.0 |
| 30 | 30 | 44 | 46 | 37 | 45 | 26 | 35.5 | 43.0 | 7.0 |
| 32 | 32 | 46 | 48 | 40 | 48 | 26 | 35.5 | 48.0 | 7.0 |
| 33 | 33 | 47 | 49 | 40 | 48 | 26 | 35.5 | 48.0 | 7.0 |
| 35 | 35 | 49 | 51 | 42 | 50 | 26 | 34.5 | 47.0 | 8.0 |
| 38 | 38 | 54 | 58 | 47 | 56 | 30 | 37.0 | 47.0 | 8.0 |
| 40 | 40 | 56 | 60 | 49 | 58 | 30 | 37.0 | 47.0 | 8.0 |
| 43 | 43 | 59 | 63 | 52 | 61 | 30 | 37.0 | 52.0 | 8.0 |
| 45 | 45 | 61 | 65 | 54 | 63 | 30 | 37.0 | 52.0 | 8.0 |
| 48 | 48 | 64 | 68 | 57 | 66 | 30 | 35.0 | 50.0 | 10.0 |
| 50 | 50 | 66 | 70 | 60 | 70 | 30 | 37.5 | 50.0 | 10.0 |
| 53 | 53 | 69 | 73 | 63 | 73 | 30 | 37.5 | 50.0 | 10.0 |
| 55 | 55 | 71 | 75 | 65 | 75 | 30 | 37.5 | 50.0 | 10.0 |
| 58 | 58 | 78 | 83 | 68 | 78 | 33 | 42.5 | 60.0 | 10.0 |
| 60 | 60 | 80 | 85 | 70 | 80 | 33 | 40.5 | 58.0 | 12.0 |
| 63 | 63 | 83 | 88 | 73 | 83 | 33 | 40.5 | 58.0 | 12.0 |
| 65 | 65 | 85 | 90 | 75 | 85 | 33 | 40.5 | 68.0 | 12.0 |
| 68 | 68 | 88 | 93 | 79 | 90 | 33 | 40.5 | 68.0 | 12.0 |
| 70 | 70 | 90 | 95 | 81 | 92 | 33 | 48.0 | 68.0 | 12.0 |
| 75 | 75 | 99 | 104 | 86 | 97 | 40 | 48.0 | 68.0 | 12.0 |
| 80 | 80 | 104 | 109 | 92 | 105 | 40 | 47.5 | 77.5 | 12.5 |
| 85 | 85 | 109 | 114 | 97 | 110 | 40 | 47.5 | 77.5 | 12.5 |
| 90 | 90 | 114 | 119 | 102 | 115 | 40 | 52.5 | 77.5 | 12.5 |
| 95 | 95 | 119 | 124 | 117 | 120 | 40 | 52.5 | 77.5 | 12.5 |
| 100 | 100 | 124 | 129 | 122 | 125 | 40 | 52.5 | 77.5 | 12.5 |

DIMENSIONS TABLE (Measures in mm. subject to change)

TABELLE DER ABMESSUNGEN (In mm. Abweichungen oder Änderungen vorbehalten)

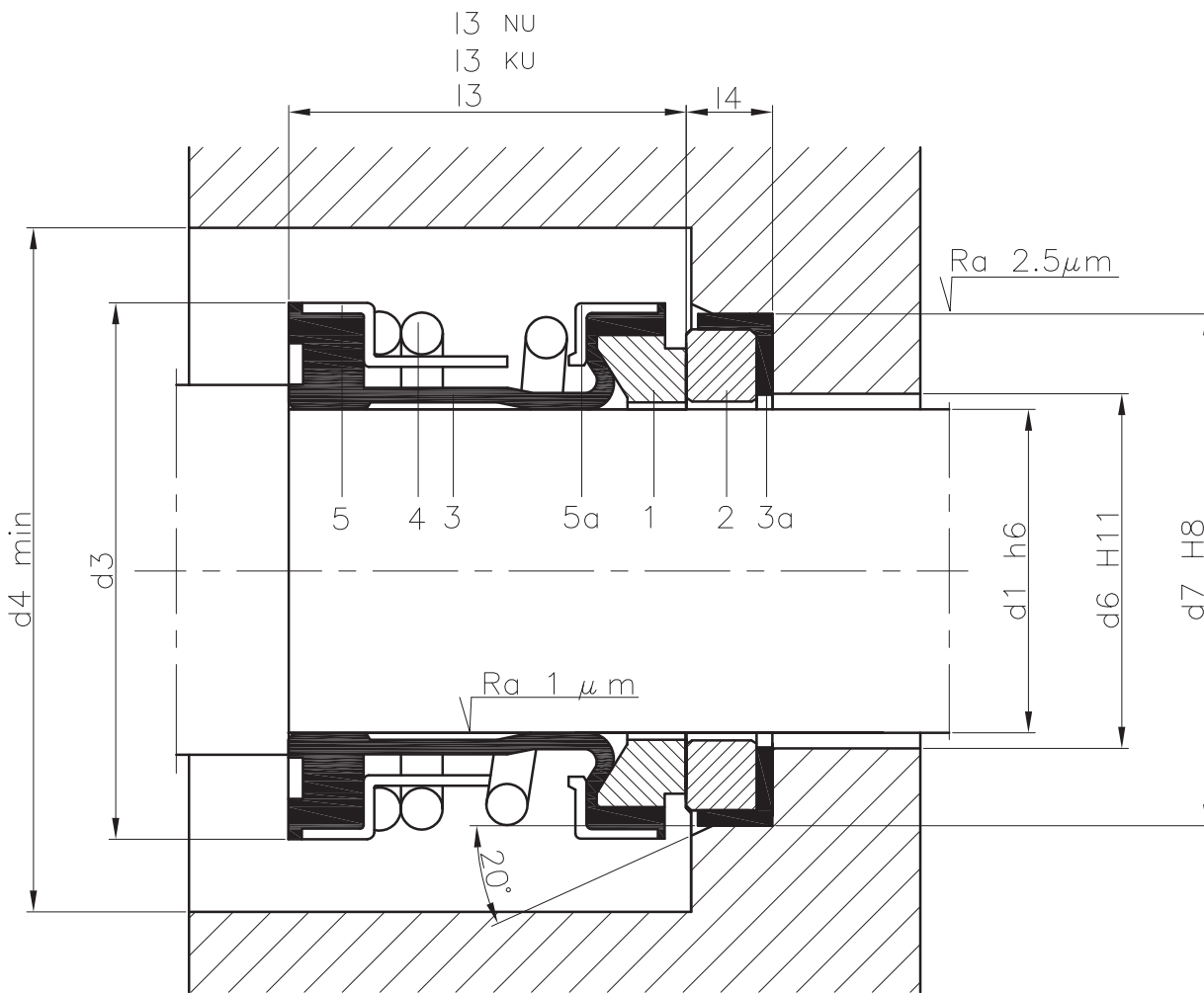

LÍMITES OPERATIVOS / LIMITES D'UTILISATION / OPERATING LIMITS / EINSATZGRENZEN

$d_1 = 10 \div 100 \text{ mm}$

$p/d = 20 \text{ Kg/cm}^2$

$v/g = 15 \text{ m/s}$

$t = -15 \div +200^\circ\text{C}$

Los límites operativos vienen condicionados por el factor PV
 Les limites d'utilisation ci-dessus peuvent varier en fonction du facteur PV
 The operating limits depend on the PV factor
 Die Einsatzgrenzen werden durch den DG-Faktor festgelegt

MATERIALES / MATÉRIAUX / MATERIALS / MATERIALIEN

| | | |
|-------|-------|-------|
| BQEFF | BVEFF | QQEFF |
| BQPFF | BVPFF | QQPFF |
| BQVFF | BVVFF | QQVFF |

Existen otras combinaciones de materiales
 Il existe d'autres combinaisons de matériaux
 Available in other materials
 Es gibt andere Materialkombinationen

COMPONENTES / CONSTRUCTION / COMPONENTS / KOMPONENTEN

- 1 Cara de roce rotante / Grain mobile / Rotative face / Rotierende Gleitfläche
- 2 Cara de roce fija / Grain stationnaire / Stationary face / Stationäre Gleitfläche
- 3 Fuelle / Soufflet / Bellows / Rollbalg
- 3a Junta elastomérica / Joints secondaires en élastomère / Rubber parts / Elastomerdichtung
- 4 Muelle / Ressort / Spring / Feder
- 5 Anillo / Anneau / Ring
- 5a Armadura metálica / Corps / Metal frame / Metallgestell



LIDERING, S.A.

Pg. Ferrocarrils Catalans, 106-108 • 08940 Cornellà de Llobregat BARCELONA

Domestic Sales: 902 480 440

International Sales: +34 93 480 44 22

Fax 93 480 44 04



Pollensa, 2, Ofic. 8. Edif. Artemisa - Tartessos

28290 Las Rozas MADRID

Tel. 902 480 440 • Fax 91 361 40 20

LIDERING, S.A.R.L.

Parc des Aqueducs • Chemin du Favier RD 42 • 69230 Saint-Genis-Laval FRANCE

Tél. 04 72 67 02 67 • Fax 04 78 56 04 08

LIDERING, GmbH

Schießstraße, 55 • 40549 Düsseldorf DEUTSCHLAND

Tel. 00 34 93 480 44 22 • Fax 00 34 93 480 44 04

S.A. LIDERING N.V.

BP 10 • 1410 Waterloo BELGIQUE-BELGIË

Tél. 00 34 93 480 44 22 • Fax 00 34 93 480 44 04

<http://www.lidering.com>

email: info@lidering.com