

**Pulegge per cinghie dentate**  
**Timing belt pulleys**  
**Zahnriemenscheiben**  
**Poulies pour courroies dentées**  
**Poleas para correas dentadas**

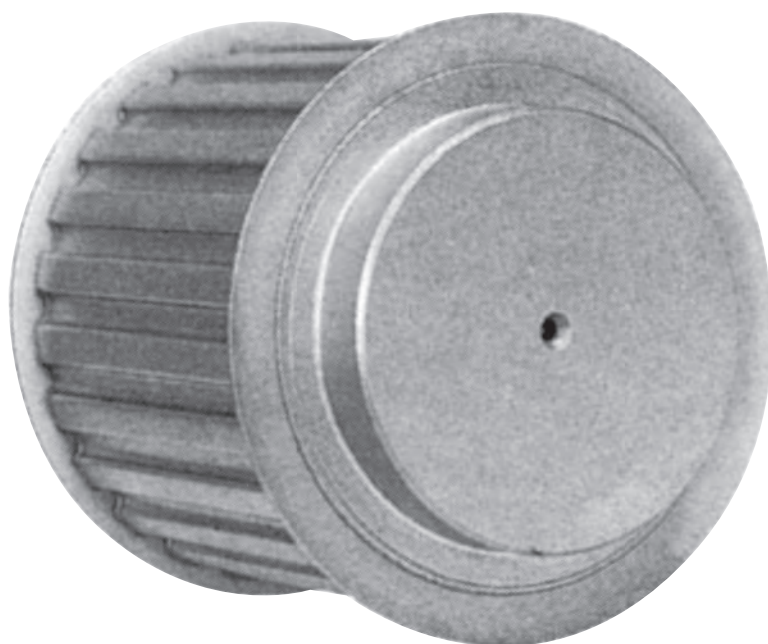

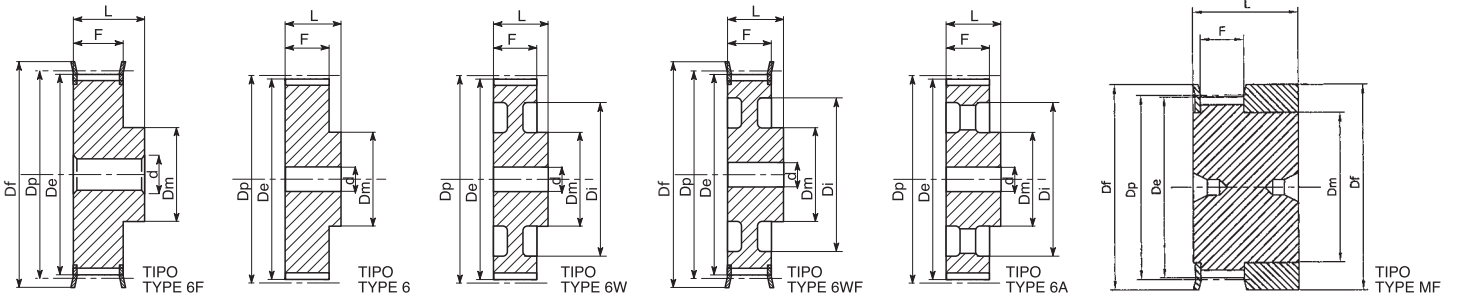

### MXL 025 - 0,080" (2,032 mm)

Caratteristiche Features Merkmale Características	Codice Code symbol Fabriknummer Code symbole Numero de fabrica	Nostro codice Our code Unser kode Notre code Nuestro codigo	Tipo Type Typ Type Tipo	Tipo flangia Flanges type Bordscheiben Typ Type flasques Tipo tapetas	N. denti N. of teeth Zahnezahl N. bre de dents Cantidad de dientes	Dp	De	Df	Dm	Di	F	L	Foro stock Stock bore Vor bohrung Alesage en stock Agujero de stock	Peso Weight Gewicht Poids Peso Kg
Alluminio / Aluminium / Aluminum / Aluminium / Aluminium / Aluminium / con flangia / with flanges / mit Flanges / avec flasques / con tapetas	<b>16 MXL 025</b>	<b>MXL 2516</b>	MF	F02	16	10,35	9,84	15,0	8,0	-	8,5	16	-	-
	<b>18 MXL 025</b>	<b>MXL 2518</b>	MF	F03	18	11,64	11,12	16,0	9,5	-	8,5	16	-	-
	<b>20 MXL 025</b>	<b>MXL 2520</b>	MF	F03	20	12,94	12,43	16,0	9,5	-	8,5	16	-	-
	<b>22 MXL 025</b>	<b>MXL 2522</b>	6F	F04	22	14,23	13,72	17,5	10,0	-	11,0	16	3	3
	<b>24 MXL 025</b>	<b>MXL 2524</b>	6F	F06	24	15,52	15,01	20,0	10,0	-	11,0	16	3	3
	<b>28 MXL 025</b>	<b>MXL 2528</b>	6F	F08	28	18,11	17,60	25,0	11,0	-	11,0	16	3	3
	<b>30 MXL 025</b>	<b>MXL 2530</b>	6F	F08	30	19,40	18,90	25,0	12,0	-	11,0	16	4	4
	<b>32 MXL 025</b>	<b>MXL 2532</b>	6F	F08	32	20,70	20,19	25,0	14,0	-	11,0	16	4	4
	<b>36 MXL 025</b>	<b>MXL 2536</b>	6F	F09	36	23,29	22,78	28,0	16,0	-	11,0	16	4	4
	<b>40 MXL 025</b>	<b>MXL 2540</b>	6F	F10	40	25,87	25,37	32,0	18,0	-	11,0	16	4	4
	<b>42 MXL 025</b>	<b>MXL 2542</b>	6F	F10	42	27,17	26,67	32,0	18,0	-	11,0	16	5	5
	<b>44 MXL 025</b>	<b>MXL 2544</b>	6F	F13	44	28,46	27,95	37,0	18,0	-	11,0	16	5	5
	Alluminio / Aluminium / Aluminium / Aluminium / Aluminium / Aluminium / senza flangia / without flanges / ohne Flanschen / sans flasques / sin tapetas	<b>48 MXL 025</b>	<b>MXL 2548</b>	6	-	48	31,05	30,54	-	20,0	-	11,0	16	5
<b>60 MXL 025</b>		<b>MXL 2560</b>	6	-	60	38,81	38,30	-	24,0	-	11,0	16	5	5
<b>72 MXL 025</b>		<b>MXL 2572</b>	6	-	72	46,57	46,06	-	25,0	-	11,0	16	6	6

### XL 037 - 1/5" (5,08 mm)

Caratteristiche Features Merkmale Características	Codice Code symbol Fabriknummer Code symbole Numero de fabrica	Nostro codice Our code Unser kode Notre code Nuestro codigo	Tipo Type Typ Type Tipo	Tipo flangia Flanges type Bordscheiben Typ Type flasques Tipo tapetas	N. denti N. of teeth Zahnezahl N. bre de dents Cantidad de dientes	Dp	De	Df	Dm	Di	F	L	Foro stock Stock bore Vor bohrung Alesage en stock Agujero de stock	Peso Weight Gewicht Poids Peso Kg
Alluminio / Aluminium / Aluminium / Aluminium / Aluminium / Aluminium / con flangia / with flanges / mit Flanges / avec flasques / con tapetas	<b>10 XL 037</b>	<b>XA37010 XC37010</b>	6F	F07	10	16,17	15,66	23	9,5	-	14,3	20	4	0,02
	<b>11 XL 037</b>	<b>XA37011 XC37011</b>	6F	F07	11	17,79	17,28	23	9,5	-	14,3	20	4	0,02
	<b>12 XL 037</b>	<b>XA37012 XC37012</b>	6F	F08	12	19,40	18,90	25	10	-	14,3	20	4	0,03
	<b>13 XL 037</b>	<b>XA37013 XC37013</b>	6F	F08	13	21,02	20,51	25	10	-	14,3	20	4	0,04
	<b>14 XL 037</b>	<b>XA37014 XC37014</b>	6F	F09	14	22,64	22,13	28	15	-	14,3	20	4	0,05
	<b>15 XL 037</b>	<b>XA37015 XC37015</b>	6F	F09	15	24,26	23,75	28	15	-	14,3	20	6	0,05
	<b>16 XL 037</b>	<b>XA37016 XC37016</b>	6F	F10	16	25,87	25,36	32	16	-	14,3	20	6	0,06
	<b>17 XL 037</b>	<b>XA37017 XC37017</b>	6F	F10	17	27,49	26,98	32	20	-	14,3	20	6	0,07
	<b>18 XL 037</b>	<b>XA37018 XC37018</b>	6F	F11	18	29,11	28,60	35	20	-	14,3	20	6	0,08
	<b>19 XL 037</b>	<b>XA37019 XC37019</b>	6F	F11	19	30,72	30,22	35	20	-	14,3	22	6	0,09
	<b>20 XL 037</b>	<b>XA37020 XC37020</b>	6F	F14	20	32,34	31,83	38	23,5	-	14,3	22	6	0,11
	<b>21 XL 037</b>	<b>XA37021 XC37021</b>	6F	F14	21	33,96	33,45	38	23,5	-	14,3	22	6	0,12
	<b>22 XL 037</b>	<b>XA37022 XC37022</b>	6F	F15	22	35,57	35,07	42	25	-	14,3	22	6	0,13
	<b>24 XL 037</b>	<b>XA37024 XC37024</b>	6F	F17	24	38,81	38,30	44	30	-	14,3	22	6	0,15
	<b>26 XL 037</b>	<b>XA37026 XC37026</b>	6F	F18	26	42,04	41,53	48	30	-	14,3	22	8	0,19
	<b>27 XL 037</b>	<b>XA37027 XC37027</b>	6F	F18	27	43,66	43,15	48	34	-	14,3	22	8	0,20
	<b>28 XL 037</b>	<b>XA37028 XC37028</b>	6F	F19	28	45,28	44,77	51	34	-	14,3	22	8	0,22
	<b>29 XL 037</b>	<b>XA37029 XC37029</b>	6F	F19	29	46,89	46,39	51	34	-	14,3	22	8	0,22
	<b>30 XL 037</b>	<b>XA37030 XC37030</b>	6F	F20	30	48,51	48,00	54	38	-	14,3	22	8	0,11
	<b>32 XL 037</b>	<b>XA37032 XC37032</b>	6F	F21	32	51,74	51,24	57	38	-	14,3	25	8	0,12
	Altern. / Altern. / Altern. / Altern. / Altern. / Altern. / senza flangia / without flanges / ohne Flanschen / sans flasques / sin tapetas	<b>34 XL 037</b>	<b>XA37034 XC37034</b>	6		34	54,98	54,47	-	45	-	14,3	25	8
<b>35 XL 037</b>		<b>XA37035 XC37035</b>	6		35	56,60	56,09	-	45	-	14,3	25	8	0,13
<b>36 XL 037</b>		<b>XA37036 XC37036</b>	6		36	58,21	57,70	-	45	-	14,3	25	8	0,14
<b>38 XL 037</b>		<b>XA37038 XC37038</b>	6		38	61,45	60,94	-	45	-	14,3	25	8	0,16
<b>39 XL 037</b>		<b>XA37039 XC37039</b>	6		39	63,06	62,56	-	45	-	14,3	25	8	0,17
<b>40 XL 037</b>		<b>XA37040 XC37040</b>	6		40	64,68	64,17	-	45	-	14,3	25	8	0,17
<b>41 XL 037</b>		<b>XA37041 XC37041</b>	6		41	66,30	65,79	-	45	-	14,3	25	8	0,18
<b>42 XL 037</b>		<b>XA37042 XC37042</b>	6		42	67,91	67,41	-	45	-	14,3	25	8	0,18
<b>43 XL 037</b>		<b>XA37043 XC37043</b>	6		43	69,53	69,02	-	45	-	14,3	25	8	0,19
<b>44 XL 037</b>		<b>XA37044 XC37044</b>	6		44	71,15	70,64	-	45	-	14,3	25	8	0,19
<b>45 XL 037</b>		<b>XA37045 XC37045</b>	6W		45	72,77	72,26	-	45	61	14,3	25	10	0,19
<b>46 XL 037</b>		<b>XA37046 XC37046</b>	6W		46	74,38	73,87	-	45	61	14,3	25	10	0,19
<b>47 XL 037</b>		<b>XA37047 XC37047</b>	6W		47	76,00	75,49	-	45	61	14,3	25	10	0,19
<b>48 XL 037</b>		<b>XA37048 XC37048</b>	6W		48	77,62	77,11	-	45	61	14,3	25	10	0,19
<b>49 XL 037</b>		<b>XA37049 XC37049</b>	6W		49	79,23	78,73	-	45	61	14,3	25	10	0,22
<b>52 XL 037</b>		<b>XA37052 XC37052</b>	6W		52	84,08	83,58	-	45	67	14,3	25	10	0,22
<b>56 XL 037</b>		<b>XA37056 XC37056</b>	6W		56	90,55	90,04	-	45	80	14,3	25	10	0,25
<b>57 XL 037</b>		<b>XA37057 XC37057</b>	6W		57	92,17	91,66	-	45	80	14,3	25	10	0,25
<b>58 XL 037</b>		<b>XA37058 XC37058</b>	6W		58	93,79	93,28	-	45	80	14,3	25	10	0,25
<b>59 XL 037</b>		<b>XA37059 XC37059</b>	6W		59	95,40	94,90	-	45	80	14,3	25	10	0,25
<b>60 XL 037</b>		<b>XA37060 XC37060</b>	6W		60	97,02	96,51	-	45	80	14,3	25	10	0,25
<b>68 XL 037</b>	<b>XA37068 XC37068</b>	6W		68	109,96	109,45	-	45	100	14,3	25	10	0,30	
<b>69 XL 037</b>	<b>XA37069 XC37069</b>	6W		69	111,57	111,07	-	45	100	14,3	25	10	0,30	
<b>70 XL 037</b>	<b>XA37070 XC37070</b>	6W		70	113,19	112,68	-	45	100	14,3	25	10	0,30	
<b>71 XL 037</b>	<b>XA37071 XC37071</b>	6W		71	114,81	114,30	-	45	100	14,3	25	10	0,30	
<b>72 XL 037</b>	<b>XA37072 XC37072</b>	6W		72	116,42	115,92	-	45	100	14,3	25	10	0,30	

# Pulegge per cinghie dentate / Timing belt pulleys Zahnriemenscheiben / Poulies pour courroies dentées / Poleas para correas dentadas



## L 050 - 3/8" (9,525 mm)

Caratteristiche Features Merkmale Características Características	Codice Code symbol Fabriknummer Code symbole Numero de fabrica	Nostro codice Our code Unser kode Notre code Nuestro codigo	Tipo Type Typ Type Tipo	Tipo flangia Flanges type Bordscheiben Typ Type flasques Tipo tapetas	N. denti N. of teeth Zahnezahl N. bre de dents Cantidad de dientes	Dp	De	Df	Dm	Di	F	L	Foro stock Stock bore Vor bohrung Alesage en stock Agujero de stock	Peso Weight / Gewicht Poids / Peso Kg			
Acciaio / Steel / Stahl Acier / Acero	con flangia / with flanges mit Flanges / avec flasques / con tapetas	10L050	L050010	6F	F13	10	30,32	29,56	37	20	—	19,0	28	8	0,11		
		11L050	L050011	6F	F13	11	33,35	32,59	37	22	—	19,0	30	8	0,14		
		12L050	L050012	6F	F16	12	36,38	35,62	43	24	—	19,0	30	8	0,17		
		13L050	L050013	6F	F17	13	39,41	38,65	44	28	—	19,0	30	8	0,18		
		14L050	L050014	6F	F18	14	42,45	41,68	48	28	—	19,0	30	8	0,22		
		15L050	L050015	6F	F19	15	45,48	44,72	51	34	—	19,0	30	8	0,28		
		16L050	L050016	6F	F20	16	48,51	47,75	54	36	—	19,0	32	8	0,35		
		17L050	L050017	6F	F21	17	51,54	50,78	57	36	—	19,0	32	10	0,36		
		18L050	L050018	6F	F22	18	54,57	53,81	60	40	—	19,0	32	10	0,42		
		19L050	L050019	6F	F24	19	57,61	56,84	64	40	—	19,0	32	10	0,45		
		20L050	L050020	6F	F25	20	60,64	59,88	66	40	—	19,0	32	10	0,48		
		21L050	L050021	6F	F26	21	63,67	62,91	70	45	—	19,0	32	10	0,57		
		22L050	L050022	6F	F27	22	66,70	65,94	75	45	—	19,0	32	10	0,59		
		23L050	L050023	6F	F28	23	69,73	68,97	79	55	—	19,0	32	10	0,61		
		24L050	L050024	6F	F28	24	72,77	72,00	79	55	—	19,0	32	10	0,80		
		25L050	L050025	6F	F29	25	75,80	75,04	83	58	—	19,0	32	10	0,85		
		26L050	L050026	6F	F30	26	78,83	78,07	87	58	—	19,0	32	11	0,90		
		27L050	L050027	6F	F30	27	81,86	81,10	87	58	—	19,0	32	11	0,91		
		28L050	L050028	6F	F31	28	84,89	84,13	91	58	—	19,0	32	11	0,95		
		29L050	L050029	6F	F32	29	87,93	87,16	93	58	—	19,0	32	11	1,00		
		30L050	L050030	6F	F33	30	90,96	90,20	97	70	—	19,0	32	11	1,07		
		32L050	L050032	6F	F34	32	97,02	96,26	102	70	—	19,0	32	11	1,23		
		Ghisa / Cast iron / Grauguss Fonte / Hierro fundido	senza flangia / without flanges ohne Flanschen / sans flasques sin tapetas	33L050	L050033	6F	F35	33	100,05	99,29	106	70	—	19,0	32	11	1,30
				34L050	L050034	6F	F36	34	103,08	102,32	112	70	—	19,0	32	11	1,37
				35L050	L050035	6F	F36	35	106,12	105,35	112	70	—	19,0	32	11	1,44
				36L050	L050036	6F	F37	36	109,15	108,39	115	70	—	19,0	32	11	1,50
				40L050	L050040	6WF	F40	40	121,28	120,51	128	70	100	19,0	32	11	1,77
				41L050	L050041	6WF	F41	41	124,31	123,55	131	70	103	19,0	32	11	1,84
				42L050	L050042	6WF	F42	42	127,34	126,58	135	70	106	19,0	32	11	1,97
				44L050	L050044	6WF	F45	44	133,40	132,64	142	70	112	19,0	32	11	2,20
				45L050	L050045	6WF	F45	45	136,44	135,67	142	70	115	19,0	32	11	2,27
				47L050	L050047	6WF	F48	47	142,50	141,74	150	70	121	19,0	32	11	2,45
				48L050	L050048	6WF	F48	48	145,53	144,77	150	70	124	19,0	32	11	2,67
				49L050	L050049	6W		49	148,56	147,80	—	70	127	19,0	32	14	1,80
				50L050	L050050	6W		50	151,60	150,83	—	70	130	19,0	32	14	1,90
				52L050	L050052	6W		52	157,66	156,90	—	70	136	19,0	32	14	2,10
56L050	L050056			6W		56	169,79	169,02	—	70	149	19,0	32	14	2,18		
57L050	L050057			6W		57	172,82	172,06	—	70	152	19,0	32	14	2,47		
60L050	L050060			6W		60	181,91	181,15	—	75	160	19,0	42	14	3,10		
65L050	L050065			6A		65	197,07	196,31	—	75	176	19,0	42	14	3,20		
66L050	L050066			6A		66	200,11	199,34	—	75	179	19,0	42	14	3,23		
72L050	L050072			6A		72	218,30	217,53	—	75	197	19,0	42	14	4,86		
84L050	L050084			6A		84	254,68	253,92	—	75	233	19,0	42	14	5,00		
90L050	L050090			6A		90	272,87	272,11	—	75	252	19,0	42	14	5,50		
96L050	L050096			6A		96	291,06	290,30	—	75	269	19,0	42	14	6,00		
120L050	L050120			6A		120	363,83	363,07	—	75	342	19,0	42	14	8,50		

## L 075 - 3/8" (9,525 mm)

Caratteristiche Features Merkmale Características Características	Codice Code symbol Fabriknummer Code symbole Numero de fabrica	Nostro codice Our code Unser kode Notre code Nuestro codigo	Tipo Type Typ Type Tipo	Tipo flangia Flanges type Bordscheiben Typ Type flasques Tipo tapetas	N. denti N. of teeth Zahnezahl N. bre de dents Cantidad de dientes	Dp	De	Df	Dm	Di	F	L	Foro stock Stock bore Vor bohrung Alesage en stock Agujero de stock	Peso Weight / Gewicht Poids / Peso Kg			
Acciaio / Steel / Stahl Acier / Acero	con flangia / with flanges mit Flanges / avec flasques / con tapetas	10L075	L075010	6F	F13	10	30,32	29,56	37	20	—	25,4	38	8	0,15		
		11L075	L075011	6F	F13	11	33,35	32,59	37	22	—	25,4	38	8	0,17		
		12L075	L075012	6F	F16	12	36,38	35,62	43	24	—	25,4	38	8	0,22		
		13L075	L075013	6F	F17	13	39,41	38,65	44	28	—	25,4	38	8	0,25		
		14L075	L075014	6F	F18	14	42,45	41,68	48	28	—	25,4	38	11	0,28		
		15L075	L075015	6F	F19	15	45,48	44,72	51	34	—	25,4	38	11	0,38		
		16L075	L075016	6F	F20	16	48,51	47,75	54	36	—	25,4	38	11	0,43		
		17L075	L075017	6F	F21	17	51,54	50,78	57	36	—	25,4	38	11	0,44		
		18L075	L075018	6F	F22	18	54,57	53,81	60	40	—	25,4	38	11	0,52		
		19L075	L075019	6F	F24	19	57,61	56,84	64	40	—	25,4	38	11	0,56		
		20L075	L075020	6F	F25	20	60,64	59,88	66	40	—	25,4	38	11	0,59		
		21L075	L075021	6F	F26	21	63,67	62,91	70	45	—	25,4	38	11	0,64		
		22L075	L075022	6F	F27	22	66,70	65,94	75	45	—	25,4	38	11	0,69		
		23L075	L075023	6F	F28	23	69,73	68,97	79	55	—	25,4	38	11	0,76		
		24L075	L075024	6F	F28	24	72,77	72,00	79	55	—	25,4	38	11	0,87		
		25L075	L075025	6F	F29	25	75,80	75,04	83	58	—	25,4	38	11	0,95		
		26L075	L075026	6F	F30	26	78,83	78,07	87	58	—	25,4	38	11	1,06		
		27L075	L075027	6F	F30	27	81,86	81,10	87	58	—	25,4	38	11	1,18		
		28L075	L075028	6F	F31	28	84,89	84,13	91	58	—	25,4	38	11	1,19		
		29L075	L075029	6F	F32	29	87,93	87,16	93	58	—	25,4	38	11	1,25		
		30L075	L075030	6F	F33	30	90,96	90,20	97	70	—	25,4	38	11	1,33		
		32L075	L075032	6F	F34	32	97,02	96,26	102	70	—	25,4	38	11	1,54		
		Ghisa / Cast iron / Grauguss Fonte / Hierro fundido	senza flangia / without flanges ohne Flanschen / sans flasques / sin tapetas	33L075	L075033	6F	F35	33	100,05	99,29	106	70	—	25,4	38	11	1,63
				34L075	L075034	6F	F36	34	103,08	102,32	112	70	—	25,4	38	11	1,37
				35L075	L075035	6F	F36	35	106,12	105,35	112	70	—	25,4	38	11	1,80
				36L075	L075036	6F	F37	36	109,15	108,39	115	70	—	25,4	38	11	1,89
				40L075	L075040	6WF	F40	40	121,28	120,51	128	70	100	25,4	38	11	2,35
				41L075	L075041	6WF	F41	41	124,31	123,55	131	70	103	25,4	38	11	2,40
				42L075	L075042	6WF	F42	42	127,34	126,58	135	70	106	25,4	38	11	2,53
				44L075	L075044	6WF	F45	44	133,40	132,64	142	70	112	25,4	38	11	2,75
				45L075	L075045	6WF	F45	45	136,44	135,67	142	70	115	25,4	38	11	2,86
				47L075	L075047	6WF	F48	47	142,50	141,74	150	70	121	25,4	38	11	3,02
				48L075	L075048	6WF	F48	48	145,53	144,77	150	70	124	25,4	38	11	3,19
				49L075	L075049	6W		49	148,56	147,80	—	70	127	25,4	38	14	2,10
				50L075	L075050	6W		50	151,60	150,83	—	70	130	25,4	38	14	2,20
				52L075	L075052	6W		52	157,66	156,90	—	70	136	25,4	38	14	2,38
56L075	L075056			6W		56	169,79	169,02	—	70	149	25,4	38	14	2,49		
57L075	L075057			6W		57	172,82	172,06	—	70	152	25,4	38	14	2,73		
60L075	L075060			6W		60	181,91	181,15	—	75	160	25,4	45	14	3,44		
65L075	L075065			6A		65	197,07	196,31	—	75	176	25,4	45	14	3,50		
66L075	L075066			6A		66	200,11	199,34	—	75	179	25,4	45	14	3,60		
72L075	L075072			6A		72	218,30	217,53	—	75	197	25,4	45	14	4,58		
84L075	L075084			6A		84	254,68	253,92	—	75	233	25,4	45	14	5,60		
90L075	L075090			6A		90	272,87	272,11	—	75	252	25,4	45	14	6,50		
96L075	L075096			6A		96	291,06	290,30	—	75	269	25,4	45	14	7,00		
120L075	L075120			6A		120	363,83	363,07	—	75	342	25,4	45	14	10,00		

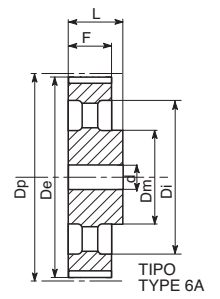
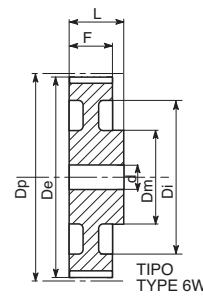
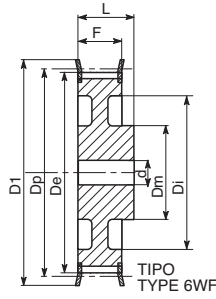
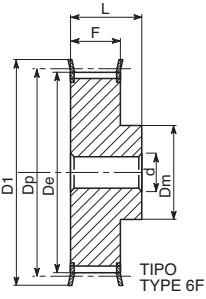

## L 100 - 3/8" (9,525 mm)

Caratteristiche Features Merkmale Características Características	Codice Code symbol Fabriknummer Code symbole Numero de fabrica	Nostro codice Our code Unser code Notre code Nuestro codigo	Tipo Type Typ Type Tipo	Tipo flangia Flanges type Bordscheiben Typ Type flasques Tipo tapetas	N. denti N. of teeth Zahnezahl N. bre de dents Cantidad de dientes	Dp	De	Df	Dm	Di	F	L	Foro stock Stock bore Vor bohrung Alesage en stock Agujero de stock	Peso Weight / Gewicht Poids / Peso Kg			
Acciaio / Steel / Stahl Acier / Acero	con flangia / with flanges mit Flanges / avec flasques / con tapetas	10L100	L100010	6F	F13	10	30,32	29,56	37	20	—	31,8	45	8	0,15		
		11L100	L100011	6F	F14	11	33,35	32,59	38	22	—	31,8	45	8	0,20		
		12L100	L100012	6F	F16	12	36,38	35,62	43	24	—	31,8	45	8	0,26		
		13L100	L100013	6F	F17	13	39,41	38,65	44	28	—	31,8	45	8	0,30		
		14L100	L100014	6F	F18	14	42,45	41,68	48	28	—	31,8	45	11	0,34		
		15L100	L100015	6F	F19	15	45,48	44,72	51	34	—	31,8	45	11	0,45		
		16L100	L100016	6F	F20	16	48,51	47,75	54	36	—	31,8	45	11	0,52		
		17L100	L100017	6F	F21	17	51,54	50,78	57	36	—	31,8	45	11	0,53		
		18L100	L100018	6F	F22	18	54,57	53,81	60	40	—	31,8	45	11	0,62		
		19L100	L100019	6F	F24	19	57,61	56,84	64	40	—	31,8	45	11	0,66		
		20L100	L100020	6F	F25	20	60,64	59,88	66	40	—	31,8	45	11	0,72		
		21L100	L100021	6F	F26	21	63,67	62,91	70	45	—	31,8	45	11	0,77		
		22L100	L100022	6F	F27	22	66,70	65,94	75	45	—	31,8	45	11	0,88		
		23L100	L100023	6F	F28	23	69,73	68,97	79	55	—	31,8	45	11	1,12		
		24L100	L100024	6F	F28	24	72,77	72,00	79	55	—	31,8	45	11	1,13		
		25L100	L100025	6F	F29	25	75,80	75,04	83	58	—	31,8	45	11	1,18		
		26L100	L100026	6F	F30	26	78,83	78,07	87	58	—	31,8	45	11	1,24		
		27L100	L100027	6F	F30	27	81,86	81,10	87	58	—	31,8	45	11	1,35		
		28L100	L100028	6F	F31	28	84,89	84,13	91	58	—	31,8	45	11	1,42		
		29L100	L100029	6F	F32	29	87,93	87,17	93	58	—	31,8	45	11	1,50		
		30L100	L100030	6F	F33	30	90,96	90,20	97	70	—	31,8	45	11	1,61		
		32L100	L100032	6F	F34	32	97,02	96,26	102	70	—	31,8	45	11	1,84		
		33L100	L100033	6F	F35	33	100,05	99,29	106	70	—	31,8	45	11	1,95		
		34L100	L100034	6F	F36	34	103,08	102,32	112	70	—	31,8	45	11	2,10		
		35L100	L100035	6F	F36	35	106,12	105,35	112	70	—	31,8	45	11	2,23		
		36L100	L100036	6F	F37	36	109,15	108,39	115	70	—	31,8	45	11	2,32		
		40L100	L100040	6WF	F40	40	121,28	120,51	128	70	100	31,8	45	11	2,80		
		41L100	L100041	6WF	F41	41	124,31	123,55	131	70	103	31,8	45	11	2,95		
		42L100	L100042	6WF	F42	42	127,34	126,58	135	70	106	31,8	45	11	3,10		
		44L100	L100044	6WF	F45	44	133,40	132,62	142	70	112	31,8	45	11	3,36		
		45L100	L100045	6WF	F45	45	136,44	135,67	142	70	115	31,8	45	11	3,45		
		47L100	L100047	6WF	F48	47	142,50	141,74	150	70	121	31,8	45	11	3,65		
		48L100	L100048	6WF	F48	48	145,53	144,77	150	70	124	31,8	45	11	3,86		
		Ghisa / Cast iron / Grauguss Fonte / Hierro fundido	senza flangia / without flanges ohne Flanschen / sans flasques sin tapetas	49L100	L100049	6W	F48	49	148,56	147,80	—	70	127	31,8	45	14	2,86
				50L100	L100050	6W	F50	50	151,60	150,83	—	70	130	31,8	45	14	2,50
				52L100	L100052	6W	F52	52	157,66	156,90	—	70	136	31,8	45	14	2,70
56L100	L100056			6W	F56	56	169,79	169,02	—	70	149	31,8	45	14	2,91		
57L100	L100057			6W	F57	57	172,82	172,06	—	70	152	31,8	45	14	3,10		
60L100	L100060			6W	F60	60	181,91	181,15	—	75	160	31,8	50	14	3,55		
65L100	L100065			6A	F65	65	197,07	196,31	—	75	176	31,8	50	14	4,00		
66L100	L100066			6A	F66	66	200,11	199,34	—	75	179	31,8	50	14	4,15		
72L100	L100072			6A	F72	72	218,30	217,53	—	75	197	31,8	50	14	5,00		
84L100	L100084			6A	F84	84	254,68	253,92	—	75	233	31,8	50	14	6,30		
90L100	L100090			6A	F90	90	272,87	272,11	—	75	252	31,8	50	14	7,50		
96L100	L100096			6A	F96	96	291,06	290,30	—	75	269	31,8	50	14	8,20		
120L100	L100120			6A	F120	120	363,83	363,07	—	75	342	31,8	50	14	11,50		

## H 075 - 1/2" (12,75 mm)

Caratteristiche Features Merkmale Características Características	Codice Code symbol Fabriknummer Code symbole Numero de fabrica	Nostro codice Our code Unser code Notre code Nuestro codigo	Tipo Type Typ Type Tipo	Tipo flangia Flanges type Bordscheiben Typ Type flasques Tipo tapetas	N. denti N. of teeth Zahnezahl N. bre de dents Cantidad de dientes	Dp	De	Df	Dm	Di	F	L	Foro stock Stock bore Vor bohrung Alesage en stock Agujero de stock	Peso Weight / Gewicht Poids / Peso Kg			
Acciaio / Steel / Stahl Acier / Acero	con flangia / with flanges mit Flanges / avec flasques / con tapetas	14H075	H075014	6F	F24	14	56,60	55,22	64	40	—	26,4	40	8	0,59		
		15H075	H075015	6F	F25	15	60,64	59,27	66	45	—	26,4	40	8	0,65		
		16H075	H075016	6F	F26	16	64,68	63,31	70	45	—	26,4	40	8	0,70		
		17H075	H075017	6F	F27	17	68,72	67,35	75	45	—	26,4	40	8	0,73		
		18H075	H075018	6F	F28	18	72,77	71,39	79	55	—	26,4	40	11	0,91		
		19H075	H075019	6F	F29	19	76,81	75,44	83	60	—	26,4	40	11	1,08		
		20H075	H075020	6F	F30	20	80,85	79,48	87	62	—	26,4	40	11	1,18		
		21H075	H075021	6F	F31	21	84,89	83,52	91	65	—	26,4	40	11	1,30		
		22H075	H075022	6F	F32	22	88,94	87,56	93	68	—	26,4	40	11	1,42		
		23H075	H075023	6F	F33	23	92,98	91,61	97	72	—	26,4	40	11	1,67		
		24H075	H075024	6F	F34	24	97,02	95,65	102	72	—	26,4	40	11	1,71		
		25H075	H075025	6F	F35	25	101,06	99,69	106	72	—	26,4	40	11	1,87		
		26H075	H075026	6F	F36	26	105,11	103,73	112	80	—	26,4	40	11	2,00		
		27H075	H075027	6F	F37	27	109,15	107,78	115	80	—	26,4	40	11	2,10		
		28H075	H075028	6F	F38	28	113,19	111,82	120	80	—	26,4	40	11	2,26		
		29H075	H075029	6F	F39	29	117,23	115,86	123	80	—	26,4	40	11	2,49		
		30H075	H075030	6F	F40	30	121,28	119,90	128	80	—	26,4	40	11	2,70		
		32H075	H075032	6F	F42	32	129,36	127,99	135	80	—	26,4	40	11	2,85		
		33H075	H075033	6F	F44	33	133,40	132,03	140	80	—	26,4	40	11	3,10		
		34H075	H075034	6F	F45	34	137,45	136,07	142	80	—	26,4	40	11	3,30		
		35H075	H075035	6F	F48	35	141,49	140,12	150	80	—	26,4	40	11	3,50		
		36H075	H075036	6WF	F48	36	145,53	144,16	150	80	118	26,4	40	11	3,65		
		38H075	H075038	6WF	F50	38	153,62	152,24	158	80	126	26,4	40	11	3,90		
		40H075	H075040	6WF	F52	40	161,70	160,33	168	80	134	26,4	40	11	4,23		
		42H075	H075042	6WF	F53	42	169,79	168,41	175	80	140	26,4	40	11	4,80		
		44H075	H075044	6WF	F55	44	177,87	176,50	184	80	150	26,4	40	14	5,20		
		45H075	H075045	6WF	F57	45	181,91	180,54	192	80	154	26,4	40	14	5,45		
		48H075	H075048	6WF	F59	48	194,04	192,67	200	90	166	26,4	45	14	4,30		
		Ghisa / Cast iron / Grauguss Fonte / Hierro fundido	senza flangia / without flanges ohne Flanschen / sans flasques / sin tapetas	49H075	H075049	6W	F49	49	198,08	196,71	—	90	170	26,4	45	14	4,50
				50H075	H075050	6W	F50	50	202,13	200,75	—	90	174	26,4	45	14	4,66



# Pulegge per cinghie dentate / Timing belt pulleys

# Zahnriemenscheiben / Poulies pour courroies dentées / Poleas para correas dentadas



## H 100 - 1/2" (12,75 mm)

Caratteristiche Features Merkmale Características Características	Codice Code symbol Fabriknummer Code symbole Numero de fabrica	Nostro codice Our code Unser kode Notre code Nuestro codigo	Tipo Type Typ Type Tipo	Tipo flangia Flanges type Bordscheiben Typ Type flasques Tipo tapetas	N. denti N. of teeth Zahnezahl N. bre de dents Cantidad de dientes	Dp	De	Df	Dm	Di	F	L	Foro stock Stock bore Vor bohrung Alesage en stock Agujero de stock	Peso Weight / Gewicht Poids / Peso Kg		
Acciaio / Steel / Stahl Acier / Acero	14H100	H100014	6F	F24	14	56,60	55,22	64	45	—	31,8	45	11	0,67		
	15H100	H100015	6F	F25	15	60,64	59,27	66	45	—	31,8	45	11	0,77		
	16H100	H100016	6F	F26	16	64,68	63,31	70	45	—	31,8	45	11	0,88		
	17H100	H100017	6F	F27	17	68,72	67,35	75	45	—	31,8	45	11	0,88		
	18H100	H100018	6F	F28	18	72,77	71,39	79	55	—	31,8	45	14	1,06		
	19H100	H100019	6F	F29	19	76,81	75,44	83	60	—	31,8	45	14	1,23		
	20H100	H100020	6F	F30	20	80,85	79,48	87	62	—	31,8	45	14	1,33		
	21H100	H100021	6F	F31	21	84,89	83,52	91	65	—	31,8	45	14	1,43		
	22H100	H100022	6F	F32	22	88,94	87,56	93	68	—	31,8	45	14	1,63		
	23H100	H100023	6F	F33	23	92,98	91,61	97	72	—	31,8	45	14	1,85		
	24H100	H100024	6F	F34	24	97,02	95,65	102	72	—	31,8	45	14	1,93		
	Ghisa / Cast iron / Grauguss Fonte / Hierro fundido	25H100	H100025	6F	F35	25	101,06	99,69	106	72	—	31,8	45	14	2,07	
		26H100	H100026	6F	F36	26	105,11	103,73	112	80	—	31,8	45	14	2,30	
		27H100	H100027	6F	F37	27	109,15	107,78	115	80	—	31,8	45	14	2,40	
		28H100	H100028	6F	F38	28	113,19	111,82	120	80	—	31,8	45	14	2,53	
		29H100	H100029	6F	F39	29	117,23	115,86	123	80	—	31,8	45	14	2,70	
		30H100	H100030	6F	F40	30	121,28	119,90	128	80	—	31,8	45	14	2,93	
		32H100	H100032	6F	F42	32	129,36	127,99	135	80	—	31,8	45	14	3,06	
		33H100	H100033	6F	F44	33	133,40	132,03	140	80	—	31,8	45	14	3,40	
		34H100	H100034	6F	F45	34	137,45	136,07	142	80	—	31,8	45	14	3,57	
		35H100	H100035	6F	F48	35	141,49	140,12	150	80	—	31,8	45	14	3,80	
		36H100	H100036	6WF	F48	36	145,53	144,16	150	80	118	31,8	45	14	3,92	
		38H100	H100038	6WF	F50	38	153,62	152,24	158	80	123	31,8	45	14	4,40	
		40H100	H100040	6WF	F52	40	161,70	160,33	168	80	134	31,8	45	14	4,95	
		42H100	H100042	6WF	F53	42	169,79	168,41	175	80	140	31,8	45	14	5,60	
		Ghisa / Cast iron / Grauguss Fonte / Hierro fundido	44H100	H100044	6WF	F55	44	177,87	176,50	184	80	150	31,8	50	19	6,20
			45H100	H100045	6WF	F57	45	181,91	180,54	192	80	154	31,8	50	19	6,45
			48H100	H100048	6WF	F59	48	194,04	192,67	200	90	166	31,8	50	19	5,30
			49H100	H100049	6W		49	198,08	196,71	—	90	170	31,8	50	19	5,40
			50H100	H100050	6W		50	202,13	200,75	—	90	174	31,8	50	19	5,50
			52H100	H100052	6W		52	210,21	208,84	—	90	182	31,8	50	19	5,80
			58H100	H100058	6A		58	234,47	233,09	—	90	207	31,8	50	19	6,20
			60H100	H100060	6A		60	242,55	241,18	—	90	215	31,8	50	19	7,50
			70H100	H100070	6A		70	282,98	281,61	—	100	255	31,8	55	19	8,20
			72H100	H100072	6A		72	291,06	289,69	—	100	263	31,8	55	19	9,00
82H100			H100082	6A		82	331,49	330,12	—	100	304	31,8	55	19	9,20	
84H100			H100084	6A		84	339,57	338,20	—	100	312	31,8	55	19	10,00	
94H100			H100094	6A		94	380,00	378,63	—	120	352	31,8	60	19	13,00	
96H100			H100096	6A		96	388,08	386,71	—	120	360	31,8	60	19	13,80	
106H100			H100106	6A		106	428,51	427,14	—	120	401	31,8	60	19	15,50	
116H100			H100116	6A		116	468,93	467,56	—	120	441	31,8	60	19	18,00	
118H100			H100118	6A		118	477,02	475,65	—	120	449	31,8	60	19	20,00	
120H100			H100120	6A		120	485,10	483,73	—	120	458	31,8	60	19	22,00	
150H100			H100150	6A		150	606,38	605,01	—	120	579	31,8	60	19	25,00	
152H100			H100152	6A		152	614,47	613,09	—	120	587	31,8	60	19	26,00	
154H100			H100154	6A		154	622,55	621,18	—	120	595	31,8	60	19	27,00	
156H100	H100156		6A		156	630,64	629,26	—	120	603	31,8	60	19	28,00		

## H 150 - 1/2" (12,75 mm)

Caratteristiche Features Merkmale Características Características	Codice Code symbol Fabriknummer Code symbole Numero de fabrica	Nostro codice Our code Unser kode Notre code Nuestro codigo	Tipo Type Typ Type Tipo	Tipo flangia Flanges type Bordscheiben Typ Type flasques Tipo tapetas	N. denti N. of teeth Zahnezahl N. bre de dents Cantidad de dientes	Dp	De	Df	Dm	Di	F	L	Foro stock Stock bore Vor bohrung Alesage en stock Agujero de stock	Peso Weight / Gewicht Poids / Peso Kg		
Acciaio / Steel / Stahl Acier / Acero	14H150	H150014	6F	F24	14	56,60	55,22	64	42	—	46,0	58	11	0,91		
	15H150	H150015	6F	F25	15	60,64	59,27	66	45	—	46,0	58	11	0,99		
	16H150	H150016	6F	F26	16	64,68	63,31	70	45	—	46,0	58	11	1,08		
	17H150	H150017	6F	F27	17	68,72	67,35	75	45	—	46,0	58	11	1,15		
	18H150	H150018	6F	F28	18	72,77	71,39	79	55	—	46,0	58	14	1,45		
	19H150	H150019	6F	F29	19	76,81	75,44	83	60	—	46,0	58	14	1,55		
	20H150	H150020	6F	F30	20	80,85	79,48	87	62	—	46,0	58	14	1,66		
	21H150	H150021	6F	F31	21	84,89	83,52	91	65	—	46,0	58	14	1,87		
	22H150	H150022	6F	F32	22	88,94	87,56	93	68	—	46,0	58	14	2,07		
	23H150	H150023	6F	F33	23	92,98	91,61	97	72	—	46,0	58	14	2,28		
	24H150	H150024	6F	F34	24	97,02	95,65	102	72	—	46,0	58	14	2,50		
	Ghisa / Cast iron / Grauguss Fonte / Hierro fundido	25H150	H150025	6F	F35	25	101,06	99,69	106	72	—	46,0	58	14	2,71	
		26H150	H150026	6F	F36	26	105,11	103,73	112	80	—	46,0	58	14	2,99	
		27H150	H150027	6F	F37	27	109,15	107,78	115	80	—	46,0	58	14	3,15	
		28H150	H150028	6F	F38	28	113,19	111,82	120	80	—	46,0	58	14	3,39	
		29H150	H150029	6F	F39	29	117,23	115,86	123	80	—	46,0	58	14	3,57	
		30H150	H150030	6F	F40	30	121,28	119,90	128	80	—	46,0	58	14	3,86	
		32H150	H150032	6F	F42	32	129,36	127,99	135	80	—	46,0	58	14	4,37	
		33H150	H150033	6F	F44	33	133,40	132,03	140	80	—	46,0	58	14	4,66	
		34H150	H150034	6F	F45	34	137,45	136,07	142	80	—	46,0	58	14	4,98	
		35H150	H150035	6F	F48	35	141,49	140,12	150	80	—	46,0	58	14	5,30	
		36H150	H150036	6WF	F48	36	145,53	144,16	150	80	118	46,0	58	14	5,50	
		38H150	H150038	6WF	F50	38	153,62	152,24	158	80	126	46,0	58	14	6,10	
		40H150	H150040	6WF	F52	40	161,70	160,33	168	80	134	46,0	58	14	6,80	
		42H150	H150042	6WF	F53	42	169,79	168,41	175	80	140	46,0	58	19	7,60	
		Ghisa / Cast iron / Grauguss Fonte / Hierro fundido	44H150	H150044	6WF	F55	44	177,87	176,50	184	80	150	46,0	58	19	8,50
			45H150	H150045	6WF	F57	45	181,91	180,54	192	80	154	46,0	58	19	9,00
			48H150	H150048	6WF	F59	48	194,04	192,67	200	90	166	46,0	65	19	6,70
			49H150	H150049	6W		49	198,08	196,71	—	90	170	46,0	65	19	7,00
			50H150	H150050	6W		50	202,13	200,75	—	90	174	46,0	65	19	7,10
			52H150	H150052	6W		52	210,21	208,84	—	90	182	46,0	65	19	7,30
			58H150	H150058	6A		58	234,47	233,09	—	90	207	46,0	65	19	8,10
			60H150	H150060	6A		60	242,55	241,18	—	90	215	46,0	65	19	9,00
			70H150	H150070	6A		70	282,98	281,61	—	100	255	46,0	65	24	10,50
			72H150	H150072	6A		72	291,06	289,69	—	100	263	46,0	65	24	11,00

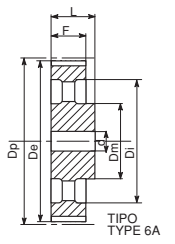
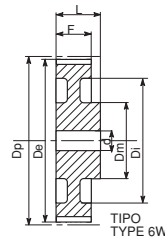
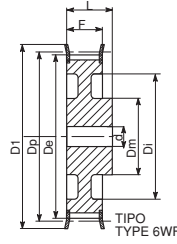
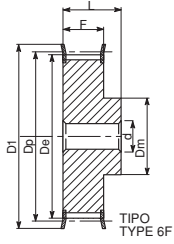

### H 200 - 1/2" (12,75 mm)

Caratteristiche Features Merkmal Características	Codice Code symbol Fabriknummer Code symbole Numero de fabrica	Nostro codice Our code Unser kode Notre code Nuestro codigo	Tipo Type Typ Type Tipo	Tipo flangia Flanges type Bordscheiben Typ Type flasques Tipo tapetas	N. denti N. of teeth Zahnezahl N. bre de dents Cantidad de dientes	Dp	De	Df	Dm	Di	F	L	Foro stock Stock bore Vor bohrung Alesage en stock Agujero de stock	Peso Weight / Gewicht Poids / Peso Kg			
Acciaio / Steel / Stahl Acier / Acero	con flangia / with flanges mit Flanges / avec flasques / con tapetas	14H200	H200014	6F	F24	14	56,60	55,22	64	42	—	58,7	70	11	1,13		
		15H200	H200015	6F	F25	15	60,64	59,27	66	45	—	58,7	70	11	1,21		
		16H200	H200016	6F	F26	16	64,68	63,31	70	45	—	58,7	70	11	1,30		
		17H200	H200017	6F	F27	17	68,72	67,35	75	45	—	58,7	70	11	1,45		
		18H200	H200018	6F	F28	18	72,77	71,39	79	55	—	58,7	70	14	1,65		
		19H200	H200019	6F	F29	19	76,81	75,44	83	60	—	58,7	70	14	1,90		
		20H200	H200020	6F	F30	20	80,85	79,48	87	62	—	58,7	70	14	2,11		
		21H200	H200021	6F	F31	21	84,89	83,52	91	65	—	58,7	70	14	2,23		
		22H200	H200022	6F	F32	22	88,94	87,56	93	68	—	58,7	70	14	2,45		
		23H200	H200023	6F	F33	23	92,98	91,61	97	72	—	58,7	70	14	2,71		
		24H200	H200024	6F	F34	24	97,02	95,65	102	72	—	58,7	70	14	2,97		
		25H200	H200025	6F	F35	25	101,06	99,69	106	72	—	58,7	70	14	3,32		
		26H200	H200026	6F	F36	26	105,11	103,73	112	80	—	58,7	70	14	3,61		
		27H200	H200027	6F	F37	27	109,15	107,78	115	80	—	58,7	70	14	3,90		
		28H200	H200028	6F	F38	28	113,19	111,82	120	80	—	58,7	70	14	4,10		
		29H200	H200029	6F	F39	29	117,23	115,86	123	80	—	58,7	70	14	4,42		
		30H200	H200030	6F	F40	30	121,28	119,90	128	80	—	58,7	70	14	4,74		
		32H200	H200032	6F	F42	32	129,36	127,99	135	80	—	58,7	70	14	5,60		
		33H200	H200033	6F	F44	33	133,40	132,03	140	80	—	58,7	70	14	5,90		
		34H200	H200034	6F	F45	34	137,45	136,07	142	80	—	58,7	70	14	6,20		
		35H200	H200035	6F	F48	35	141,49	140,12	150	80	—	58,7	70	14	6,60		
		36H200	H200036	6WF	F48	36	145,53	144,16	150	80	118	58,7	70	14	7,10		
		38H200	H200038	6WF	F50	38	153,62	152,24	158	80	126	58,7	70	14	8,40		
		40H200	H200040	6WF	F52	40	161,70	160,33	168	80	134	58,7	70	14	7,80		
		42H200	H200042	6WF	F53	42	169,79	168,41	180	80	140	58,7	70	19	9,70		
		44H200	H200044	6WF	F55	44	177,87	176,50	184	80	150	58,7	70	19	10,50		
		45H200	H200045	6WF	F57	45	181,91	180,54	192	80	154	58,7	70	19	11,30		
		48H200	H200048	6WF	F59	48	194,04	192,67	200	90	166	58,7	75	24	8,60		
		Ghisa / Cast iron / Grauguss Fonte / Hierro fundido	senza flangia / without flanges ohne Flanschen / sans flasques / sin tapetas	49H200	H200049	6W	F49	49	198,08	196,71	—	90	170	58,7	75	24	7,60
				50H200	H200050	6W	F50	50	202,13	200,75	—	90	174	58,7	75	24	8,30
				52H200	H200052	6W	F52	52	210,21	208,84	—	90	182	58,7	75	24	8,50
				58H200	H200058	6A	F58	58	234,47	233,09	—	90	207	58,7	75	24	10,00
				60H200	H200060	6A	F60	60	242,55	241,18	—	90	215	58,7	75	24	11,00
				70H200	H200070	6A	F70	70	282,98	281,61	—	100	255	58,7	75	28	12,50
				72H200	H200072	6A	F72	72	291,06	289,69	—	100	263	58,7	75	28	14,00
82H200	H200082			6A	F82	82	331,49	330,12	—	100	304	58,7	75	28	13,50		
84H200	H200084			6A	F84	84	339,57	338,20	—	100	312	58,7	75	28	15,00		
94H200	H200094			6A	F94	94	380,00	378,63	—	120	352	58,7	75	28	18,90		
96H200	H200096			6A	F96	96	388,08	386,71	—	120	360	58,7	75	28	20,30		
106H200	H200106			6A	F106	106	428,51	427,14	—	120	401	58,7	75	28	22,50		
116H200	H200116			6A	F116	116	468,93	467,56	—	120	441	58,7	75	28	24,70		
118H200	H200118			6A	F118	118	477,02	475,65	—	120	449	58,7	75	28	26,00		
120H200	H200120			6A	F120	120	485,10	483,73	—	120	458	58,7	75	28	28,00		
150H200	H200150			6A	F150	150	606,38	605,01	—	120	579	58,7	75	28	32,50		
152H200	H200152			6A	F152	152	614,47	613,09	—	120	587	58,7	75	28	35,00		
154H200	H200154			6A	F154	154	622,55	621,18	—	120	595	58,7	75	28	38,00		
156H200	H200156			6A	F156	156	630,64	629,26	—	120	603	58,7	75	28	41,00		

### H 300 - 1/2" (12,75 mm)

Caratteristiche Features Merkmal Características	Codice Code symbol Fabriknummer Code symbole Numero de fabrica	Nostro codice Our code Unser kode Notre code Nuestro codigo	Tipo Type Typ Type Tipo	Tipo flangia Flanges type Bordscheiben Typ Type flasques Tipo tapetas	N. denti N. of teeth Zahnezahl N. bre de dents Cantidad de dientes	Dp	De	Df	Dm	Di	F	L	Foro stock Stock bore Vor bohrung Alesage en stock Agujero de stock	Peso Weight / Gewicht Poids / Peso Kg			
Acciaio / Steel / Stahl Acier / Acero	con flangia / with flanges mit Flanges / avec flasques / con tapetas	14H300	H300014	6F	F24	14	56,60	55,22	64	42	—	85,7	100	11	1,35		
		15H300	H300015	6F	F25	15	60,64	59,27	66	45	—	85,7	100	11	1,55		
		16H300	H300016	6F	F26	16	64,68	63,31	70	45	—	85,7	100	11	1,80		
		17H300	H300017	6F	F27	17	68,72	67,35	75	45	—	85,7	100	11	2,10		
		18H300	H300018	6F	F28	18	72,77	71,39	79	55	—	85,7	100	19	2,38		
		19H300	H300019	6F	F29	19	76,81	75,44	83	60	—	85,7	100	19	2,64		
		20H300	H300020	6F	F30	20	80,85	79,48	87	62	—	85,7	100	19	3,10		
		21H300	H300021	6F	F31	21	84,89	83,52	91	65	—	85,7	100	19	3,32		
		22H300	H300022	6F	F32	22	88,94	87,56	93	68	—	85,7	100	19	3,67		
		23H300	H300023	6F	F33	23	92,98	91,61	97	72	—	85,7	100	19	4,00		
		24H300	H300024	6F	F34	24	97,02	95,65	102	72	—	85,7	100	19	4,40		
		25H300	H300025	6F	F35	25	101,06	99,69	106	72	—	85,7	100	19	4,79		
		26H300	H300026	6F	F36	26	105,11	103,73	112	80	—	85,7	100	19	5,20		
		27H300	H300027	6F	F37	27	109,15	107,78	115	80	—	85,7	100	19	5,60		
		28H300	H300028	6F	F38	28	113,19	111,82	120	80	—	85,7	100	19	5,60		
		29H300	H300029	6F	F39	29	117,23	115,86	123	80	—	85,7	100	19	6,00		
		30H300	H300030	6F	F40	30	121,28	119,90	128	80	—	85,7	100	19	7,00		
		32H300	H300032	6F	F42	32	129,36	127,99	135	80	—	85,7	100	19	7,80		
		33H300	H300033	6F	F44	33	133,40	132,03	140	80	—	85,7	100	19	8,70		
		34H300	H300034	6F	F45	34	137,45	136,07	142	80	—	85,7	100	19	9,70		
		35H300	H300035	6F	F48	35	141,49	140,12	150	80	—	85,7	100	19	9,80		
		36H300	H300036	6WF	F48	36	145,53	144,16	150	80	118	85,7	100	19	9,90		
		38H300	H300038	6WF	F50	38	153,62	152,24	158	80	126	85,7	100	19	11,00		
		40H300	H300040	6WF	F52	40	161,70	160,33	168	80	134	85,7	100	19	12,20		
		42H300	H300042	6WF	F53	42	169,79	168,41	180	80	140	85,7	100	24	13,80		
		44H300	H300044	6WF	F55	44	177,87	176,50	184	80	150	85,7	100	24	15,00		
		45H300	H300045	6WF	F57	45	181,91	180,54	192	80	154	85,7	100	24	15,20		
		48H300	H300048	6WF	F59	48	194,04	192,67	200	90	166	85,7	100	24	11,40		
		Ghisa / Cast iron / Grauguss Fonte / Hierro fundido	senza flangia / without flanges ohne Flanschen / sans flasques / sin tapetas	49H300	H300049	6W	F49	49	198,08	196,71	—	90	170	85,7	100	24	9,40
				50H300	H300050	6W	F50	50	202,13	200,75	—	90	174	85,7	100	24	10,60
				52H300	H300052	6W	F52	52	210,21	208,84	—	90	182	85,7	100	24	11,80
				58H300	H300058	6A	F58	58	234,47	233,09							

# Pulegge per cinghie dentate / Timing belt pulleys Zahnriemenscheiben / Poulies pour courroies dentées / Poleas para correas dentadas



## XH 200 - 7/8" (22,225 mm)

Caratteristiche Features Merkmale Características	Codice Code symbol Fabriknummer Code symbole Numero de fabrica	Nostro codice Our code Unser kode Notre code Nuestro codigo	Tipo Type Typ Type Tipo	Tipo flangia Flanges type Bordscheiben Typ Type flasques Tipo tapetas	N. denti N. of teeth Zahnezahl N. bre de dents Cantidad de dientes	Dp	De	Df	Dm	Di	F	L	Foro stock Stock bore Vor bohrung Alesage en stock Agujero de stock	Peso Weight / Gewicht Poids / Peso Kg			
Acciaio / Steel / Stahl Acier / Acero	con flangia / with flanges mit Flanges / avec flasques / con tapetas	18XH200	XH20018	6F	F44	18	127,34	124,55	140	100	—	65	80	24	5,90		
		19XH200	XH20019	6F	F46	19	134,41	131,62	146	100	—	65	80	24	6,50		
		20XH200	XH20020	6F	F50	20	141,49	138,69	155	100	—	65	80	24	7,20		
		21XH200	XH20021	6F	F51	21	148,56	145,77	160	110	—	65	80	24	7,90		
		22XH200	XH20022	6F	F52	22	155,64	152,84	168	110	—	65	80	24	8,70		
		24XH200	XH20024	6F	F81	24	169,79	166,99	184	120	—	65	80	24	10,60		
		25XH200	XH20025	6F	F56	25	176,86	174,07	188	120	—	65	80	24	11,40		
		26XH200	XH20026	6F	F59	26	183,94	181,14	200	120	—	65	80	24	12,20		
		27XH200	XH20027	6F	F59	27	191,01	188,22	200	120	—	65	80	24	13,50		
		28XH200	XH20028	6F	F61	28	198,08	195,29	212	150	—	65	80	24	14,80		
		30XH200	XH20030	6F	F62	30	212,23	209,44	226	150	—	65	80	24	16,60		
		32XH200	XH20032	6WF	F64	32	226,38	223,59	240	150	184	65	80	24	17,90		
		34XH200	XH20034	6WF	F66	34	240,53	237,74	256	150	198	65	80	24	18,20		
		38XH200	XH20038	6WF	F69	38	268,83	266,03	286	150	227	65	100	28	19,00		
		40XH200	XH20040	6WF	F70	40	282,98	280,18	296	150	241	65	100	28	22,10		
		Ghisa / Cast iron / Grauguss Fonte / Hierro fundido	senza flangia / without flanges ohne Flanschen / sans flasques sin tapetas	46XH200	XH20046	6W		46	325,42	322,63	—	150	283	65	100	28	26,00
				48XH200	XH20048	6W		48	339,57	336,78	—	150	297	65	100	28	27,60
				50XH200	XH20050	6W		50	410,32	407,52	—	150	368	65	100	28	27,60
				60XH200	XH20060	6W		60	424,47	421,67	—	150	382	65	100	28	22,10
				70XH200	XH20070	6A		70	495,21	492,42	—	190	453	65	100	28	39,00
72XH200	XH20072			6A		72	509,36	506,56	—	190	467	65	100	28	42,00		
78XH200	XH20078			6A		78	551,81	549,01	—	190	510	65	100	28	48,00		
80XH200	XH20080			6A		80	565,95	563,16	—	190	524	65	100	28	51,00		
82XH200	XH20082			6A		82	580,10	577,31	—	190	538	65	100	28	54,00		
84XH200	XH20084			6A		84	594,25	591,46	—	190	552	65	100	28	57,00		
94XH200	XH20094			6A		94	665,00	662,20	—	190	623	65	100	28	64,00		
96XH200	XH20096			6A		96	679,15	676,35	—	190	637	65	100	28	67,00		
118XH200	XH20118	6A		118	834,78	831,99	—	190	792	65	100	28	88,00				
120XH200	XH20120	6A		120	848,93	846,14	—	190	806	65	100	28	90,00				

## XH 300 - 7/8" (22,225 mm)

Caratteristiche Features Merkmale Características	Codice Code symbol Fabriknummer Code symbole Numero de fabrica	Nostro codice Our code Unser kode Notre code Nuestro codigo	Tipo Type Typ Type Tipo	Tipo flangia Flanges type Bordscheiben Typ Type flasques Tipo tapetas	N. denti N. of teeth Zahnezahl N. bre de dents Cantidad de dientes	Dp	De	Df	Dm	Di	F	L	Foro stock Stock bore Vor bohrung Alesage en stock Agujero de stock	Peso Weight / Gewicht Poids / Peso Kg			
Acciaio / Steel / Stahl Acier / Acero	con flangia / with flanges mit Flanges / avec flasques / con tapetas	18XH300	XH30018	6F	F44	18	127,34	124,55	140	100	—	90,5	110	28	8,90		
		19XH300	XH30019	6F	F46	19	134,41	131,62	146	100	—	90,5	110	28	9,20		
		20XH300	XH30020	6F	F50	20	141,49	138,69	155	100	—	90,5	110	28	9,50		
		21XH300	XH30021	6F	F51	21	148,56	145,77	160	110	—	90,5	110	28	10,80		
		22XH300	XH30022	6F	F52	22	155,64	152,84	168	110	—	90,5	110	28	12,10		
		24XH300	XH30024	6F	F81	24	169,79	166,99	184	120	—	90,5	110	28	14,10		
		25XH300	XH30025	6F	F56	25	176,86	174,07	188	120	—	90,5	110	28	15,40		
		26XH300	XH30026	6F	F59	26	183,94	181,14	200	120	—	90,5	110	28	16,70		
		27XH300	XH30027	6F	F59	27	191,01	188,22	200	120	—	90,5	110	28	18,40		
		28XH300	XH30028	6F	F61	28	198,08	195,29	212	150	—	90,5	110	28	20,20		
		30XH300	XH30030	6F	F62	30	212,23	209,44	226	150	—	90,5	110	28	23,80		
		32XH300	XH30032	6WF	F64	32	226,38	223,59	240	150	—	90,5	110	28	26,60		
		34XH300	XH30034	6WF	F66	34	240,53	237,74	256	150	198	90,5	110	28	29,40		
		38XH300	XH30038	6WF	F69	38	268,83	266,03	286	175	227	90,5	120	32	32,00		
		40XH300	XH30040	6WF	F70	40	282,98	280,18	296	175	241	90,5	120	32	37,50		
		Ghisa / Cast iron / Grauguss Fonte / Hierro fundido	senza flangia / without flanges ohne Flanschen / sans flasques sin tapetas	46XH300	XH30046	6W		46	325,42	322,63	—	175	283	90,5	120	32	32,50
				48XH300	XH30048	6W		48	339,57	336,78	—	175	297	90,5	120	32	34,00
				50XH300	XH30050	6W		50	410,32	407,52	—	175	368	90,5	120	32	37,00
				60XH300	XH30060	6W		60	424,47	421,67	—	175	382	90,5	120	32	39,00
				70XH300	XH30070	6A		70	495,21	492,42	—	175	453	90,5	120	32	53,00
72XH300	XH30072			6A		72	509,36	506,56	—	175	467	90,5	120	32	55,00		
78XH300	XH30078			6A		78	551,81	549,01	—	175	510	90,5	120	32	62,00		
80XH300	XH30080			6A		80	565,95	563,16	—	175	524	90,5	120	32	64,00		
82XH300	XH30082			6A		82	580,10	577,31	—	175	538	90,5	120	32	66,00		
84XH300	XH30084			6A		84	594,25	591,46	—	175	552	90,5	120	32	69,00		
94XH300	XH30094			6A		94	665,00	662,20	—	175	623	90,5	120	32	81,00		
96XH300	XH30096			6A		96	679,15	676,35	—	175	637	90,5	120	32	85,00		
118XH300	XH30118	6A		118	834,78	831,99	—	175	792	90,5	120	32	116,00				
120XH300	XH30120	6A		120	848,93	846,14	—	175	806	90,5	120	32	121,00				

## XH 400 - 7/8" (22,225 mm)

Caratteristiche Features Merkmale Características	Codice Code symbol Fabriknummer Code symbole Numero de fabrica	Nostro codice Our code Unser kode Notre code Nuestro codigo	Tipo Type Typ Type Tipo	Tipo flangia Flanges type Bordscheiben Typ Type flasques Tipo tapetas	N. denti N. of teeth Zahnezahl N. bre de dents Cantidad de dientes	Dp	De	Df	Dm	Di	F	L	Foro stock Stock bore Vor bohrung Alesage en stock Agujero de stock	Peso Weight / Gewicht Poids / Peso Kg			
Acciaio / Steel / Stahl Acier / Acero	con flangia / with flanges mit Flanges / avec flasques / con tapetas	18XH400	XH40018	6F	F44	18	127,34	124,55	140	100	—	118	132	32	9,50		
		19XH400	XH40019	6F	F46	19	134,41	131,62	146	100	—	118	132	32	10,65		
		20XH400	XH40020	6F	F50	20	141,49	138,69	154	100	—	118	132	32	11,80		
		21XH400	XH40021	6F	F51	21	148,56	145,77	160	110	—	118	132	32	13,20		
		22XH400	XH40022	6F	F52	22	155,64	152,84	168	110	—	118	132	32	14,73		
		24XH400	XH40024	6F	F81	24	169,79	166,99	184	120	—	118	132	32	17,80		
		25XH400	XH40025	6F	F56	25	176,86	174,07	192	120	—	118	132	32	19,40		
		26XH400	XH40026	6F	F59	26	183,94	181,14	200	120	—	118	132	32	21,10		
		27XH400	XH40027	6F	F59	27	191,01	188,22	200	120	—	118	132	32	22,80		
		28XH400	XH40028	6F	F61	28	198,08	195,29	211	150	—	118	132	32	22,60		
		30XH400	XH40030	6F	F62	30	212,23	209,44	226	150	—	118	132	32	28,70		
		32XH400	XH40032	6F	F64	32	226,38	223,59	240	150	—	118	132	32	32,50		
		34XH400	XH40034	6F	F66	34	240,53	237,74	256	150	—	118	132	32	36,50		
		38XH400	XH40038	6WF	F69	38	268,83	266,03	286	150	227	118	132	32	40,00		
		40XH400	XH40040	6WF	F70	40	282,98	280,18	296	150	241	118	132	32	32,90		
		Ghisa / Cast iron / Grauguss Fonte / Hierro fundido	senza flangia / without flanges ohne Flanschen / sans flasques sin tapetas	46XH400	XH40046	6W		46	325,42	322,63	—	175	283	118	132	32	38,00
				48XH400	XH40048	6W		48	339,57	336,78	—	175	297	118	132	32	41,00
				50XH400	XH40050	6W		50	410,32	407,52	—	175	368	118	132	32	46,00
				60XH400	XH40060	6W		60	424,47	421,67	—	175	382	118	132	32	47,00
				70XH400	XH400												

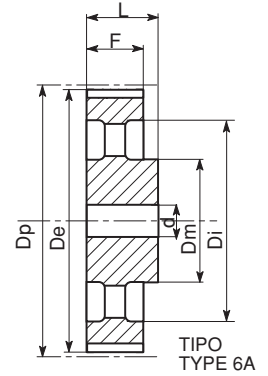
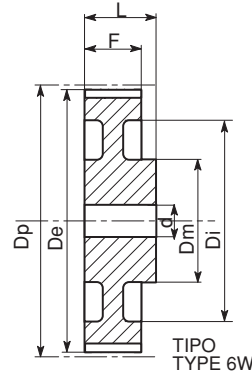
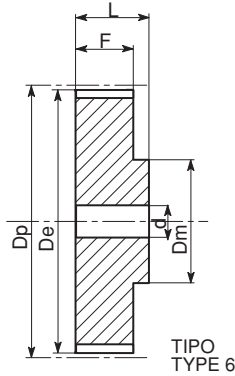
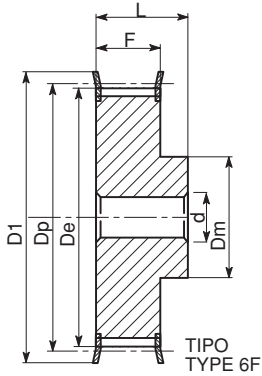

### XXH 200 - 1" 1/4 (31,750 mm)

Caratteristiche Features Merkmale Características Características	Codice Code symbol Fabriknummer Code symbole Numero de fabrica	Nostro codice Our code Unser kode Notre code Nuestro codigo	Tipo Type Typ Type Tipo	Tipo flangia Flanges type Bordscheiben Typ Type flasques Tipo tapetas	N. denti N. of teeth Zahnezahl N. bre de dents Cantidad de dientes	Dp	De	Df	Dm	Di	F	L	Foro stock Stock bore Vor bohrung Alesage en stock Agujero de stock	Peso Weight / Gewicht Poids / Peso Kg	
Acciaio / Steel / Stahl Acier / Acero	con flangia / with flanges mit Flanges / avec flasques con tapetas	<b>18XXH200</b>	<b>XXH2018</b>	6F	F58	18	181,91	178,87	198	140	—	64,2	100	28	14,2
		<b>19XXH200</b>	<b>XXH2019</b>	6F	F60	19	192,02	188,97	205	140	—	64,2	100	28	15,8
		<b>20XXH200</b>	<b>XXH2020</b>	6F	F61	20	202,13	199,08	212	150	—	64,2	100	28	17,3
		<b>21XXH200</b>	<b>XXH2021</b>	6F	F62	21	212,23	209,19	226	150	—	64,2	100	28	18,5
		<b>22XXH200</b>	<b>XXH2022</b>	6F	F64	22	222,34	219,29	240	150	—	64,2	100	28	20,0
Ghisa / Cast iron / Grauguss Fonte / Hierro fundido	senza flangia / without flanges ohne Flanschen / sans flasques sin tapetas	<b>24XXH200</b>	<b>XXH2024</b>	6		24	242,55	239,50	—	150	—	64,2	100	28	23,6
		<b>25XXH200</b>	<b>XXH2025</b>	6W		25	252,66	249,61	—	150	196	64,2	100	28	18,0
		<b>26XXH200</b>	<b>XXH2026</b>	6W		26	262,76	259,79	—	150	207	64,2	100	28	20,0
		<b>27XXH200</b>	<b>XXH2027</b>	6W		27	272,87	269,82	—	150	216	64,2	100	28	24,0
		<b>30XXH200</b>	<b>XXH2030</b>	6W		30	303,19	300,14	—	150	247	64,2	100	28	26,0
		<b>34XXH200</b>	<b>XXH2034</b>	6W		34	343,62	340,57	—	150	287	64,2	100	28	31,8
		<b>40XXH200</b>	<b>XXH2040</b>	6W		40	404,25	401,21	—	150	348	64,2	100	28	43,0
		<b>48XXH200</b>	<b>XXH2048</b>	6W		48	485,10	482,06	—	175	429	64,2	100	32	60,4
		<b>60XXH200</b>	<b>XXH2060</b>	6A		60	606,38	603,33	—	175	547	64,2	120	32	100,0
		<b>72XXH200</b>	<b>XXH2072</b>	6A		72	727,66	724,61	—	175	668	64,2	120	38	130,0
<b>90XXH200</b>	<b>XXH2090</b>	6A		90	909,57	906,52	—	175	850	64,2	120	38	156,0		

### XXH 300 - 1" 1/4 (31,750 mm)

Caratteristiche Features Merkmale Características Características	Codice Code symbol Fabriknummer Code symbole Numero de fabrica	Nostro codice Our code Unser kode Notre code Nuestro codigo	Tipo Type Typ Type Tipo	Tipo flangia Flanges type Bordscheiben Typ Type flasques Tipo tapetas	N. denti N. of teeth Zahnezahl N. bre de dents Cantidad de dientes	Dp	De	Df	Dm	Di	F	L	Foro stock Stock bore Vor bohrung Alesage en stock Agujero de stock	Peso Weight / Gewicht Poids / Peso Kg	
Acciaio / Steel / Stahl Acier / Acero	con flangia / with flanges mit Flanges / avec flasques con tapetas	<b>18XXH300</b>	<b>XXH30018</b>	6F	F58	18	181,91	178,87	198	140	—	91,4	110	28	16,0
		<b>19XXH300</b>	<b>XXH30019</b>	6F	F60	19	192,02	188,97	205	140	—	91,4	110	28	18,4
		<b>20XXH300</b>	<b>XXH30020</b>	6F	F61	20	202,13	199,08	212	150	—	91,4	110	28	20,4
		<b>21XXH300</b>	<b>XXH30021</b>	6F	F62	21	212,23	209,19	226	150	—	91,4	110	28	22,0
		<b>22XXH300</b>	<b>XXH30022</b>	6F	F64	22	222,34	219,29	240	150	—	91,4	110	28	25,0
Ghisa / Cast iron / Grauguss Fonte / Hierro fundido	senza flangia / without flanges ohne Flanschen / sans flasques sin tapetas	<b>24XXH300</b>	<b>XXH30024</b>	6		24	242,55	239,50	—	150	—	91,4	110	28	29,2
		<b>25XXH300</b>	<b>XXH30025</b>	6W		25	252,66	249,61	—	150	196	91,4	110	28	24,6
		<b>26XXH300</b>	<b>XXH30026</b>	6W		26	262,76	259,79	—	150	207	91,4	110	28	27,0
		<b>27XXH300</b>	<b>XXH30027</b>	6W		27	272,87	269,82	—	150	216	91,4	110	28	29,0
		<b>30XXH300</b>	<b>XXH30030</b>	6W		30	303,19	300,14	—	150	247	91,4	110	28	31,0
		<b>34XXH300</b>	<b>XXH30034</b>	6W		34	343,62	340,57	—	150	287	91,4	110	28	39,0
		<b>40XXH300</b>	<b>XXH30040</b>	6W		40	404,25	401,21	—	150	348	91,4	110	28	45,0
		<b>48XXH300</b>	<b>XXH30048</b>	6W		48	485,10	482,06	—	175	429	91,4	110	32	60,0
		<b>60XXH300</b>	<b>XXH30060</b>	6A		60	606,38	603,33	—	175	547	91,4	120	32	100,0
		<b>72XXH300</b>	<b>XXH30072</b>	6A		72	727,66	724,61	—	175	668	91,4	120	38	135,0
<b>90XXH300</b>	<b>XXH30090</b>	6A		90	909,57	906,52	—	175	850	91,4	120	38	160,0		



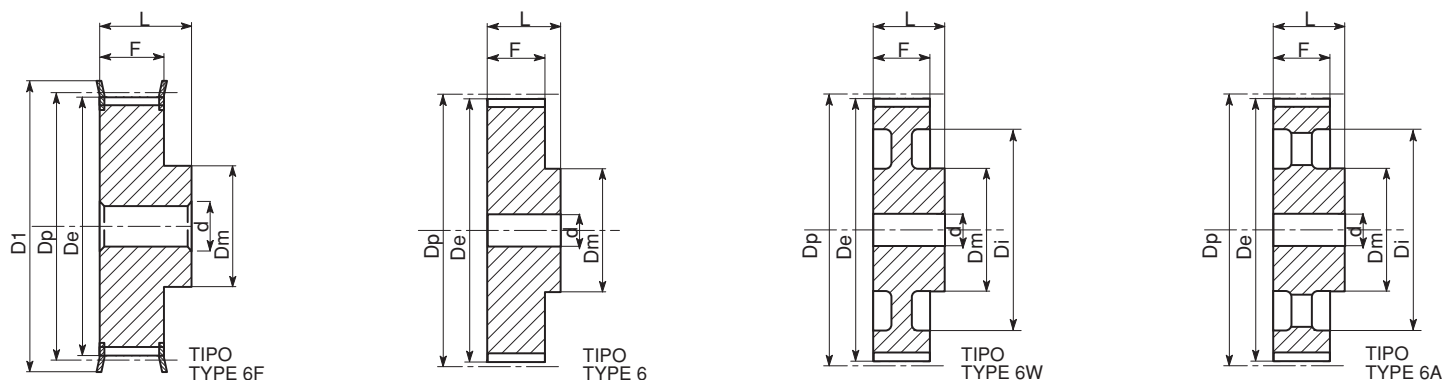

### XXH 400 - 1" 1/4 (31,750 mm)

Caratteristiche Features Merkmal Características	Codice Code symbol Fabriknummer Code symbole Numero de fabrica	Nostro codice Our code Unser kode Notre code Nuestro codigo	Tipo Type Typ Type Tipo	Tipo flangia Flanges type Bordscheiben Typ Type flasques Tipo tapetas	N. denti N. of teeth Zahnezahl N. bre de dents Cantidad de dientes	Dp	De	Df	Dm	Di	F	L	Foro stock Stock bore Vor bohrung Alesage en stock Agujero de stock	Peso Weight / Gewicht Poids / Peso Kg	
Acciaio / Steel / Stahl Acier / Acero	con flangia / with flanges mit Flanges / avec flasques con tapetas	<b>18XXH400</b>	<b>XXH4018</b>	6F	F58	18	181,91	178,87	198	140	—	120,7	140	32	20,8
		<b>19XXH400</b>	<b>XXH4019</b>	6F	F60	19	192,02	188,97	205	140	—	120,7	140	32	24,0
		<b>20XXH400</b>	<b>XXH4020</b>	6F	F61	20	202,13	199,08	212	150	—	120,7	140	32	26,0
		<b>21XXH400</b>	<b>XXH4021</b>	6F	F62	21	212,23	209,19	226	150	—	120,7	140	32	28,5
		<b>22XXH400</b>	<b>XXH4022</b>	6F	F64	22	222,34	219,29	240	150	—	120,7	140	32	31,6
Ghisa / Cast iron / Grauguss Fonte / Hierro fundido	senza flangia / without flanges ohne Flanschen / sans flasques sin tapetas	<b>24XXH400</b>	<b>XXH4024</b>	6		24	242,55	239,50	—	150	—	120,7	140	32	35,0
		<b>25XXH400</b>	<b>XXH4025</b>	6W		25	252,66	249,61	—	150	196	120,7	140	32	28,0
		<b>26XXH400</b>	<b>XXH4026</b>	6W		26	262,76	259,79	—	150	207	120,7	140	32	32,4
		<b>27XXH400</b>	<b>XXH4027</b>	6W		27	272,87	269,82	—	150	216	120,7	140	32	34,0
		<b>30XXH400</b>	<b>XXH4030</b>	6W		30	303,19	300,14	—	185	247	120,7	140	32	36,0
		<b>34XXH400</b>	<b>XXH4034</b>	6W		34	343,62	340,57	—	185	287	120,7	140	32	47,6
		<b>40XXH400</b>	<b>XXH4040</b>	6W		40	404,25	401,21	—	185	348	120,7	140	32	65,0
		<b>48XXH400</b>	<b>XXH4048</b>	6W		48	485,10	482,06	—	185	429	120,7	140	38	80,5
		<b>60XXH400</b>	<b>XXH4060</b>	6A		60	606,38	603,33	—	185	547	120,7	140	38	108,0
		<b>72XXH400</b>	<b>XXH4072</b>	6A		72	727,66	724,61	—	220	668	120,7	140	38	140,0
	<b>90XXH400</b>	<b>XXH4090</b>	6A		90	909,57	906,52	—	220	850	120,7	140	38	170,0	

### XXH 500 - 1" 1/4 (31,750 mm)

Caratteristiche Features Merkmal Características	Codice Code symbol Fabriknummer Code symbole Numero de fabrica	Nostro codice Our code Unser kode Notre code Nuestro codigo	Tipo Type Typ Type Tipo	Tipo flangia Flanges type Bordscheiben Typ Type flasques Tipo tapetas	N. denti N. of teeth Zahnezahl N. bre de dents Cantidad de dientes	Dp	De	Df	Dm	Di	F	L	Foro stock Stock bore Vor bohrung Alesage en stock Agujero de stock	Peso Weight / Gewicht Poids / Peso Kg	
Acciaio / Steel / Stahl Acier / Acero	con flangia / with flanges mit Flanges / avec flasques con tapetas	<b>18XXH500</b>	<b>XXH5018</b>	6F	F58	18	181,91	178,87	198	140	—	145,3	168	32	24,0
		<b>19XXH500</b>	<b>XXH5019</b>	6F	F60	19	192,02	188,97	205	140	—	145,3	168	32	28,0
		<b>20XXH500</b>	<b>XXH5020</b>	6F	F61	20	202,13	199,08	212	150	—	145,3	168	32	31,4
		<b>21XXH500</b>	<b>XXH5021</b>	6F	F62	21	212,23	209,19	226	150	—	145,3	168	32	34,0
		<b>22XXH500</b>	<b>XXH5022</b>	6F	F64	22	222,34	219,29	240	150	—	145,3	168	32	38,3
Ghisa / Cast iron / Grauguss Fonte / Hierro fundido	senza flangia / without flanges ohne Flanschen / sans flasques sin tapetas	<b>24XXH500</b>	<b>XXH5024</b>	6		24	242,55	239,50	—	150	—	145,3	168	32	45,0
		<b>25XXH500</b>	<b>XXH5025</b>	6W		25	252,66	249,61	—	150	196	145,3	168	32	36,0
		<b>26XXH500</b>	<b>XXH5026</b>	6W		26	262,76	259,79	—	150	207	145,3	168	32	37,5
		<b>27XXH500</b>	<b>XXH5027</b>	6W		27	272,87	269,82	—	150	216	145,3	168	32	42,0
		<b>30XXH500</b>	<b>XXH5030</b>	6W		30	303,19	300,14	—	215	247	145,3	168	32	46,8
		<b>34XXH500</b>	<b>XXH5034</b>	6W		34	343,62	340,57	—	215	287	145,3	168	32	57,0
		<b>40XXH500</b>	<b>XXH5040</b>	6W		40	404,25	401,21	—	215	348	145,3	168	32	68,0
		<b>48XXH500</b>	<b>XXH5048</b>	6W		48	485,10	482,06	—	215	429	145,3	168	38	88,8
		<b>60XXH500</b>	<b>XXH5060</b>	6A		60	606,38	603,33	—	240	547	145,3	120	38	99,8
		<b>72XXH500</b>	<b>XXH5072</b>	6A		72	727,66	724,61	—	240	668	145,3	120	38	172,0
	<b>90XXH500</b>	<b>XXH5090</b>	6A		90	909,57	906,52	—	240	850	145,3	120	38	242,5	

Le barre dentate XL e L sono costruite in acciaio UNI C 40 e in alluminio UNI 3571 TA 16, adatte alla anodizzazione. Le barre MXL sono costruite solo in alluminio.

The timing bars XL and L are made of steel UNI C 40 and of aluminium UNI 3571 TA 16, suitable for anodic treatment, whereas the bars MXL are made of aluminium only.

Die stangen XL und L sind aus stahl UNI C 40 und aluminium UNI 3571 TA 16 geeignet fuer anodischen oxydation. Die stangen MXL werden nur aus aluminium gefertigt.

Les barreaux dentes XL et L sont fabriqués en acier UNI C 40 et en aluminium UNI 3571 TA 16, apte au traitement anodi = que, tandis que les barreaux MXL ne sont fabriqués qu'en aluminium.

Las barras dentadas XL y L se construyen en acero UNI C 40 y en aluminio UNI 3571 TA 16 para la oxidacion anodica, mientras que las barras MXL solo se fabrican en aluminio.

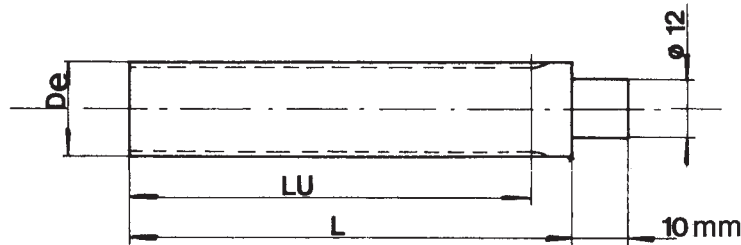

### MXL - 0.080" (mm 2,032)

### XL - 1/5" (mm 5,08)

### L - 3/8" (mm 9,525)

Codice Code symbol Fabriknummer Code symbole Numero de fabrica	Nostro codice Our code Unser kode Notre code Nuestro codigo	N. denti N. of teeth Zahnezahl N. bre de dents Cantidad de dientes	De	LU	L	Codice Code symbol Fabriknummer Code symbole Numero de fabrica	Nostro codice Our code Unser kode Notre code Nuestro codigo		N. denti N. of teeth Zahnezahl N. bre de dents Cantidad de dientes	De	LU	L	Codice Code symbol Fabriknummer Code symbole Numero de fabrica	Nostro codice Our code Unser kode Notre code Nuestro codigo		N. denti N. of teeth Zahnezahl N. bre de dents Cantidad de dientes	De	LU	L
							AL	C40						AL	C40				
<b>MXL 11</b>	BMXL 011	11	6,60	50	75	<b>XL 10</b>	BXLA 010	BXLC 010	10	15,66	125	140	<b>L 10</b>	BOLA 010	BOLC 010	10	29,56	140	140
<b>MXL 12</b>	BMXL 012	12	7,26	50	75	<b>XL 11</b>	BXLA 011	BXLC 011	11	17,28	125	140	<b>L 11</b>	BOLA 011	BOLC 011	11	32,59	140	140
<b>MXL 13</b>	BMXL 013	13	7,90	50	75	<b>XL 12</b>	BXLA 012	BXLC 012	12	18,90	125	140	<b>L 12</b>	BOLA 012	BOLC 012	12	35,62	160	160
<b>MXL 14</b>	BMXL 014	14	8,56	50	75	<b>XL 13</b>	BXLA 013	BXLC 013	13	20,51	125	140	<b>L 13</b>	BOLA 013	BOLC 013	13	38,65	160	160
<b>MXL 15</b>	BMXL 015	15	9,19	50	75	<b>XL 14</b>	BXLA 014	BXLC 014	14	22,13	132	140	<b>L 14</b>	BOLA 014	BOLC 014	14	41,68	160	160
<b>MXL 16</b>	BMXL 016	16	9,83	50	75	<b>XL 15</b>	BXLA 015	BXLC 015	15	23,75	132	140	<b>L 15</b>	BOLA 015	BOLC 015	15	44,72	160	160
<b>MXL 17</b>	BMXL 017	17	10,49	50	75	<b>XL 16</b>	BXLA 016	BXLC 016	16	25,36	140	140	<b>L 16</b>	BOLA 016	BOLC 016	16	47,75	160	160
<b>MXL 18</b>	BMXL 018	18	11,12	50	75	<b>XL 17</b>	BXLA 017	BXLC 017	17	26,98	140	140	<b>L 17</b>	BOLA 017	BOLC 017	17	50,78	160	160
<b>MXL 19</b>	BMXL 019	19	11,78	90	120	<b>XL 18</b>	BXLA 018	BXLC 018	18	28,60	140	140	<b>L 18</b>	BOLA 018	BOLC 018	18	53,81	160	160
<b>MXL 20</b>	BMXL 020	20	12,42	90	120	<b>XL 19</b>	BXLA 019	BXLC 019	19	30,22	140	140	<b>L 19</b>	BOLA 019	BOLC 019	19	56,84	160	160
<b>MXL 21</b>	BMXL 021	21	13,08	90	120	<b>XL 20</b>	BXLA 020	BXLC 020	20	31,83	140	140	<b>L 20</b>	BOLA 020	BOLC 020	20	59,88	160	160
<b>MXL 22</b>	BMXL 022	22	13,72	125	140	<b>XL 21</b>	BXLA 021	BXLC 021	21	33,45	160	160	<b>L 21</b>	BOLA 021	BOLC 021	21	62,91	160	160
<b>MXL 23</b>	BMXL 023	23	14,38	125	140	<b>XL 22</b>	BXLA 022	BXLC 022	22	35,07	160	160	<b>L 22</b>	BOLA 022	BOLC 022	22	65,94	160	160
<b>MXL 24</b>	BMXL 024	24	15,01	125	140	<b>XL 23</b>	BXLA 023	BXLC 023	23	36,60	160	160	<b>L 23</b>	BOLA 023	BOLC 023	23	68,97	160	160
<b>MXL 25</b>	BMXL 025	25	15,67	125	140	<b>XL 24</b>	BXLA 024	BXLC 024	24	38,30	160	160	<b>L 24</b>	BOLA 024	BOLC 024	24	72,00	160	160
<b>MXL 26</b>	BMXL 026	26	16,31	125	140	<b>XL 25</b>	BXLA 025	BXLC 025	25	39,93	160	160	<b>L 27</b>	BOLA 027	BOLC 027	27	81,10	160	160
<b>MXL 27</b>	BMXL 027	27	16,94	125	140	<b>XL 26</b>	BXLA 026	BXLC 026	26	41,53	160	160	<b>L 30</b>	BOLA 030	BOLC 030	30	90,20	160	160
<b>MXL 28</b>	BMXL 028	28	16,70	125	140	<b>XL 27</b>	BXLA 027	BXLC 027	27	43,15	160	160							
<b>MXL 29</b>	BMXL 029	29	18,24	125	140	<b>XL 28</b>	BXLA 028	BXLC 028	28	44,77	160	160							
<b>MXL 30</b>	BMXL 030	30	18,90	125	140	<b>XL 29</b>	BXLA 029	BXLC 029	29	46,39	160	160							
<b>MXL 32</b>	BMXL 032	32	20,19	125	140	<b>XL 30</b>	BXLA 030	BXLC 030	30	48,00	160	160							
<b>MXL 34</b>	BMXL 034	34	21,49	125	140	<b>XL 32</b>	BXLA 032	BXLC 032	32	51,24	160	160							
<b>MXL 35</b>	BMXL 035	35	22,12	132	140	<b>XL 34</b>	BXLA 034	BXLC 034	34	54,47	160	160							
<b>MXL 36</b>	BMXL 036	36	22,78	132	140	<b>XL 35</b>	BXLA 035	BXLC 035	35	56,09	160	160							
<b>MXL 38</b>	BMXL 038	38	24,08	132	140	<b>XL 36</b>	BXLA 036	BXLC 036	36	57,70	160	160							
<b>MXL 40</b>	BMXL 040	40	25,37	132	140	<b>XL 38</b>	BXLA 038	BXLC 038	38	60,94	160	160							
<b>MXL 42</b>	BMXL 042	42	26,67	140	140	<b>XL 40</b>	BXLA 040	BXLC 040	40	64,17	160	160							
<b>MXL 44</b>	BMXL 044	44	27,94	140	140	<b>XL 42</b>	BXLA 042	BXLC 042	42	67,41	160	160							
<b>MXL 45</b>	BMXL 045	45	28,60	140	140	<b>XL 44</b>	BXLA 044	BXLC 044	44	70,64	160	160							
<b>MXL 48</b>	BMXL 048	48	30,53	140	140	<b>XL 45</b>	BXLA 045	BXLC 045	45	72,26	160	160							
<b>MXL 50</b>	BMXL 050	50	32,33	140	140	<b>XL 48</b>	BXLA 048	BXLC 048	48	77,11	160	160							
<b>MXL 60</b>	BMXL 060	60	38,30	160	160	<b>XL 50</b>	BXLA 050	BXLC 050	50	80,33	160	160							
<b>MXL 64</b>	BMXL 064	64	40,89	160	160	<b>XL 60</b>	BXLA 060	BXLC 060	60	96,51	160	160							
<b>MXL 65</b>	BMXL 065	65	41,53	160	160	<b>XL 64</b>	BXLA 064	BXLC 064	64	102,95	160	160							
<b>MXL 70</b>	BMXL 070	70	44,78	160	160	<b>XL 65</b>	BXLA 065	BXLC 065	65	104,56	160	160							
<b>MXL 72</b>	BMXL 072	72	46,05	160	160	<b>XL 70</b>	BXLA 070	BXLC 070	70	112,68	160	160							
<b>MXL 75</b>	BMXL 075	75	48,01	160	160	<b>XL 72</b>	BXLA 072	BXLA 072	72	115,92	160	160							
<b>MXL 90</b>	BMXL 090	90	57,71	160	160														
<b>MXL 110</b>	BMXL 110	110	70,64	160	160														



N. denti N. of teeth Zahnezahl N. bre de dents Cantidad de dientes	Flangia / Flanges / Bordscheiben / Flasques / Tapetas					
	d = 0,5 mm	d = 1 mm	d = 1,5 mm	d = 1,5 mm	d = 2,5 mm	d = 2,5 mm
	<b>MXL</b>	<b>XL</b>	<b>L</b>	<b>H</b>	<b>XH</b>	<b>XXH</b>
8	-	-	-	-	-	-
9	-	-	-	-	-	-
10	-	F 07	F 13	-	-	-
11	-	F 07	F 13	-	-	-
12	-	F 08	F 16	-	-	-
13	-	F 08	F 17	-	-	-
14	-	F 09	F 18	F 24	-	-
15	-	F 09	F 19	F 25	-	-
16	F 02	F 10	F 20	F 26	-	-
17	-	F 10	F 21	F 27	-	-
18	F 03	F 11	F 22	F 28	F 44	F 58
19	-	F 11	F 24	F 29	F 46	F 60
20	F 03	F 14	F 25	F 30	F 49	F 61
21	-	F 14	F 26	F 31	F 51	F 62
22	F 04	F 15	F 27	F 32	F 52	F 64
23	-	-	F 28	F 33	-	-
24	F 06	F 17	F 28	F 34	F 81	-
25	-	-	F 29	F 35	F 56	-
26	-	F 18	F 30	F 36	F 59	-
27	-	F 18	F 30	F 37	F 59	-
28	F 08	F 19	F 31	F 38	F 61	-
29	-	F 19	F 32	F 39	-	-
30	F 08	F 24	F 33	F 40	F 62	-
31	-	-	-	-	-	-
32	F 08	F 21	F 34	F 42	F 64	-
33	-	-	F 35	F 44	-	-
34	-	-	F 34	F 48	F 66	-
35	-	-	F 36	F 48	-	-
36	F 09	-	F 37	F 48	-	-
37	-	-	-	-	-	-
38	-	-	-	F 50	F 69	-
39	-	-	-	-	-	-
40	F 10	-	F 40	F 52	F 70	-
41	-	-	F 41	-	-	-
42	F 10	-	F 42	F 53	-	-
43	-	-	-	-	-	-
44	F 13	-	F 45	F 55	-	-
45	-	-	F 45	F 57	-	-
46	-	-	-	-	-	-
47	-	-	F 48	-	-	-
48	-	-	F 48	F 59	-	-
49	-	-	-	-	-	-
50	-	-	-	-	-	-
51	-	-	-	-	-	-
52	-	-	-	-	-	-
53	-	-	-	-	-	-
54	-	-	-	-	-	-
55	-	-	-	-	-	-
56	-	-	-	-	-	-
57	-	-	-	-	-	-
58	-	-	-	-	-	-
59	-	-	-	-	-	-
60	-	-	-	-	-	-
61	-	-	-	-	-	-
63	-	-	-	-	-	-
64	-	-	-	-	-	-
65	-	-	-	-	-	-
66	-	-	-	-	-	-
67	-	-	-	-	-	-
68	-	-	-	-	-	-
69	-	-	-	-	-	-
70	-	-	-	-	-	-
71	-	-	-	-	-	-
72	-	-	-	-	-	-
73	-	-	-	-	-	-
74	-	-	-	-	-	-
75	-	-	-	-	-	-
76	-	-	-	-	-	-
77	-	-	-	-	-	-
78	-	-	-	-	-	-
79	-	-	-	-	-	-
80	-	-	-	-	-	-
81	-	-	-	-	-	-
82	-	-	-	-	-	-
83	-	-	-	-	-	-
84	-	-	-	-	-	-
85	-	-	-	-	-	-
86	-	-	-	-	-	-
87	-	-	-	-	-	-
88	-	-	-	-	-	-
89	-	-	-	-	-	-
90	-	-	-	-	-	-

Tipo flangia Flanges type Bordscheiben Typ Type flasques Tipo tapetas			
<b>F 01</b>	13,0	10,0	6,0
<b>F 02</b>	15,0	12,0	8,0
<b>F 03</b>	16,0	13,0	9,5
<b>F 04</b>	17,5	14,5	11,6
<b>F 05</b>	18,0	15,0	11,5
<b>F 06</b>	20,0	16,5	12,2
<b>F 07</b>	23,0	18,0	12,5
<b>F 08</b>	25,0	21,5	15,0
<b>F 09</b>	28,0	24,0	17,8
<b>F 10</b>	32,0	27,5	23,0
<b>F 11</b>	35,0	30,5	23,0
<b>F 12</b>	36,0	31,0	25,0
<b>F 13</b>	37,0	33,0	25,0
<b>F 14</b>	38,0	34,0	26,5
<b>F 15</b>	42,0	38,0	30,5
<b>F 16</b>	43,0	39,0	31,0
<b>F 17</b>	44,0	40,5	32,5
<b>F 18</b>	48,0	43,5	37,0
<b>F 19</b>	51,0	47,0	40,0
<b>F 20</b>	54,0	50,5	43,0
<b>F 21</b>	57,0	52,0	46,0
<b>F 22</b>	60,0	57,0	47,0
<b>F 23</b>	61,0	56,5	49,0
<b>F 24</b>	64,0	57,0	47,0
<b>F 25</b>	66,0	63,0	52,0
<b>F 26</b>	70,0	66,5	53,0
<b>F 27</b>	75,0	68,5	60,0
<b>F 28</b>	79,0	72,5	60,0
<b>F 29</b>	83,0	78,0	68,0
<b>F 30</b>	87,0	82,5	72,0
<b>F 31</b>	91,0	85,5	76,0
<b>F 32</b>	93,0	89,0	80,0
<b>F 33</b>	97,0	93,8	83,0
<b>F 34</b>	102,0	97,0	82,5
<b>F 35</b>	106,0	101,0	90,0
<b>F 36</b>	112,0	105,5	91,0
<b>F 37</b>	115,0	109,0	94,0
<b>F 38</b>	120,0	112,5	99,5
<b>F 39</b>	123,0	117,5	107,0
<b>F 40</b>	128,0	124,0	107,0
<b>F 41</b>	131,0	125,5	115,0
<b>F 42</b>	135,0	128,5	115,0
<b>F 43</b>	138,0	132,0	121,0
<b>F 44</b>	140,0	125,0	107,0
<b>F 45</b>	142,0	137,0	120,0
<b>F 46</b>	146,0	133,0	107,0
<b>F 47</b>	148,0	143,0	132,0
<b>F 48</b>	150,0	145,0	130,0
<b>F 49</b>	154,0	142,0	122,0
<b>F 50</b>	158,0	153,0	138,5
<b>F 51</b>	160,0	148,0	120,0
<b>F 52</b>	168,0	161,0	148,0
<b>F 53</b>	175,0	170,0	157,0
<b>F 54</b>	180,0	174,0	154,0
<b>F 55</b>	184,0	177,0	162,0
<b>F 56</b>	188,0	176,0	150,0
<b>F 57</b>	192,0	187,0	173,0
<b>F 58</b>	198,0	180,0	150,0
<b>F 59</b>	200,0	193,0	180,0
<b>F 60</b>	205,0	189,0	160,0
<b>F 61</b>	212,0	200,0	162,0
<b>F 62</b>	226,0	214,0	190,0
<b>F 63</b>	230,0	222,0	200,0
<b>F 64</b>	240,0	224,0	192,0
<b>F 65</b>	250,0	228,0	200,0
<b>F 66</b>	256,0	240,0	220,0
<b>F 67</b>	265,0	240,0	213,0
<b>F 68</b>	275,0	253,0	225,0
<b>F 69</b>	286,0	277,0	242,0
<b>F 70</b>	296,0	287,0	260,0
<b>F 71</b>	300,0	280,0	252,0
<b>F 72</b>	325,0	305,0	278,0
<b>F 73</b>	350,0	330,0	302,0
<b>F 74</b>	375,0	355,0	328,0
<b>F 75</b>	405,0	380,0	354,0
<b>F 76</b>	430,0	406,0	380,0
<b>F 77</b>	455,0	432,0	405,0
<b>F 78</b>	480,0	457,0	430,0
<b>F 79</b>	530,0	508,0	481,0
<b>F 80</b>	595,0	572,0	544,0
<b>F 81</b>	184,0	168,0	135,0





**Pulegge dentate per bussola conica**  
**Timing belt pulleys for taper bushes**  
**Zahnriemenscheiben für Spannbüchsen**  
**Poulies dentées à moyeu amovible**  
**Poleas dentadas para**  
**casquillos cónicos (taper)**



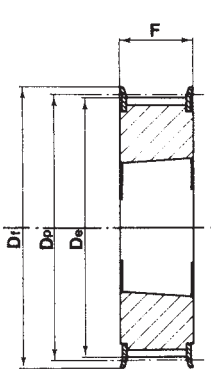

Tipo / Type  
3F

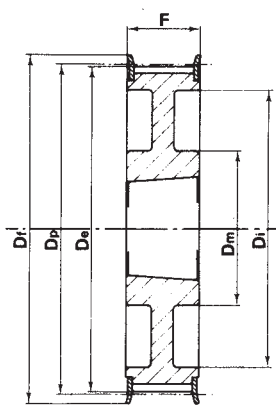

Tipo / Type  
3WF

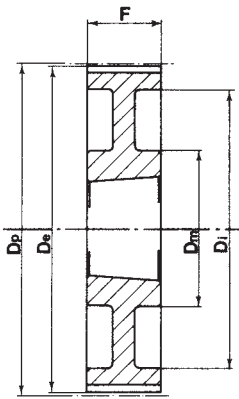

Tipo / Type  
3W

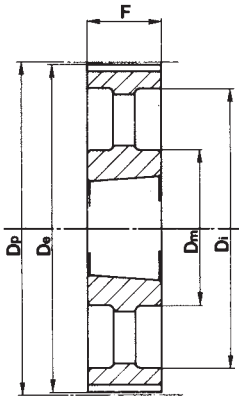

Tipo / Type  
3A

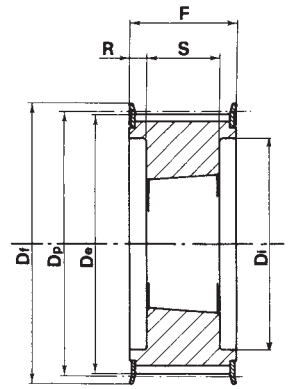

Tipo / Type  
4F

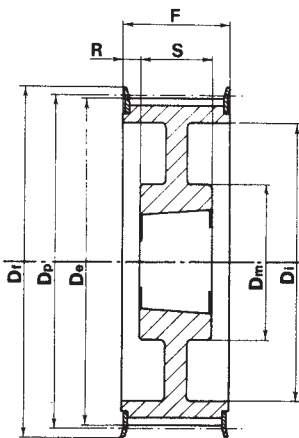

Tipo / Type  
4WF

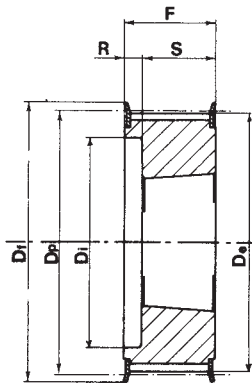

Tipo / Type  
5F

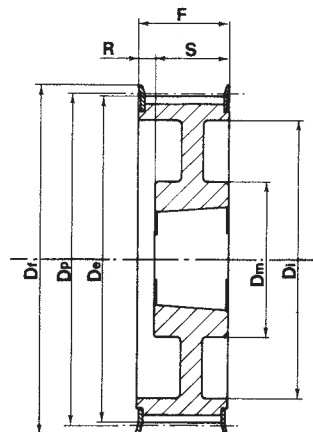

Tipo / Type  
5WF

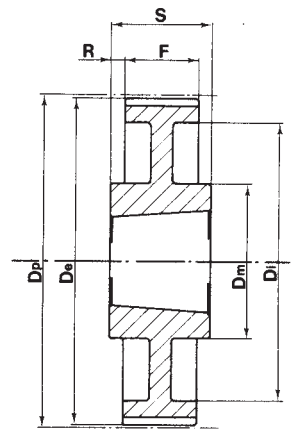

Tipo / Type  
7W

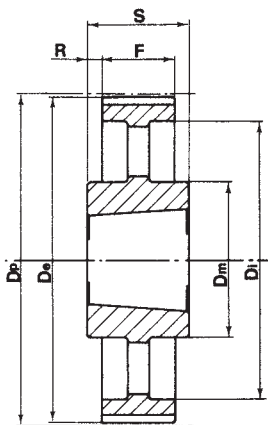

Tipo / Type  
7A

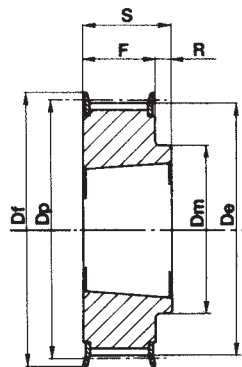

Tipo / Type  
8F

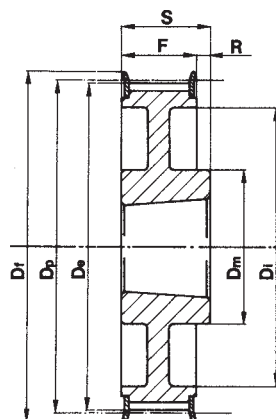

Tipo / Type  
8WF

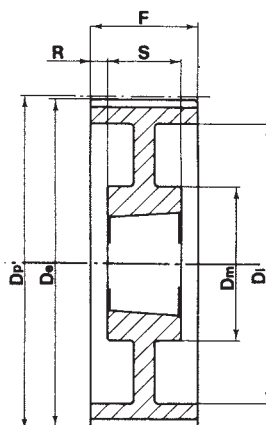

Tipo / Type  
9W

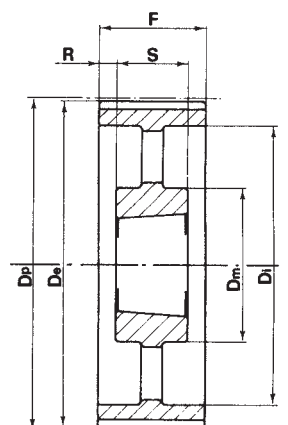

Tipo / Type  
9A

**Pulegge dentate per bussola conica / Timing belt pulleys for taper bushes**  
**Zahnriemenscheiben für Spannbüchsen / Poulies dentées à moyeu amovible**  
**Poleas dentadas para casquillos cónicos (taper)**



**L 050 - 3/8" (9,525 mm)**

Caratteristiche Features Merkmale Características	Codice Code symbol Fabriknummer Code symbole Numero de fabrica	Nostro codice Our code Unser kode Notre code Nuestro codigo	Tipo Type Typ Type Tipo	Tipo flangia Flanges type Bordscheiben Typ Type flasques Tipo tapetas	Bussola Bush Buchse Moyeu Casquillo	Foro max. Max. Bore Max. Bohrung Alesage max. Agujero max.	Dp	De	Df	Dm	Di	F	S	R	Peso Weight / Gewicht Poids / Peso Kg
Acciaio / Steel / Stahl Acier / Acero	<b>18L050</b>	<b>TL50018</b>	8F	F22	1108	28	54,57	53,81	60	45	-	19,0	22,0	3	0,2
	<b>19L050</b>	<b>TL50019</b>	8F	F24	1108	28	57,61	56,84	64	45	-	19,0	22,0	3	0,2
	<b>20L050</b>	<b>TL50020</b>	8F	F25	1108	28	60,64	59,88	66	48	-	19,0	22,0	3	0,2
	<b>21L050</b>	<b>TL50021</b>	8F	F26	1108	28	63,67	62,91	70	48	-	19,0	22,0	3	0,3
	<b>22L050</b>	<b>TL50022</b>	8F	F27	1108	28	66,70	65,94	75	51	-	19,0	22,0	3	0,3
	<b>23L050</b>	<b>TL50023</b>	8F	F28	1108	28	69,73	68,97	79	54	-	19,0	22,0	3	0,4
	<b>24L050</b>	<b>TL50024</b>	8F	F28	1108	28	72,77	72,00	79	54	-	19,0	22,0	3	0,4
	<b>25L050</b>	<b>TL50025</b>	8F	F29	1108	28	75,80	75,04	83	56	-	19,0	22,0	3	0,5
	<b>26L050</b>	<b>TL50026</b>	8F	F30	1108	28	78,83	78,07	87	60	-	19,0	22,0	3	0,5
	<b>27L050</b>	<b>TL50027</b>	8F	F30	1108	28	81,86	81,10	87	62	-	19,0	22,0	3	0,6
	<b>28L050</b>	<b>TL50028</b>	8F	F31	1108	28	84,89	84,13	91	65	-	19,0	22,0	3	0,6
	<b>30L050</b>	<b>TL50030</b>	8F	F33	1108	28	90,96	90,20	97	70	-	19,0	22,0	3	0,8
	<b>32L050</b>	<b>TL50032</b>	8F	F34	1108	28	97,02	96,26	102	74	-	19,0	22,0	3	0,9
	<b>36L050</b>	<b>TL50036</b>	8F	F37	1108	28	109,15	108,39	115	85	-	19,0	22,0	3	1,2
	<b>40L050</b>	<b>TL50040</b>	8F	F40	1610	42	121,28	120,51	128	88	-	19,0	25,0	3	1,5
<b>44L050</b>	<b>TL50044</b>	8WF	F45	1610	42	133,40	132,64	142	88	110	19,0	25,0	6	1,8	
<b>48L050</b>	<b>TL50048</b>	8WF	F48	1610	42	145,53	144,77	150	88	120	19,0	25,0	6	2,3	
Ghisa / Cast iron Grauguss / Fonte Hierro fundido	<b>60L050</b>	<b>TL50060</b>	7W		1610	42	181,91	181,15	-	92	166	19,0	25,0	6	2,0
	<b>72L050</b>	<b>TL50072</b>	7A		1610	42	218,30	217,53	-	92	202	19,0	25,0	6	3,0
	<b>84L050</b>	<b>TL50084</b>	7A		1610	42	254,68	253,90	-	92	236	19,0	25,0	6	4,0
	<b>96L050</b>	<b>TL50096</b>	7A		2012	50	291,06	290,30	-	106	270	19,0	32,0	13	5,5
	<b>120L050</b>	<b>TL50120</b>	7A		2012	50	363,83	363,07	-	106	343	19,0	32,0	13	6,8

**Pulegge dentate per bussola conica / Timing belt pulleys for taper bushes**  
**Zahnriemenscheiben für Spannbüchsen / Poulies dentées à moyeu amovible**  
**Poleas dentadas para casquillos cónicos (taper)**

**L 075 - 3/8" (9,525 mm)**

Caratteristiche Features Merkmale Características	Codice Code symbol Fabriknummer Code symbole Numero de fabrica	Nostro codice Our code Unser kode Notre code Nuestro codigito	Tipo Type Typ Type Tipo	Tipo flangia Flanges type Bordscheiben Typ Type flasques Tipo tapetas	Bussola Bush Buchse Moyeu Casquillo	Foro max. Max. Bore Max. Bohrung Alesage max. Agujero max.	Dp	De	Df	Dm	Di	F	S	R	Peso Weight / Gewicht Poids / Peso Kg	
Acciaio / Steel / Stahl Acier / Acero	con flangia / with flanges mit Flanges / avec flasques / con tapetas	<b>18L075</b>	<b>TL75018</b>	3F	F22	1108	28	54,57	53,81	60	-	25,0	25,0	-	0,2	
		<b>19L075</b>	<b>TL75019</b>	3F	F24	1108	28	57,61	56,84	64	-	25,0	25,0	-	0,3	
		<b>20L075</b>	<b>TL75020</b>	3F	F25	1108	28	60,64	59,88	66	-	25,0	25,0	-	0,3	
		<b>21L075</b>	<b>TL75021</b>	3F	F26	1108	28	63,67	62,91	70	-	25,0	25,0	-	0,4	
		<b>22L075</b>	<b>TL75022</b>	3F	F27	1108	28	66,70	65,94	75	-	25,0	25,0	-	0,4	
		<b>23L075</b>	<b>TL75023</b>	3F	F28	1108	28	69,73	68,97	79	-	25,0	25,0	-	0,4	
		<b>24L075</b>	<b>TL75024</b>	3F	F28	1108	28	72,77	72,00	79	-	25,0	25,0	-	0,5	
		<b>25L075</b>	<b>TL75025</b>	3F	F29	1108	28	75,80	75,04	83	-	25,0	25,0	-	0,6	
		<b>26L075</b>	<b>TL75026</b>	3F	F30	1108	28	78,83	78,07	87	-	25,0	25,0	-	0,6	
		<b>27L075</b>	<b>TL75027</b>	3F	F30	1108	28	81,86	81,10	87	-	25,0	25,0	-	0,7	
		<b>28L075</b>	<b>TL75028</b>	3F	F31	1108	28	84,89	84,13	91	-	25,0	25,0	-	0,7	
		<b>30L075</b>	<b>TL75030</b>	3F	F33	1108	28	90,96	90,20	97	-	25,0	25,0	-	0,9	
		<b>32L075</b>	<b>TL75032</b>	3F	F34	1108	28	97,02	96,26	102	-	25,0	25,0	-	1,0	
		<b>36L075</b>	<b>TL75036</b>	3F	F37	1610	42	109,15	108,39	115	-	25,0	25,0	-	1,2	
		<b>40L075</b>	<b>TL75040</b>	3F	F40	1610	42	121,28	120,51	128	-	25,0	25,0	-	1,7	
<b>44L075</b>	<b>TL75044</b>	3WF	F45	1610	42	133,40	132,64	142	90	110	25,0	25,0	-	2,1		
<b>48L075</b>	<b>TL75048</b>	3WF	F48	1610	42	145,53	144,77	150	92	120	25,0	25,0	-	2,5		
Ghisa / Cast iron Grauguss / Fonte Hierro fundido	senza flangia without flanges ohne Flanschen sans flasques sin tapetas	<b>60L075</b>	<b>TL75060</b>	3W		1610	42	181,91	181,15	-	92	166	25,0	25,0	-	3,0
		<b>72L075</b>	<b>TL75072</b>	3A		1610	42	218,30	217,53	-	92	202	25,0	25,0	-	4,0
		<b>84L075</b>	<b>TL75084</b>	7A		2012	50	254,68	253,90	-	92	236	25,0	32,0	-	5,2
		<b>96L075</b>	<b>TL75096</b>	7A		2012	50	291,06	290,30	-	106	270	25,0	32,0	3,5	6,5
		<b>120L075</b>	<b>TL75120</b>	7A		2012	50	363,83	363,07	-	106	343	25,0	32,0	3,5	7,6

**L 100 - 3/8" (9,525 mm)**

Caratteristiche Features Merkmale Características	Codice Code symbol Fabriknummer Code symbole Numero de fabrica	Nostro codice Our code Unser kode Notre code Nuestro codigito	Tipo Type Typ Type Tipo	Tipo flangia Flanges type Bordscheiben Typ Type flasques Tipo tapetas	Bussola Bush Buchse Moyeu Casquillo	Foro max. Max. Bore Max. Bohrung Alesage max. Agujero max.	Dp	De	Df	Dm	Di	F	S	R	Peso Weight / Gewicht Poids / Peso Kg	
Acciaio / Steel / Stahl Acier / Acero	con flangia / with flanges mit Flanges / avec flasques / con tapetas	<b>18L100</b>	<b>TL10018</b>	5F	F22	1108	28	54,57	53,81	60	-	38	31,0	22,0	9,0	0,2
		<b>19L100</b>	<b>TL10019</b>	5F	F24	1108	28	57,61	56,84	64	-	38	31,0	22,0	9,0	0,3
		<b>20L100</b>	<b>TL10020</b>	5F	F25	1108	28	60,64	59,88	66	-	45	31,0	22,0	9,0	0,4
		<b>21L100</b>	<b>TL10021</b>	5F	F26	1108	28	63,67	62,91	70	-	45	31,0	22,0	9,0	0,4
		<b>22L100</b>	<b>TL10022</b>	5F	F27	1108	28	66,70	65,94	75	-	48	31,0	22,0	9,0	0,4
		<b>23L100</b>	<b>TL10023</b>	5F	F28	1108	28	69,73	68,97	79	-	52	32,0	22,0	10,0	0,5
		<b>24L100</b>	<b>TL10024</b>	5F	F28	1108	28	72,77	72,00	79	-	52	32,0	22,0	10,0	0,6
		<b>25L100</b>	<b>TL10025</b>	5F	F29	1108	28	75,80	75,04	83	-	54	32,0	22,0	10,0	0,6
		<b>26L100</b>	<b>TL10026</b>	5F	F30	1108	28	78,83	78,07	87	-	60	32,0	22,0	10,0	0,7
		<b>27L100</b>	<b>TL10027</b>	5F	F30	1108	28	81,86	81,10	91	-	60	32,0	22,0	10,0	0,8
		<b>28L100</b>	<b>TL10028</b>	5F	F31	1108	28	84,89	84,13	91	-	65	32,0	22,0	10,0	0,8
		<b>30L100</b>	<b>TL10030</b>	5F	F33	1210	32	90,96	90,20	97	-	71	32,0	25,0	7,0	0,9
		<b>32L100</b>	<b>TL10032</b>	5F	F34	1210	32	97,02	96,26	102	-	75	32,0	25,0	7,0	1,0
		<b>36L100</b>	<b>TL10036</b>	5F	F37	1610	42	109,15	108,39	115	-	86	32,0	25,0	7,0	1,4
		<b>40L100</b>	<b>TL10040</b>	5F	F40	1610	42	121,28	120,51	128	-	96	32,0	25,0	7,0	1,7
<b>44L100</b>	<b>TL10044</b>	5WF	F45	1610	42	133,40	132,64	142	90	110	32,0	25,0	-	2,3		
<b>48L100</b>	<b>TL10048</b>	5WF	F48	1610	42	145,53	144,77	150	92	120	32,0	25,0	7,0	2,7		
Ghisa / Cast iron Grauguss / Fonte Hierro fundido	senza flangia without flanges ohne Flanschen sans flasques sin tapetas	<b>60L100</b>	<b>TL10060</b>	9W		1610	42	181,91	181,15	-	92	166	32,0	25,0	3,5	2,4
		<b>72L100</b>	<b>TL10072</b>	3A		2012	50	218,30	217,53	-	92	202	32,0	32,0	-	4,4
		<b>84L100</b>	<b>TL10084</b>	3A		2012	50	254,68	253,90	-	92	236	32,0	32,0	-	6,0
		<b>96L100</b>	<b>TL10096</b>	3A		2012	50	291,06	290,30	-	106	270	32,0	32,0	-	7,1
		<b>120L100</b>	<b>TL10120</b>	3A		2012	50	363,83	363,07	-	106	343	32,0	32,0	-	8,5



**Pulegge dentate per bussola conica / Timing belt pulleys for taper bushes**  
**Zahnriemenscheiben für Spannbüchsen / Poulies dentées à moyeu amovible**  
**Poleas dentadas para casquillos cónicos (taper)**



**H 100 - 1/2" (12,7 mm)**

Caratteristiche Features Merkmale Características	Codice Code symbol Fabriknummer Code symbole Numero de fabrica	Nostro codice Our code Unser kode Notre code Nuestro codiglo	Tipo Type Typ Type Tipo	Tipo flangia Flanges type Bordscheiben Typ Type flasques Tipo tapetas	Bussola Bush Buchse Moyeu Casquillo	Foro max. Max. Bore Max. Bohrung Alesage max. Agujero max.	Dp	De	Df	Dm	Di	F	S	R	Peso Weight / Gewicht Poids / Peso Kg	
Acciaio / Steel / Stahl Acier / Acero	con flangia / with flanges mit Flanges / avec flasques / con tapetas	<b>16H100</b>	<b>TH10016</b>	5F	F26	1108	28	64,68	63,31	70	-	45	31,0	22,0	9,0	0,4
		<b>18H100</b>	<b>TH10018</b>	5F	F28	1210	32	72,77	71,39	79	-	52	31,0	25,0	6,0	0,5
		<b>19H100</b>	<b>TH10019</b>	5F	F29	1210	32	76,81	75,44	83	-	56	31,0	25,0	6,0	0,6
		<b>20H100</b>	<b>TH10020</b>	5F	F30	1210	32	80,55	79,48	87	-	60	31,0	25,0	6,0	0,7
		<b>21H100</b>	<b>TH10021</b>	5F	F31	1210	32	84,89	83,52	91	-	64	32,0	25,0	7,0	0,8
		<b>22H100</b>	<b>TH10022</b>	5F	F32	1210	32	88,94	87,56	93	-	67	32,0	25,0	7,0	0,9
		<b>23H100</b>	<b>TH10023</b>	5F	F33	1610	42	92,98	91,61	97	-	70	32,0	25,0	7,0	0,9
		<b>24H100</b>	<b>TH10024</b>	5F	F34	1610	42	97,02	95,65	102	-	74	32,0	25,0	7,0	1,0
		<b>25H100</b>	<b>TH10025</b>	5F	F35	1610	42	101,06	99,69	106	-	77	32,0	25,0	7,0	1,0
		<b>26H100</b>	<b>TH10026</b>	5F	F36	1610	42	105,11	103,73	112	-	82	32,0	25,0	7,0	1,2
		<b>27H100</b>	<b>TH10027</b>	5F	F37	1610	42	109,15	107,78	115	-	85	32,0	25,0	7,0	1,3
		<b>28H100</b>	<b>TH10028</b>	5F	F38	1610	42	113,19	111,82	120	-	90	32,0	25,0	7,0	1,5
		<b>30H100</b>	<b>TH10030</b>	5F	F40	1610	42	121,28	119,90	128	-	98	32,0	25,0	7,0	1,7
		<b>32H100</b>	<b>TH10032</b>	5WF	F42	1610	42	129,36	127,99	135	80	106	32,0	25,0	7,0	2,0
		<b>36H100</b>	<b>TH10036</b>	5WF	F48	1610	42	145,53	144,16	150	92	121	32,0	25,0	7,0	2,7
		<b>40H100</b>	<b>TH10040</b>	5WF	F52	1610	42	161,70	160,33	168	92	138	32,0	25,0	7,0	3,6
<b>44H100</b>	<b>TH10044</b>	3WF	F55	2012	50	177,87	176,50	184	106	152	32,0	32,0	-	3,8		
<b>48H100</b>	<b>TH10048</b>	3WF	F59	2012	50	194,04	192,67	200	106	169	32,0	32,0	-	3,2		
Ghisa / Cast iron Grauguss / Fonte Hierro fundido	senza flangia without flanges ohne Flanschen sans flasques sin tapetas	<b>60H100</b>	<b>TH10060</b>	9A		2012	50	242,55	241,18	-	92	223	34,0	32,0	1,0	4,8
		<b>72H100</b>	<b>TH10072</b>	9A		2012	50	291,06	289,69	-	92	270	34,0	32,0	1,0	5,7
		<b>84H100</b>	<b>TH10084</b>	9A		2012	50	339,57	338,20	-	92	318	34,0	32,0	1,0	6,8
		<b>96H100</b>	<b>TH10096</b>	7A		2517	60	388,08	386,71	-	106	366	34,0	45,0	5,5	8,2
		<b>120H100</b>	<b>TH10120</b>	7A		2517	60	485,10	483,73	-	106	462	34,0	45,0	5,5	12,1

**H 150 - 1/2" (12,7 mm)**

Caratteristiche Features Merkmale Características	Codice Code symbol Fabriknummer Code symbole Numero de fabrica	Nostro codice Our code Unser kode Notre code Nuestro codiglo	Tipo Type Typ Type Tipo	Tipo flangia Flanges type Bordscheiben Typ Type flasques Tipo tapetas	Bussola Bush Buchse Moyeu Casquillo	Foro max. Max. Bore Max. Bohrung Alesage max. Agujero max.	Dp	De	Df	Dm	Di	F	S	R	Peso Weight / Gewicht Poids / Peso Kg	
Acciaio / Steel / Stahl Acier / Acero	con flangia / with flanges mit Flanges / avec flasques / con tapetas	<b>18H150</b>	<b>TH15018</b>	5F	F28	1210	32	72,77	71,39	79	-	52	45,0	25,0	20,0	0,6
		<b>19H150</b>	<b>TH15019</b>	5F	F29	1210	32	76,81	75,44	83	-	56	45,0	25,0	20,0	0,7
		<b>20H150</b>	<b>TH15020</b>	5F	F30	1210	32	80,55	79,48	87	-	60	45,0	25,0	20,0	0,8
		<b>21H150</b>	<b>TH15021</b>	5F	F31	1210	32	84,89	83,52	91	-	64	45,0	25,0	20,0	1,0
		<b>22H150</b>	<b>TH15022</b>	5F	F32	1210	32	88,94	87,56	93	-	67	45,0	25,0	20,0	1,2
		<b>23H150</b>	<b>TH15023</b>	5F	F33	1610	42	92,98	91,61	97	-	70	45,0	25,0	20,0	1,3
		<b>24H150</b>	<b>TH15024</b>	5F	F34	1610	42	97,02	95,65	102	-	74	45,0	25,0	20,0	1,0
		<b>25H150</b>	<b>TH15025</b>	5F	F35	1610	42	101,06	99,69	106	-	77	45,0	25,0	20,0	1,2
		<b>26H150</b>	<b>TH15026</b>	5F	F36	1610	42	105,11	103,73	112	-	82	45,0	25,0	20,0	1,4
		<b>27H150</b>	<b>TH15027</b>	5F	F37	1610	42	109,15	107,78	115	-	85	45,0	25,0	20,0	1,6
		<b>28H150</b>	<b>TH15028</b>	5F	F38	1610	42	113,19	111,82	120	-	90	45,0	25,0	20,0	1,8
		<b>30H150</b>	<b>TH15030</b>	5F	F40	1610	42	121,28	119,90	128	-	98	45,0	25,0	20,0	2,3
		<b>32H150</b>	<b>TH15032</b>	5WF	F42	1610	42	129,36	127,99	135	80	106	45,0	25,0	20,0	2,3
		<b>36H150</b>	<b>TH15036</b>	5WF	F48	1610	42	145,53	144,16	150	92	121	45,0	25,0	20,0	3,1
		<b>40H150</b>	<b>TH15040</b>	5WF	F52	1610	42	161,70	160,33	168	92	138	45,0	25,0	20,0	4,0
		<b>44H150</b>	<b>TH15044</b>	5WF	F55	2012	50	177,87	176,50	184	106	152	45,0	32,0	13,0	4,4
<b>48H150</b>	<b>TH15048</b>	5WF	F59	2012	50	194,04	192,67	200	106	169	45,0	32,0	13,0	4,8		
Ghisa / Cast iron Grauguss / Fonte Hierro fundido	senza flangia without flanges ohne Flanschen sans flasques sin tapetas	<b>60H150</b>	<b>TH15060</b>	9A		2012	50	242,55	241,18	-	92	223	46,0	32,0	7,5	5,4
		<b>72H150</b>	<b>TH15072</b>	9A		2012	50	291,06	289,69	-	92	270	46,0	32,0	7,5	6,5
		<b>84H150</b>	<b>TH15084</b>	9A		2012	50	339,57	338,20	-	92	318	46,0	32,0	7,5	8,4
		<b>96H150</b>	<b>TH15096</b>	9A		2517	60	388,08	386,71	-	106	366	46,0	45,0	0,5	11,0
		<b>120H150</b>	<b>TH73120</b>	9A		2517	60	485,10	483,73	-	106	462	46,0	45,0	0,5	14,8

### H 200 - 1/2" (12,7 mm)

Caratteristiche Features Merkmal Características	Codice Code symbol Fabriknummer Code symbole Numero de fabrica	Nostro codice Our code Unser kode Notre code Nuestro codiglo	Tipo Type Typ Type Tipo	Tipo flangia Flanges type Bordscheiben Typ Type flasques Tipo tapetas	Bussola Bush Buchse Moyeu Casquillo	Foro max. Max. Bore Max. Bohrung Alesage max. Agujero max.	Dp	De	Df	Dm	Di	F	S	R	Peso Weight / Gewicht Poids / Peso Kg	
Acciaio / Steel / Stahl Acier / Acero	con flangia / with flanges mit Flanges / avec flasques / con tapetas	<b>18H200</b>	<b>TH20018</b>	5F	F28	1210	32	72,77	71,39	79	-	52	58,0	25,0	33,0	0,8
		<b>19H200</b>	<b>TH20019</b>	5F	F29	1210	32	76,81	75,44	83	-	56	58,0	25,0	33,0	0,9
		<b>20H200</b>	<b>TH20020</b>	5F	F30	1610	42	80,55	79,48	87	-	60	58,0	25,0	33,0	1,0
		<b>21H200</b>	<b>TH20021</b>	5F	F31	1610	42	84,89	83,52	91	-	64	58,0	25,0	33,0	1,7
		<b>22H200</b>	<b>TH20022</b>	5F	F32	1610	42	88,94	87,56	93	-	67	58,0	25,0	33,0	1,5
		<b>23H200</b>	<b>TH20023</b>	5F	F33	1610	42	92,98	91,61	97	-	70	58,0	25,0	33,0	1,8
		<b>24H200</b>	<b>TH20024</b>	5F	F34	1610	42	97,02	95,65	102	-	74	58,0	25,0	33,0	1,5
		<b>25H200</b>	<b>TH20025</b>	5F	F35	1610	42	101,06	99,69	106	-	77	58,0	25,0	33,0	1,5
		<b>26H200</b>	<b>TH20026</b>	5F	F36	1610	42	105,11	103,73	112	-	82	58,0	25,0	33,0	1,8
		<b>27H200</b>	<b>TH20027</b>	5F	F37	1610	42	109,15	107,78	115	-	85	58,0	25,0	33,0	1,9
		<b>28H200</b>	<b>TH20028</b>	5F	F38	1610	42	113,19	111,82	120	-	90	58,0	25,0	33,0	1,9
		<b>30H200</b>	<b>TH20030</b>	5F	F40	1610	42	121,28	119,90	128	-	98	58,0	25,0	33,0	2,3
		<b>32H200</b>	<b>TH20032</b>	5F	F42	2012	50	129,36	127,99	135	-	106	58,0	32,0	26,0	3,0
		<b>36H200</b>	<b>TH20036</b>	5WF	F48	2012	50	145,53	144,16	150	102	121	58,0	32,0	26,0	3,0
		<b>40H200</b>	<b>TH20040</b>	5WF	F52	2012	50	161,70	160,33	168	106	140	58,0	32,0	26,0	3,6
<b>44H200</b>	<b>TH20044</b>	5WF	F55	2012	50	177,87	176,50	184	106	150	58,0	32,0	26,0	4,0		
<b>48H200</b>	<b>TH20048</b>	5WF	F59	2517	60	194,04	192,67	200	119	168	58,0	45,0	13,0	4,6		
Ghisa / Cast iron Grauguss / Fonte Hierro fundido	senza flangia without flanges ohne Flanschen sans flasques sin tapetas	<b>60H200</b>	<b>TH20060</b>	9A		2517	60	242,55	241,18	-	119	223	60,0	45,0	7,5	7,0
		<b>72H200</b>	<b>TH20072</b>	9A		2517	60	291,06	289,69	-	119	270	60,0	45,0	7,5	8,0
		<b>84H200</b>	<b>TH20084</b>	9A		2517	60	339,57	338,20	-	119	318	60,0	45,0	7,5	9,0
		<b>96H200</b>	<b>TH20096</b>	9A		2517	60	388,08	386,71	-	119	366	60,0	45,0	7,5	10,0
		<b>120H200</b>	<b>TH20120</b>	9A		2517	60	485,10	483,73	-	119	462	60,0	45,0	7,5	13,4

### H 300 - 1/2" (12,7 mm)

Caratteristiche Features Merkmal Características	Codice Code symbol Fabriknummer Code symbole Numero de fabrica	Nostro codice Our code Unser kode Notre code Nuestro codiglo	Tipo Type Typ Type Tipo	Tipo flangia Flanges type Bordscheiben Typ Type flasques Tipo tapetas	Bussola Bush Buchse Moyeu Casquillo	Foro max. Max. Bore Max. Bohrung Alesage max. Agujero max.	Dp	De	Df	Dm	Di	F	S	R	Peso Weight / Gewicht Poids / Peso Kg	
Acciaio / Steel / Stahl Acier / Acero	con flangia / with flanges mit Flanges / avec flasques / con tapetas	<b>20H300</b>	<b>TH30020</b>	4F	F31	1615	42	80,85	79,48	87	-	65	84,0	38,0	23,0	1,5
		<b>21H300</b>	<b>TH30021</b>	4F	F31	1615	42	84,89	83,52	91	-	65	84,0	38,0	23,0	1,2
		<b>22H300</b>	<b>TH30022</b>	4F	F32	1615	42	88,94	87,56	93	-	67	84,0	38,0	23,0	1,6
		<b>23H300</b>	<b>TH30023</b>	4F	F33	1615	42	92,98	91,61	97	-	70	84,0	38,0	23,0	1,8
		<b>24H300</b>	<b>TH30024</b>	4F	F34	1615	42	97,02	95,65	102	-	74	84,0	38,0	23,0	2,0
		<b>25H300</b>	<b>TH30025</b>	4F	F35	1615	42	101,06	99,69	106	-	77	84,0	38,0	23,0	2,0
		<b>26H300</b>	<b>TH30026</b>	4F	F36	1615	42	105,11	103,73	112	-	82	84,0	38,0	23,0	2,7
		<b>27H300</b>	<b>TH30027</b>	4F	F37	2012	50	109,15	107,78	115	-	85	84,0	32,0	26,0	3,0
		<b>28H300</b>	<b>TH30028</b>	4F	F38	2012	50	113,19	111,82	120	-	90	84,0	32,0	26,0	2,4
		<b>30H300</b>	<b>TH30030</b>	4F	F40	2012	50	121,28	119,90	128	-	98	84,0	32,0	26,0	2,9
		<b>32H300</b>	<b>TH30032</b>	4F	F42	2517	60	129,36	127,99	135	-	106	84,0	45,0	19,5	3,3
		<b>36H300</b>	<b>TH30036</b>	4F	F48	2517	60	145,53	144,16	150	-	121	84,0	45,0	19,5	4,5
		<b>40H300</b>	<b>TH30040</b>	4F	F52	2517	60	161,70	160,33	168	-	138	84,0	45,0	19,5	6,0
		<b>44H300</b>	<b>TH30044</b>	4WF	F55	2517	60	177,87	176,50	184	119	150	86,0	45,0	20,5	6,6
		<b>48H300</b>	<b>TH30048</b>	4WF	F59	2517	60	194,04	192,67	200	119	168	86,0	45,0	20,5	7,6
Ghisa / Cast iron Grauguss / Fonte Hierro fundido	senza flangia without flanges ohne Flanschen sans flasques sin tapetas	<b>60H300</b>	<b>TH30060</b>	9A		2517	60	242,55	241,18	-	119	223	86,0	45,0	20,5	8,4
		<b>72H300</b>	<b>TH30072</b>	9A		2517	60	291,06	289,69	-	119	270	86,0	45,0	20,5	10,4
		<b>84H300</b>	<b>TH30084</b>	9A		2517	60	339,57	338,20	-	119	318	86,0	45,0	20,5	12,5
		<b>96H300</b>	<b>TH30096</b>	9A		3030	75	388,08	386,71	-	150	366	86,0	76,0	5,0	14,2
		<b>120H300</b>	<b>TH30120</b>	9A		3030	75	485,10	483,73	-	150	462	86,0	76,0	5,0	18,8

**Pulegge dentate per bussola conica / Timing belt pulleys for taper bushes**  
**Zahnriemenscheiben für Spannbüchsen / Poulies dentées à moyeu amovible**  
**Poleas dentadas para casquillos cónicos (taper)**



**XH 200 - 7/8" (22,225 mm)**

Caratteristiche Features Merkmale Características Características	Codice Code symbol Fabriknummer Code symbole Numero de fabrica	Nostro codice Our code Unser kode Notre code Nuestro codigoo	Tipo Type Typ Type Tipo	Tipo flangia Flanges type Bordscheiben Typ Type flasques Tipo tapetas	Bussola Bush Buchse Moyeu Casquillo	Foro max. Max. Bore Max. Bohrung Alesage max. Agujero max.	Dp	De	Df	Dm	Di	F	S	R	Peso Weight / Gewicht Poids / Peso Kg
Ghisa / Cast iron Grauguss / Fonte Hierro fundido	con flangia / with flanges mit Flanges / avec flasques / con tapetas	<b>18XH200</b>	<b>TXH2018</b>	5F	F44	2517	60	127,34	124,55	140	-	95	64	45	19,0
		<b>20XH200</b>	<b>TXH2020</b>	5F	F49	2517	60	141,49	138,69	154	-	110	64	45	19,0
		<b>22XH200</b>	<b>TXH2022</b>	5F	F52	2517	60	155,64	152,84	168	-	120	64	45	19,0
		<b>24XH200</b>	<b>TXH2024</b>	5F	F55	2517	60	169,79	166,99	184	-	135	64	45	19,0
		<b>26XH200</b>	<b>TXH2026</b>	5F	F59	2517	60	183,94	181,14	200	-	150	64	45	19,0
		<b>28XH200</b>	<b>TXH2028</b>	4WF	F61	2517	60	198,08	195,29	212	120	165	64	45	9,5
		<b>30XH200</b>	<b>TXH2030</b>	4WF	F62	2517	60	212,23	209,44	226	120	180	64	45	9,5
		<b>32XH200</b>	<b>TXH2032</b>	4WF	F64	2517	60	226,38	223,59	240	120	195	64	45	9,5
		<b>40XH200</b>	<b>TXH2040</b>	4WF	F70	3020	75	282,98	280,18	296	160	245	64	51	9,5
	senza flangia / without flanges ohne Flanschen / sans flasques sin tapetas	<b>48XH200</b>	<b>TXH2048</b>	9W		3020	75	339,57	336,78	-	160	300	64	51	6,5
		<b>60XH200</b>	<b>TXH2060</b>	7A		3535	90	424,47	421,67	-	190	385	64	89	12,5
		<b>72XH200</b>	<b>TXH2072</b>	7A		3535	90	509,40	506,56	-	190	470	64	89	12,5
		<b>84XH200</b>	<b>TXH2084</b>	7A		3535	90	594,25	591,46	-	190	555	64	89	12,5
		<b>96XH200</b>	<b>TXH2096</b>	7A		3535	90	679,15	676,35	-	190	640	64	89	12,5
		<b>120XH200</b>	<b>TXH2120</b>	7A		3535	90	848,93	846,14	-	190	810	64	89	12,5

**XH 300 - 7/8" (22,225 mm)**

Caratteristiche Features Merkmale Características Características	Codice Code symbol Fabriknummer Code symbole Numero de fabrica	Nostro codice Our code Unser kode Notre code Nuestro codigoo	Tipo Type Typ Type Tipo	Tipo flangia Flanges type Bordscheiben Typ Type flasques Tipo tapetas	Bussola Bush Buchse Moyeu Casquillo	Foro max. Max. Bore Max. Bohrung Alesage max. Agujero max.	Dp	De	Df	Dm	Di	F	S	R	Peso Weight / Gewicht Poids / Peso Kg
Ghisa / Cast iron Grauguss / Fonte Hierro fundido	con flangia / with flanges mit Flanges / avec flasques / con tapetas	<b>18XH300</b>	<b>TXH3018</b>	5F	F44	2517	60	127,34	124,55	140	-	95	90	45	45,0
		<b>20XH300</b>	<b>TXH3020</b>	5F	F49	2517	60	141,49	138,69	154	-	110	90	45	45,0
		<b>22XH300</b>	<b>TXH3022</b>	5F	F52	2517	60	155,64	152,84	168	-	120	90	45	45,0
		<b>24XH300</b>	<b>TXH3024</b>	5F	F55	2517	60	169,79	166,99	184	-	135	90	45	45,0
		<b>26XH300</b>	<b>TXH3026</b>	5F	F59	2517	60	183,94	181,14	200	-	150	90	45	45,0
		<b>28XH300</b>	<b>TXH3028</b>	5F	F61	3020	75	198,08	195,29	212	120	165	90	51	39,0
		<b>30XH300</b>	<b>TXH3030</b>	5F	F62	3020	75	212,23	209,44	226	120	180	90	51	39,0
		<b>32XH300</b>	<b>TXH3032</b>	5F	F64	3020	75	226,38	223,59	240	120	195	90	51	39,0
		<b>40XH300</b>	<b>TXH3040</b>	4WF	F70	3020	75	282,98	280,18	296	160	245	90	51	19,5
	senza flangia / without flanges ohne Flanschen / sans flasques sin tapetas	<b>48XH300</b>	<b>TXH3048</b>	9A		3020	75	339,57	336,78	-	160	300	90	51	19,5
		<b>60XH300</b>	<b>TXH3060</b>	9A		3535	90	424,47	421,67	-	190	385	90	89	0,5
		<b>72XH300</b>	<b>TXH3072</b>	9A		3535	90	509,40	506,56	-	190	470	90	89	0,5
		<b>84XH300</b>	<b>TXH3084</b>	7A		4040	100	594,25	591,46	-	190	555	90	102	6,0
		<b>96XH300</b>	<b>TXH3096</b>	7A		4040	100	679,15	676,35	-	190	640	90	102	6,0
		<b>120XH300</b>	<b>TXH3120</b>	7A		4040	100	848,93	846,14	-	190	810	90	102	6,0

**XH 400 - 7/8" (22,225 mm)**

Caratteristiche Features Merkmale Características	Codice Code symbol Fabriknummer Code symbole Numero de fabrica	Nostro codice Our code Unser kode Notre code Nuestro codigo	Tipo Type Typ Type Tipo	Tipo flangia Flanges type Bordscheiben Typ Type flasques Tipo tapetas	Bussola Bush Buchse Moyeu Casquillo	Foro max. Max. Bore Max. Bohrung Alesage max. Agujero max.	Dp	De	Df	Dm	Di	F	S	R	Peso Weight / Gewicht Poids / Peso Kg
Ghisa / Cast iron Grauguss / Fonte Hierro fundido	con flangia / with flanges mit Flanges / avec flasques / con tapetas	<b>18XH400</b>	<b>TXH4018</b>	5F	F44	2517	60	127,34	124,55	140	-	95	119	45	74,0
		<b>20XH400</b>	<b>TXH4020</b>	5F	F49	2517	60	141,49	138,69	154	-	110	119	45	74,0
		<b>22XH400</b>	<b>TXH4022</b>	5F	F52	2517	60	155,64	152,84	168	-	120	119	45	74,0
		<b>24XH400</b>	<b>TXH4024</b>	5F	F55	3020	75	169,79	166,99	184	-	135	119	51	68,0
		<b>26XH400</b>	<b>TXH4026</b>	5F	F59	3020	75	183,94	181,14	200	-	150	119	51	68,0
		<b>28XH400</b>	<b>TXH4028</b>	5F	F61	3020	75	198,08	195,29	212	120	165	119	51	68,0
		<b>30XH400</b>	<b>TXH4030</b>	5F	F62	3020	75	212,23	209,44	226	120	180	119	51	68,0
		<b>32XH400</b>	<b>TXH4032</b>	5F	F64	3020	75	226,38	223,59	240	120	195	119	51	68,0
		<b>40XH400</b>	<b>TXH4040</b>	4WF	F70	3535	90	282,98	280,18	296	160	245	119	89	15,0
	senza flangia / without flanges ohne Flanschen / sans flasques sin tapetas	<b>48XH400</b>	<b>TXH4048</b>	9W		3535	90	339,57	336,78	-	160	300	119	89	15,0
		<b>60XH400</b>	<b>TXH4060</b>	9A		4040	100	424,47	421,67	-	190	385	119	102	8,5
		<b>72XH400</b>	<b>TXH4072</b>	9A		4040	100	509,40	506,56	-	190	470	119	102	8,5
		<b>84XH400</b>	<b>TXH4084</b>	9A		4040	100	594,25	591,46	-	190	555	119	102	8,5
		<b>96XH400</b>	<b>TXH4096</b>	9A		4040	100	679,15	676,35	-	190	640	119	102	8,5
		<b>120XH400</b>	<b>TXH4120</b>	9A		4040	100	848,93	846,14	-	190	810	119	102	8,5